

Assembly and Operating Instructions

HOLLAND® Fifth Wheel Rebuild Stand

TF-04229-1 Fifth Wheel Rebuild Stand

Assembly and Operating Procedures

Assembly Instructions

1. Assemble the cross straps by installing the center 3/8" -16 x 1" hex head cap screw and the 3/8" -16 locknut. Tighten, but allow free movement.
2. Attach the cross straps to the left or right stand leg by installing two (2) 3/8" -16 x 1" hex head cap screws and 3/8" -16 locknuts.
3. Attach the cross straps to the other stand leg by following the instructions in step 2 above.
4. Attach the cross shafts by installing the 3/4" -10 x 1-3/4" hex head cap screws.
5. Tighten the fasteners securely.
6. Attach the locking pin and chain assemblies to the stand legs by installing the self tapping screws through the chain and into each stand leg.
7. Install the 3/8" -16 x 2" hex head cap screws into the handles.

Figure 1

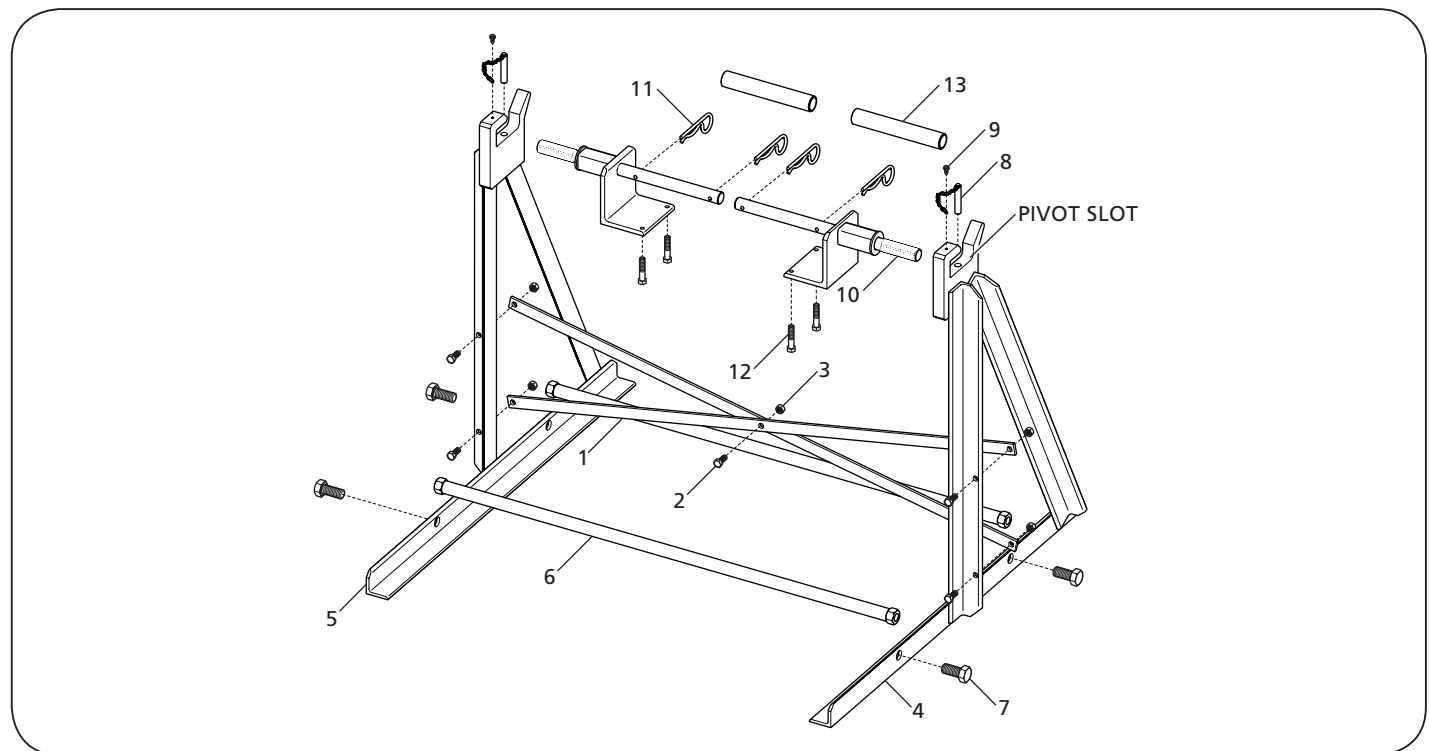

ITEM	DESCRIPTION	PART NO.	QTY.
1	Cross Strap	XA-04869	2
2	HHCS, 3/8" -16 x 1"	XB-C-38-C-1	5
3	Locknut, 3/8" -16	XB-338	5
4	Right Stand Leg	XA-04858	1
5	Left Stand Leg	XA-04859	1
6	Cross Shaft	XA-04871	2
7	HHCS, 3/4" -10 x 1-3/4"	XB-04693	4

ITEM	DESCRIPTION	PART NO.	QTY.
8	Locking Pin and Chain	XA-04829	2
9	Self-Tapping Screw	XB-MSR-316-C-500	2
10	Handle	XA-04860	2
11	Clinch Pin	XB-04897	4
12	HHCS, 3/8" -16 x 2"	XB-C-375-C-200	4
13	Handle Sleeve	XA-04957	2

Operating Instructions

1. Make certain that the stand is assembled properly. Refer to Assembly Instructions.
2. Remove both locking pins from the mounting holes in the stand pivot slots (**Figure 1**).
3. Remove clinch pins from the handles.
4. Slide the handles through the fifth wheel pivot ears with the leg of the angle facing the top plate surface (**Figure 2**).

NOTE: When rebuilding the XA-71 series top plate, it will be necessary to install the handle sleeves onto the handle assemblies before inserting into the top plate pivot ears.

5. Secure the handles using the clinch pins.
6. Tighten the 3/8" -16 x 2" hex head cap screws finger tight, removing the free play between the handles and top plate (**Figure 2, inset**).

7. Using a device capable of lifting 500 lbs. (227 kg), mount the top plate in the stand using the handles to guide it into position.

NOTE: Follow instructions published by lifting device manufacturer for proper operation of lifting device.

CAUTION If the top plate is to be moved manually, exercise all precautions involved in lifting and moving heavy objects.

8. Align the top plate either face up or face down on the stand and slide the handles under the pivot slots in the stand.
9. Secure both sides by inserting the locking pins into the hole provided in each pivot slot.
10. Begin the rebuild process as outlined in the literature provided in the associated rebuild kit.
11. The fifth wheel function and adjustment after rebuilding can be checked on the stand by using a HOLLAND® Lock Tester (NOT included).
12. Remove the top plate from the stand by reversing steps 3 through 7 above.

Figure 2

