

Optimised double-sided lift system for INTRA air suspension units

As part of ongoing technical further development, SAF is now offering an optimised version of the double-sided axle lift systems for INTRA air suspension units. The crucial benefit of the new axle lift system is that it can be used for all standard INTRA air suspension units with rigid axles and air springs SAF2619V, 2918V, 2923V, 2923VK and 2924V.

Use on self-steering trailing axles is not permitted.

Lift-Kit-TO DATE

3 027 1242 00
for steel hanger brackets
3 027 1243 00
for cross members
3 027 1244 00
for aluminium hanger brackets

Illustration for steel hanger bracket

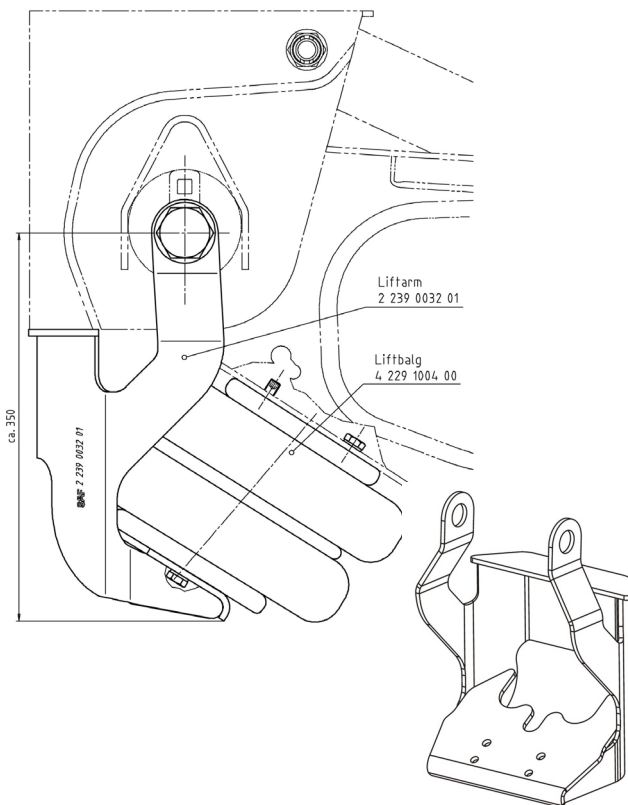

Lift-Kit-NEW

3 027 1242 01
for steel hanger brackets
3 027 1243 01
for cross members
3 027 1244 01
for aluminium hanger brackets

Illustration for steel hanger bracket

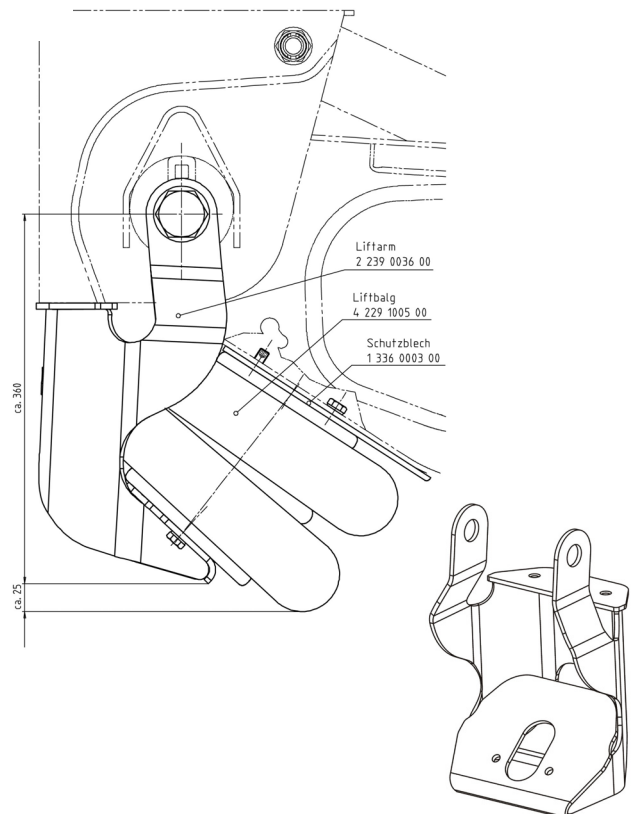

The optimised double-sided axle lift system replaces the old double-sided axle lift also in all spare parts orders.

Use of the old lift system on one side of the axle and the new lift system on the other side of the axle is permissible.

Not permissible is a combination of the new air bellow with the old lift arms or a combination of the old air bellow with the new lift arms. Use of the new air bellow is only permissible in conjunction with the new lift arms.

Rückfragen an / any enquiries to:

Name: Helmut Hock
Tel / phone: +49 6095 301 168
E-mail: helmut.hock@saf-achsen.de

Datum: 03.08.2004