

ORDERING GUIDE - AFTERMARKET

USA

SAF-HOLLAND, Inc.

800.876.3929

CANADA

SAF-HOLLAND, Canada Ltd.

519-537-2366



CBX23, CBX25, CBX25/30, CBX23u, CBX25u SERIES FIXED FRAME SUSPENSIONS WITH DRUM OR DISC BRAKE AXLE

Ordering Guide Information: **PLEASE DOWNLOAD THIS FORM BEFORE COMPLETING.**

This form is designed to collect all necessary information about the suspension application requirements to help determine the appropriate Fixed Frame Suspension Series configuration for the trailer build.

For application and selection information, please reference our [Trailer Air Suspension Application Guide \(XL-AS11415SG-en-US\)](#).

If you have any questions regarding this document, please feel free to contact SAF-HOLLAND Customer Service at 1.800-876-3929

- Please complete all of the information requested on this ordering guide by filling in all appropriate fields.
- After submitting, print a copy of this ordering guide for your records, by clicking the "PRINT FORM" button.
- To clear the form, click the "CLEAR FORM" button..

How-To Submit This Ordering Guide:

Submit completed ordering guide by clicking the "EMAIL" button next one of our SAF-HOLLAND ordering specialist.

SUBMIT FORM TO:

USA

Debbie Doremire

CANADA

Jim Visser

Matt Tubbe

GENERAL INFORMATION

CUSTOMER INFORMATION

| | | |
|-----------------|--|-----------------------|
| Date: | Estimated Trailers for this Specification: | |
| Company Name: | Contact Name: | |
| Street Address: | | |
| City: | State/Province: | Zip Code/Postal Code: |
| Telephone: | Fax: | E-Mail: |

END USER INFORMATION

| | | |
|-----------------|-----------------|-----------------------|
| Company Name: | Contact Name: | |
| Street Address: | | |
| City: | State/Province: | Zip Code/Postal Code: |
| Telephone: | Fax: | E-Mail: |

DRUM BRAKE AXLE CONFIGURATION (Complete Drum or Disc Brake Section as Required)

FIXED PORTION OF CONFIGURATION

| |
|---|
| Drum Brake |
| Brake Shoe/Lining: SAF Standard Extended Life Linings |
| Tire Inflation System: 3-Hole, Drilled and Tapped with Freeze Plugs |
| S-Cam: 28 Spline Standard, Medium Length |

OPTIONAL PORTION OF CONFIGURATION

| | |
|--------------|---|
| Axle Rating: | 23,000 - CBX23, CBX23u |
| | 25,000 - CBX25, CBX25u |
| | 30,000 - CBX25/30* |
| | * The CBX25/30 is rated for 30,000 lbs. of load carrying at creep speed. Creep speed is defined as 5 mph or less. |

| | | |
|--|------------|-------------------|
| Spindle: | Tapered | Parallel |
| Camber: | Yes | No |
| Dual/Wide Base Single: | Dual | Wide Base Single* |
| *Note: 2" offset not approved for tapered axles. (See XL-AA20005WI-en-US for axle derating.) | | |
| Brake Size: | 16.5" x 7" | 16.5" x 8 5/8" |
| Axle Track / Beam Centers: | 71.5"/36" | 77.5"/42" |

OPTIONS SOLD SEPARATELY

Cam Enclosures: Order Part No. 51830030, Quantity 1 per axle (Cam Enclosure Retrofit Kit - Medium Cam)

ORDERING GUIDE - AFTERMARKET



CBX23, CBX25, CBX25/30, CBX23u, CBX25u SERIES FIXED FRAME SUSPENSIONS WITH DRUM OR DISC BRAKE AXLE

DRUM BRAKE WHEEL END CONFIGURATION

Wheel Ends Required: Yes No If no, skip section and continue to Suspension Configuration.

FIXED PORTION OF CONFIGURATION

Hub Material: Ductile Iron

Autom. Slack Adjuster: Standard 5.5"

Spindle Nut: ZipTorq®

Drum Material: Cast

Bearing: Standard

Wheel Fasteners: 2 Ship Nuts

Hubcap Type: Standard Bolt-On

Brake Chamber: Standard 30/30, 2.5" Stroke

Hub Style: Hub Piloted

Seal: Standard Spindle Mount

Stud Length: Long

OPTIONAL PORTION OF CONFIGURATION

Lube Type: SAE 80/90 Oil Semi-Fluid Grease

OPTIONS SOLD SEPARATELY

ABS Sensor (400 mm Lead Length):

Order Part No. 102230000020 (2 Needed Per Axle)
(Specify Quantity Required)

Wheel Fasteners: (Flange Nut, M22 x 1.5)

Order Part No. 04247301201 (20 Needed Per Axle)
(Specify Quantity Required)

Dust Shields (Dust Shield Kit):

Order Part No. 03005023500Z (2 Needed Per Axle)
(Specify Quantity Required)

DISC BRAKE AXLE CONFIGURATION - & (Complete Disc Brake or Drum Brake Section as Required)

FIXED PORTION OF CONFIGURATION

Disc Brake - 22.5"

Tire Inflation System: 3-Hole, Drilled and Tapped with Freeze Plugs

ABS Sensor: (400 mm Lead Length) Installed on all axles.

Note: All disc brake axles come with wheel end components.

OPTIONAL PORTION OF CONFIGURATION

Axle Rating: 23,000 - CBX23, CBX23u

25,000 - CBX25, CBX25u

30,000 - CBX25/30*

* The CBX25/30 is rated for 30,000 lbs. of load carrying at creep speed. Creep speed is defined as 5 mph or less.

Dual/Wide Base Single: Dual Wide Base Single

Camber: Yes No

Axle Track / Beam Centers: 71.5"/36" 77.5"/42"

OPTIONAL PORTION OF CONFIGURATION

New P89 - 5 Year Warranty

Options: Spindle: Tapered Parallel

Lube Type: SAE 80/90 Oil Semi-Fluid Grease

P89 Plus - 7 Year Warranty

Only available with SAF compact bearing and parallel spindle.

OPTIONS SOLD SEPARATELY

Wheel Fasteners: (Flange Nut, M22 x 1.5)

Order Part No. 04247301201 (20 Needed Per Axle)
(Specify Quantity Required)

Dust Shields (Dust Shield Kit):

Order Part No. 102230000040 (2 Needed Per Axle)
(Specify Quantity Required)

ORDERING GUIDE - AFTERMARKET

CBX23, CBX25, CBX25/30, CBX23u, CBX25u SERIES FIXED FRAME SUSPENSIONS WITH DRUM OR DISC BRAKE AXLE

SUSPENSION CONFIGURATION

OPTIONAL PORTION OF CONFIGURATION

| | | | | |
|--------------|---------------------|-----|-----|-----|
| Ride Height: | CBX23: | | | |
| | 14" | 15" | 16" | 17" |
| | CBX25 and CBX25/30: | | | |
| | 14" | 15" | 16" | 17" |
| | 18" | 19" | | |
| | CBX23u and CBX25u: | | | |
| | 6" | 7" | 8" | 9" |
| | 10" | 12" | | |

Frame Mounting: CBX23 and CBX25:

- Weld On*
- I-Beam Bolt On
- C-Channel Bolt On*
- Weld On with Wing (only for CBX25 18" and 19")

CBX25/30:

- Weld On with Wing
- I-Beam Bolt On

CBX23u and CBX25u:

- Weld On

* Not available for 18" or 19" ride height.

OPTIONAL PORTION OF CONFIGURATION

Shock Straps: (2 Needed Per Axle. Depending on frame mounting and ride height, shock and shock strap may change. See notes at bottom.)

| Model | Ride Height | Shock PN | Shock Strap PN | Qty |
|----------|-------------|----------|----------------|-----|
| CBX23 | 14 | 90045381 | 90549930 | |
| CBX23 | 15 | 90045608 | 90549932 | |
| CBX23 | 16 | 90045299 | 90549929 | |
| CBX23 | 17 | 90045299 | 90549929 | |
| CBX23u | 6 | 90044868 | 90549925 | |
| CBX23u | 7 | 90044868 | 90549925 | |
| CBX23u | 8 | 90045608 | 90549932 | |
| CBX23u | 9 | 90044162 | 90549920 | |
| CBX23u | 10 | 90045040 | 90549926 | |
| CBX23u | 12 | 90045666 | 90549934 | |
| CBX25 | 14 | 90045381 | 90549930 | |
| CBX25 | 15 | 90045608 | 90549932 | |
| CBX25 | 16 | 90044162 | 90549920 | |
| CBX25* | 16 | 90045299 | 90549929 | |
| CBX25 | 17 | 90045299 | 90549929 | |
| CBX25*** | 18 | 90045299 | 90549929 | |
| CBX25** | 18 | 90045381 | 90549930 | |
| CBX25*** | 19 | 90045053 | 90550221 | |

REFERENCES IMAGES

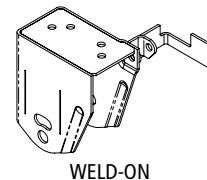
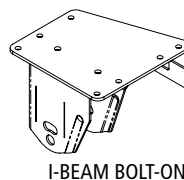
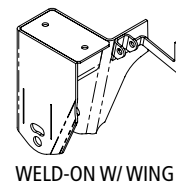
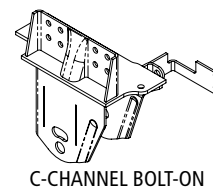
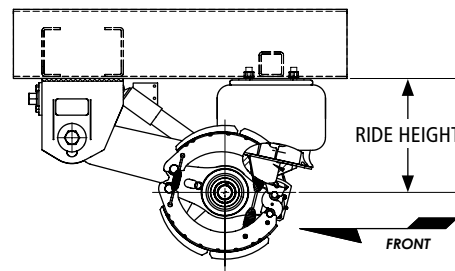

| Model | Ride Height | Shock PN | Shock Strap PN | Qty |
|-------------|-------------|----------|----------------|-----|
| CBX25** | 19 | 90045666 | 90549934 | |
| CBX25u | 6 | 90044868 | 90549925 | |
| CBX25u | 7 | 90044868 | 90549925 | |
| CBX25u | 8 | 90045381 | 90549930 | |
| CBX25u | 9 | 90045608 | 90549932 | |
| CBX25u | 10 | 90044162 | 90549920 | |
| CBX25u | 12 | 90045040 | 90549926 | |
| CBX25/30 | 14 | 90044868 | 90549925 | |
| CBX25/30*** | 15 | 90045381 | 90549930 | |
| CBX25/30** | 15 | 90045607 | 90549931 | |
| CBX25/30*** | 16 | 90045298 | 90549928 | |
| CBX25/30** | 16 | 90044162 | 90549920 | |
| CBX25/30*** | 17 | 90045298 | 90549928 | |
| CBX25/30** | 17 | 90044162 | 90549920 | |
| CBX25/30 | 18 | 90045040 | 90549926 | |
| CBX25/30 | 19 | 90045053 | 90550221 | |

NOTES: * Weld-On
** Weld-On w/ Wing
*** Bolt-On I-Beam

ORDERING GUIDE - AFTERMARKET

CBX23, CBX25, CBX25/30, CBX23u, CBX25u SERIES
 FIXED FRAME SUSPENSIONS WITH DRUM OR DISC BRAKE AXLE

DIMENSIONAL VIEWS

CBX25U (with parallel spindle drum brakes shown)
 All Dimensions Are Reference

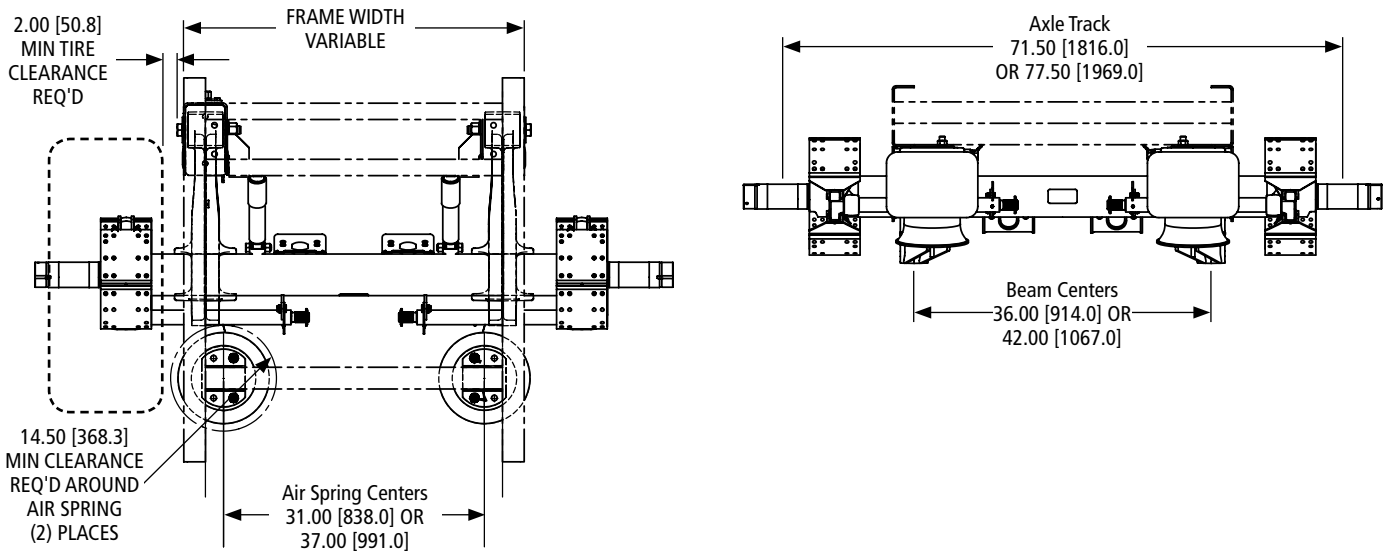

REFERENCE IMAGES

CBX TOP MOUNT

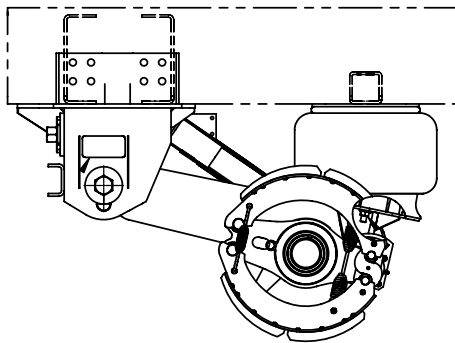

CBXu UNDERSLUNG

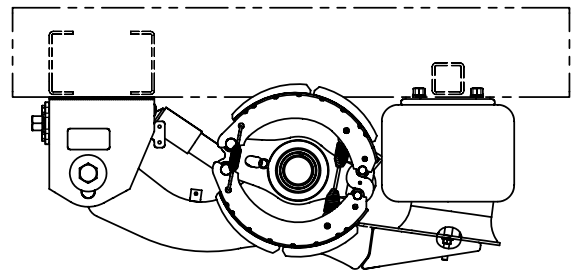

SAF P89 DISC BRAKE - **P39** OR **P39 PLUS**

