



COUPLER PRODUCTS

LATCH REPLACEMENT PROCEDURES

(PH-T-60-AOL-8 shown)



RK-62-0

For PH-T-60-AOL-8 and PH-T-60-AOS-1L-8

1. Remove and discard the nut, pivot bolt, chain assembly, and latch assembly.

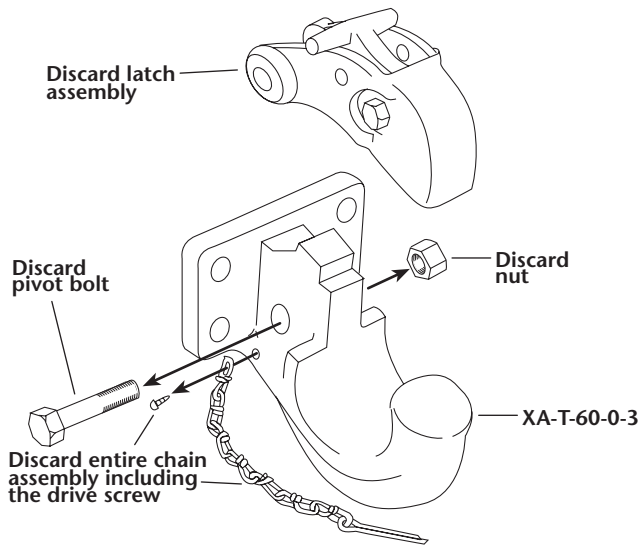

2. Apply Never-Seez® to entire shaft of the new pivot bolt (not on threads).

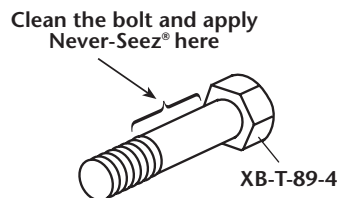

3. Install the new latch assembly using a new pivot bolt, chain assembly, and pivot nut. Torque the nut to 30-75 ft-lbs.

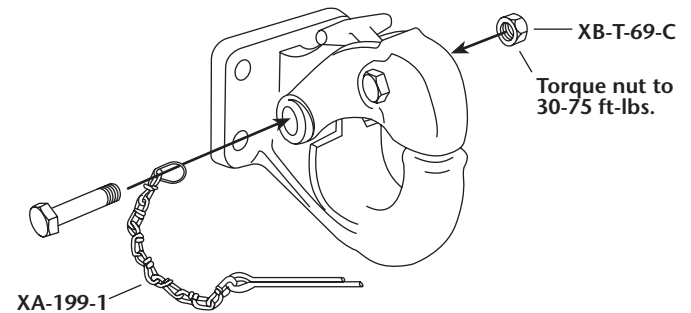

4. Check the latch for proper operation. When closed, the lock must be fully down. Install the cotter pin into the hole in the side of the latch, as shown. Spread the cotter pin to secure it in the latch.

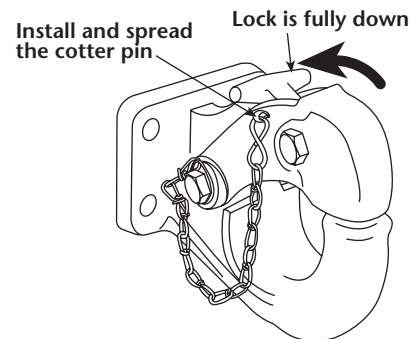

Copyright © April 2002 • The Holland Group, Inc.

Holland USA, Inc. Facilities:

Denmark, SC Muskegon, MI
 Dumas, AR Warrenton, MO
 Holland, MI Whitehouse Station, NJ
 Milpitas, CA Wylie, TX

Ph: 888-396-6501 Fax: 800-356-3929

Holland International, Inc.

Holland, MI
 Phone: 616-396-6501
 Fax: 616-396-1511

Holland Hitch of Canada, Ltd.

Woodstock, Ontario • Canada
 Phone: 519-537-3494
 Fax: 800-565-7753

Holland Equipment, Ltd.

Norwich, Ontario • Canada
 Phone: 519-863-3414
 Fax: 519-863-2398

Holland Hitch Western, Ltd.

Surrey, British Columbia • Canada
 Phone: 604-574-7491
 Fax: 604-574-0244