

## LSZ13 SUSPENSION

### ORIGINAL PARTS CATALOG



## NEWAY® LSZ13 Series Suspension

|  |         |
|--|---------|
| Contents Page.....                                       | 2       |
| Model Identification.....                                | 3       |
| Exploded View .....                                      | 4       |
| Parts List.....  | 5       |
| Brake – Exploded View .....                              | 6       |
| Brake – Parts List .....                                 | 7       |
| Kits .....   | 8 - 12  |
| Dimensions .....   | 13      |
| Air Kit, In-Cab Mount .....                              | 14      |
| Air Kit, In-Cab Mount Installation & Schematic Views ... | 15 - 16 |
| Ordering Code.....                                       | 17      |

## Original Parts

To ensure optimal performance of Neway Truck Suspensions and to prevent voiding any warranty coverage; we highly recommend the use of only SAF-HOLLAND Original Parts.

## Technical Support

Updates to this manual will be published as necessary online.

## Warranty

Refer to the complete warranty for the country and product in which the parts will be used. A copy of the written warranty is included with the product and can be found on the SAF-HOLLAND web site. [www.safholland.us](http://www.safholland.us)

A serial tag is attached to the front face of the roadside frame bracket (**Figure 1**). The tag supplies valuable information regarding the exact components used to manufacture the suspension (**Figure 2**). In order to properly identify the NEWAY® suspension and its components when communicating with SAF-HOLLAND®, please record the specific model, serial number, and in-service date and refer to them when ordering replacement parts.

Figure 1

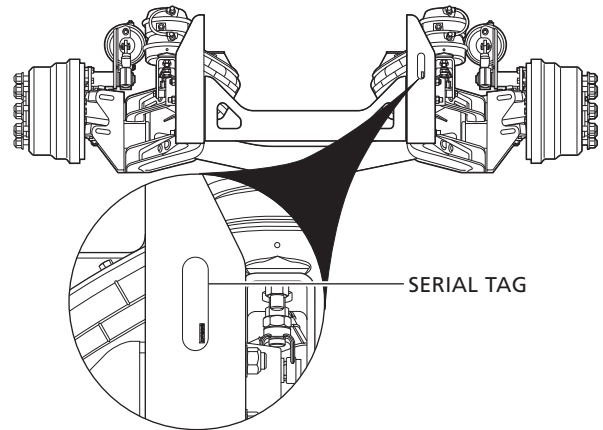
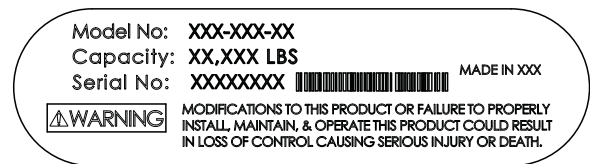
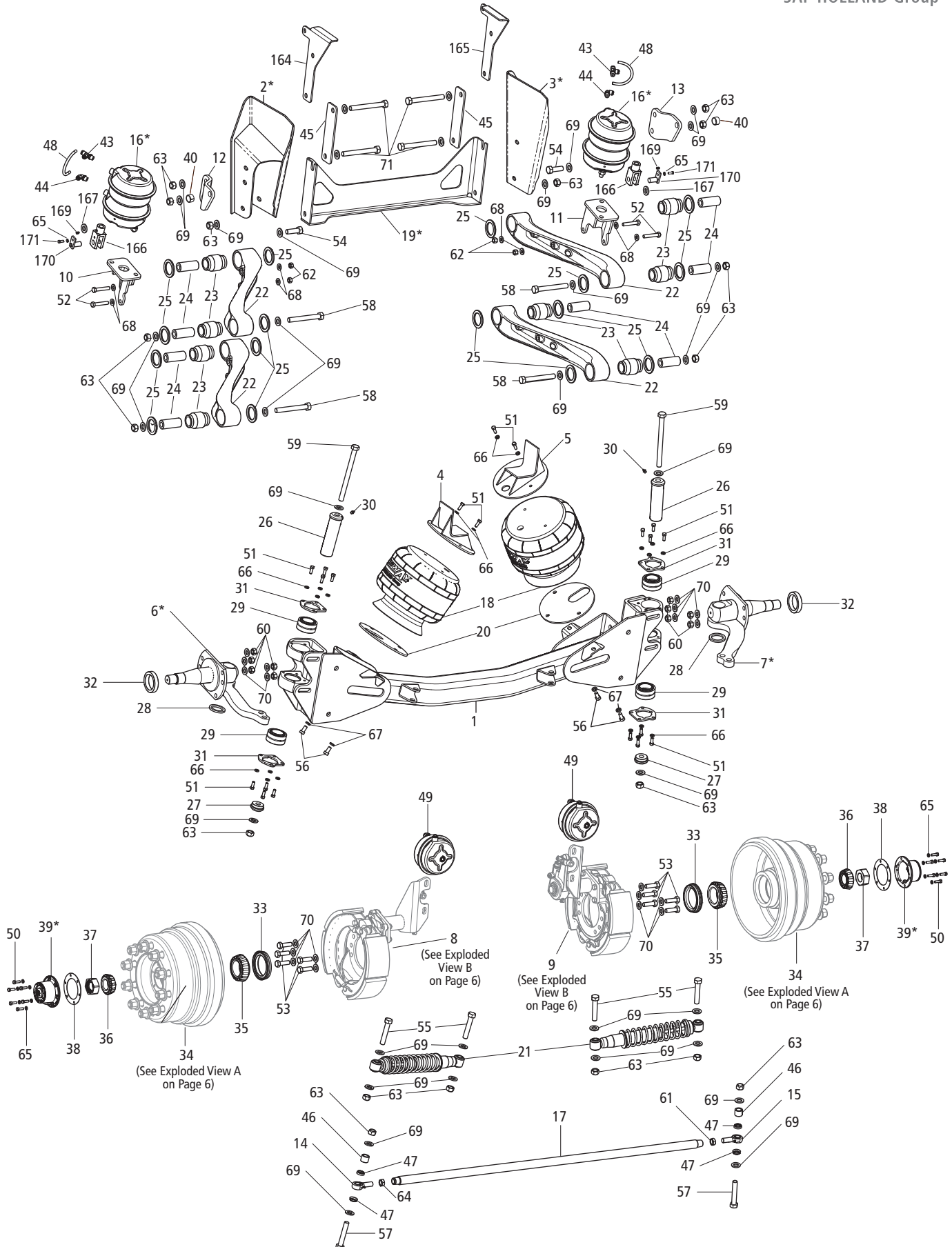

Figure 2



# LSZ13 Exploded View



| LSZ13 PARTS LIST |  |          |      |                 |
|------------------|--|----------|------|-----------------|
| ITEM NO.         | DESCRIPTION  | PART NO. | QTY. | WEIGHT LBS [KG] |
| 1                | Axle/Knuckle Weldment  | 90549813 | 1    | 196.00 [88.90]  |
| 2*               | Frame Bracket Assy., LH, 8-1/2" - 11-1/2" Ride HGHT - Paint            | 90522440 | 1    | 25.30 [11.48]   |
|                  | Frame Bracket Assy., LH, 11-1/2" - 14-1/2" Ride HGT - Paint            | 90522444 | 1    | 28.60 [12.97]   |
|                  | Frame Bracket Assy., LH, 8-1/2" - 11-1/2" Ride HGHT, Pre-punched       | 90522823 | 1    | 25.10 [11.39]   |
|                  | Frame Bracket Assy., LH, 11-1/2" - 14-1/2" Ride HGT, LH, Pre-punched   | 90522819 | 1    | 28.40 [12.88]   |
| 3*               | Frame Bracket Assy., RH, 8-1/2" - 11-1/2" Ride HGHT - Paint            | 90522442 | 1    | 25.30 [11.48]   |
|                  | Frame Bracket Assy., RH, 11-1/2" - 14-1/2" Ride HGT - Paint            | 90522446 | 1    | 28.60 [12.97]   |
|                  | Frame Bracket Assy., RH, 8-1/2" - 11-1/2" Ride HGHT, Pre-punched       | 90522825 | 1    | 25.10 [11.39]   |
|                  | Frame Bracket Assy., RH, 11-1/2" - 14-1/2" Ride HGT, Pre-punched       | 90522822 | 1    | 28.40 [12.88]   |
| 4                | Bracket, Air Spring Mount, LH, 8-1/2" - 11-1/2" Ride HGT               | 90531399 | 1    | 8.08 [3.67]     |
|                  | Bracket, Air Spring Mount, LH, 11-1/2" - 14-1/2" Ride HGT              | 90531403 | 1    | 9.83 [4.46]     |
|                  | Bracket, Upper Air Spring, LH, 8-1/2" - 11-1/2" Ride HGHT, Pre-punched | 90531411 | 1    | 8.00 [3.63]     |
|                  | Bracket, Upper Air Spring, LH, 11-1/2" - 14-1/2" Ride HGT, Pre-punched | 90531407 | 1    | 9.73 [4.41]     |
| 5                | Bracket, Air Spring Mount, RH, 8-1/2" - 11-1/2" Ride HGT               | 90531400 | 1    | 8.08 [3.67]     |
|                  | Bracket, Air Spring Mount, RH, 11-1/2" - 14-1/2" Ride HGT              | 90531404 | 1    | 9.83 [4.46]     |
|                  | Bracket, Upper Air Spring, RH, 8-1/2" - 11-1/2" Ride HGHT, Pre-punched | 90531412 | 1    | 8.00 [3.63]     |
|                  | Bracket, Upper Air Spring, RH, 11-1/2" - 14-1/2" Ride HGT, Pre-punched | 90531408 | 1    | 9.73 [4.41]     |
| 6*               | Spindle Assy - LH  | 90549820 | 1    | 32.70 [14.83]   |
| 7*               | Spindle Assy - RH  | 90549838 | 1    | 32.70 [14.83]   |
| 8                | Drum Brake Assembly, Bolt-On, Left-Hand, Meritor™                      | 90566001 | 1    | 71.80 [32.57]   |
| 9                | Drum Brake Assembly, Bolt-On, Right-Hand, Meritor™                     | 90566002 | 1    | 71.80 [32.57]   |
| 10               | Bracket, Super Chamber™, Left-Hand                                     | 90549983 | 1    | 5.59 [2.54]     |
| 11               | Bracket, Super Chamber™, Right-Hand                                    | 90549985 | 1    | 5.59 [2.54]     |
| 12               | Bracket, Lift, Left-Hand   | 90026594 | 1    | 3.74 [1.70]     |
| 13               | Bracket, Lift, Right-Hand  | 90026595 | 1    | 3.74 [1.70]     |
| 14               | Rod End, 3/4" -16, Left-Hand   | 90045696 | 1    | 1.18 [0.53]     |
| 15               | Rod End, 3/4" -16, Right-Hand  | 90045695 | 1    | 1.18 [0.53]     |
| 16*              | Super Chamber™   | 90566000 | 2    | 16.00 [7.26]    |
| 17               | Tie Rod Weldment   | 90549910 | 1    | 11.10 [5.03]    |
| 18               | Air Spring Assembly  | 90557417 | 2    | 9.59 [4.35]     |
| 19*              | Crossmember  | 90026642 | 1    | 20.50 [9.30]    |
| 20               | Plate Support, Lower Air Spring  | 90034877 | 2    | 4.96 [2.25]     |
| 21               | Steering Damper  | 90045662 | 2    | 15.00 [6.80]    |
| 22               | Control Arm - Machined   | 90015168 | 4    | 17.50 [7.94]    |
| 23               | Bushing  | 90008280 | 8    | 0.39 [0.17]     |
| 24               | Core Pin   | 90038544 | 8    | 1.25 [0.57]     |
| 25               | Flat Washer, Lock-Out  | 93600566 | 16   | 0.03 [0.01]     |
| 26               | King Pin   | 90038548 | 2    | 5.46 [2.48]     |
| 27               | End Cap  | 90010068 | 2    | 0.78 [0.36]     |
| 28               | Spacer   | 90036286 | 2    | 0.18 [0.08]     |
| 29               | Bearing, Spherical, Plain  | 90045663 | 4    | 2.12 [0.96]     |
| 30               | Fitting Grease   | 93800229 | 2    | 0.01 [0.005]    |
| 31               | Retainer   | 90034869 | 4    | 0.53 [0.24]     |

| LSZ13 PARTS LIST |   |                |      |                 |
|------------------|---|----------------|------|-----------------|
| ITEM NO.         | DESCRIPTION                                   | PART NO.       | QTY. | WEIGHT LBS [KG] |
| 32               | Spacer, Seal                                  | 90036289       | 2    | 0.86 [0.39]     |
| 33               | Seal  | 90070000       | 2    | 1.90 [0.86]     |
| 34               | Hub and Drum Assembly, Webb™                  | 90570000       | 2    | 113.00 [51.26]  |
|                  | Hub and Drum Assembly, KIC™                   | 90570004       | 2    | 118.00 [53.52]  |
|                  | Hub and Drum Assembly, Walther™               | 90570005       | 2    | 97.00 [44.00]   |
| 35               | Taper Bearing Cone, 2-5/8" Inboard            | 90070001       | 2    | 2.76 [0.57]     |
| 36               | Taper Bearing Cone, 1-3/4" Outboard           | 90070002       | 2    | 1.23 [0.56]     |
| 37               | Nut, Pro-Torque                               | 90070005       | 2    | 0.97 [0.44]     |
| 38               | Gasket  | 90070004       | 2    | 0.20 [0.09]     |
| 39*              | Hub Cap                                       | 90070003       | 2    | 2.01 [0.91]     |
| 40               | Bearing, Lift Bracket                         | 90045716       | 2    | 0.02 [0.01]     |
| 43               | 3/8" Male Run Tee                             | 93800338       | 2    | 0.01 [0.005]    |
| 44               | 3/8" Male Elbow                               | 93800339       | 2    | 0.02 [0.01]     |
| 45               | Spacer  | 90034902       | 2    | 1.91 [0.87]     |
| 46               | Spacer, Rod End                               | 90036293       | 2    | 0.20 [0.09]     |
| 47               | Rod Seal                                      | 90045707       | 4    | 0.02 [0.01]     |
| 48               | Tube, 3/8" Diameter x 6" Long                 | Neway Supplied | 2    | N/A             |
| 49               | Service Chamber, Type 20                      | 90566003       | 2    | 7.00 [3.18]     |
| 50               | Hex Head Cap Screw, 5/16"-18 x 1" GR 5        | 93002463       | 12   | 0.01 [0.005]    |
| 51               | Bolt, Hex, 3/8"-16 x 1" GR 8                  | 93002573       | 20   | 0.01 [0.005]    |
| 52               | Bolt, Hex, 1/2"-13 x 2-3/4" GR 5              | 93002937       | 4    | 0.01 [0.005]    |
| 53               | Cap Screw, Hex, 5/8"-18 x 2" GR 8             | 93003348       | 10   | 0.01 [0.005]    |
| 54               | Cap Screw, Hex, 3/4"-10 x 2-1/4" GR 8         | 93003569       | 2    | 0.01 [0.005]    |
| 55               | Cap Screw, Hex, 3/4"-10 x 4" GR 5             | 93003609       | 4    | 0.58 [0.26]     |
| 56               | Bolt Hex, 1/2"-13 x 1-1/2" GR 5               | 93002907       | 4    | 0.01 [0.005]    |
| 57               | Cap Screw, Hex, 3/4"-10 x 4-1/4" GR 8         | 93003617       | 2    | 0.68 [0.31]     |
| 58               | Cap Screw, Hex, 3/4"-10 GR 8 6.00"            | 93003659       | 4    | 0.90 [0.40]     |
| 59               | Cap Screw, Hex, 3/4"-10 x 9-1/2" GR 8         | 93003743       | 2    | 1.14 [0.52]     |
| 60               | Nut, Hex, Lock, 5/8"-18 GR C                  | 93400491       | 10   | 0.07 [0.03]     |
| 61               | Jam Nut, 3/4"-16 GR C                         | 93400271       | 1    | 0.33 [0.15]     |
| 62               | Nut, Hex, Lock, 1/2"-13 GR B                  | 93400480       | 4    | 0.04 [0.02]     |
| 63               | Nut, Hex, Lock, .75-10 GR C                   | 93400494       | 18   | 0.11 [0.05]     |
| 64               | Jam Nut, 3/4"-16, LH                          | 93400631       | 1    | 0.06 [0.03]     |
| 65               | Washer, Lock, 5/16"                           | 93600043       | 16   | 0.01 [0.005]    |
| 66               | Washer, Lock, 3/8"                            | 93600045       | 20   | 0.01 [0.005]    |
| 67               | Washer, Lock, 1/2"                            | 93600049       | 4    | 0.01 [0.005]    |
| 68               | Washer, Flat, Hard, 1/2"                      | 93600138       | 8    | 0.02 [0.01]     |
| 69               | Washer, Flat Narrow 0.75                      | 93600156       | 36   | 0.04 [0.02]     |
| 70               | Washer, Flat, Hard, 5/8"                      | 93600555       | 20   | 0.04 [0.02]     |
| 71               | Cap Screw, Hex 3/4-10 x 6.5 GR 8              | 93003671       | 4    | 0.01 [0.005]    |
| 164              | Shelf Bracket - LH 8-1/2" - 11-1/2" Ride HGHT | 90026726       | 1    | 4.95 [2.25]     |
|                  | Shelf Bracket - LH 11-1/2" - 14-1/2" Ride HGT | 90026728       | 1    | 6.00 [2.72]     |
| 165              | Shelf Bracket - RH 8-1/2" - 11-1/2" Ride HGT  | 90026725       | 1    | 4.95 [2.25]     |
|                  | Shelf Bracket - RH 11-1/2" - 14-1/2" Ride HGT | 90026727       | 1    | 6.00 [2.72]     |
| 166              | Clevis, Machined                              | 90026770       | 2    | 0.18 [0.07]     |
| 167              | Washer, 3/4", Special Thick                   | 93600567       | 2    | 0.07 [0.03]     |
| 169              | Set Screw, 5/16" Lock                         | 93006046       | 2    | 0.01 [0.005]    |
| 170              | Pin, Clevis                                   | 90501539       | 2    | 0.33 [0.15]     |
| 171              | Hex Head Cap Screw, 5/16-18 x 3/4" GR8        | 93002459       | 2    | 0.01 [0.005]    |

\*Not sold individually - must be purchased in kit.

# LSZ Brake Exploded View A and B



SAF-HOLLAND Group

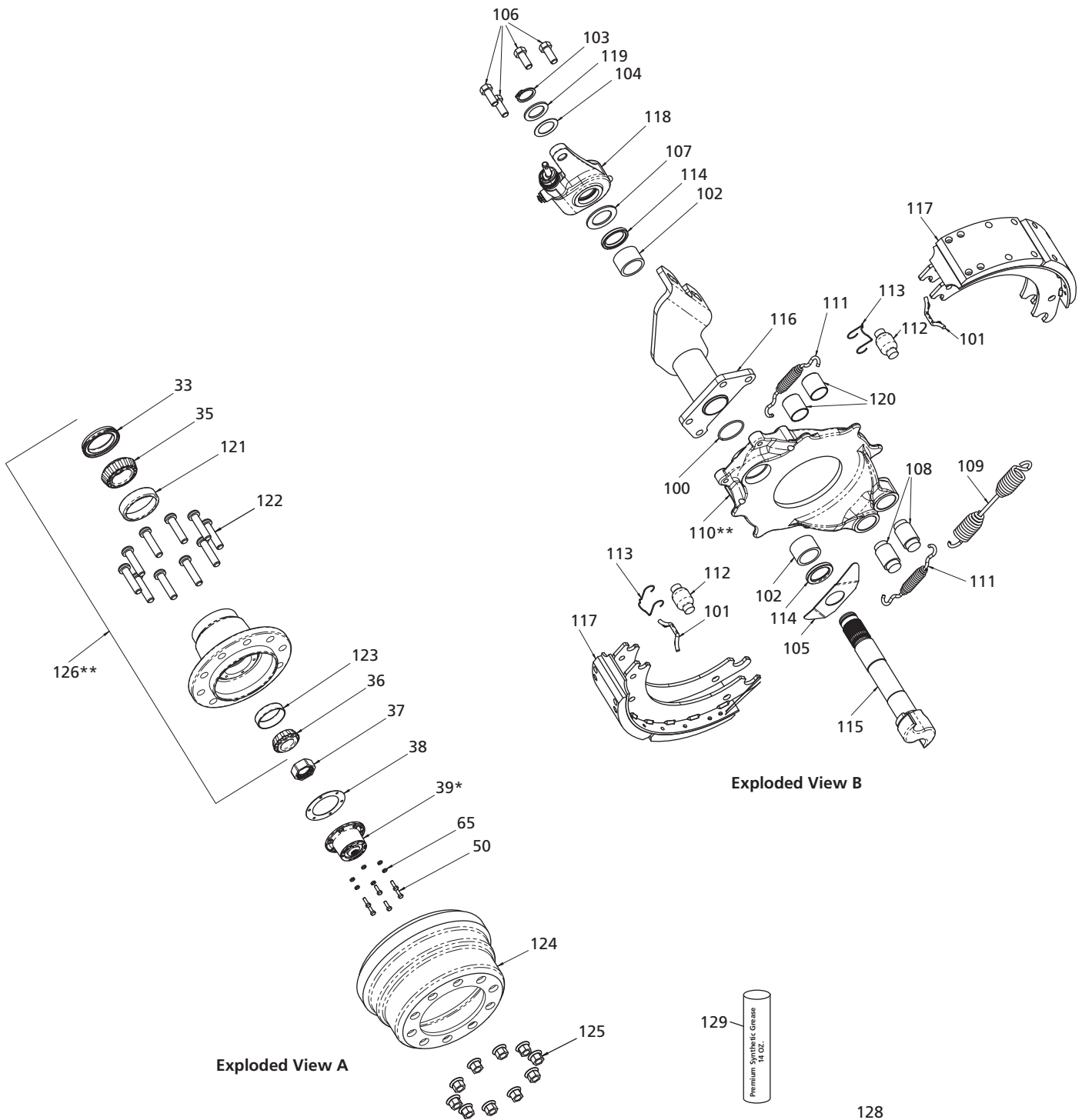

Exploded View A

Exploded View B

**WARNING**

Minimum tire clearance **MUST** be maintained between tires and nearest point of contact on the suspension or vehicle. Premature tire wear, tire or loss of vehicle control could result from contact with the tires if clearances are not maintained.

**TIRE CLEARANCE REQUIREMENTS**

- 1 INCH (25.4 mm) MINIMUM VERTICAL tire clearance is required between the top of the tire and the nearest point of contact above the tire when the air pressure is completely exhausted from the air suspension or when the axle is fully lifted if equipped with a suspension lift feature.
- 2 INCH (50.8 mm) MINIMUM LATERAL tire clearance is required between the sides of the tire and the nearest point of contact through total travel of the air suspension. This includes when the wheels are fully turned in either direction if equipped with an SAF® or NEWAY® Steer Axle.

SAF-Holland Copyright © 2014 SAF-HOLLAND, Inc. www.saf-holland.com XL-AR05-01

**NEWAY**  
SAF-HOLLAND Group

**LSZ SERIES SUSPENSION TORQUE SPECIFICATIONS**

| Fastener Size     | Pivot Connections, U-Bolts, Kingpin, and Tie Rod | Steering Damper   | Bolt-On Brake Assembly | Super Chamber® and Service Chamber | Lower Air Spring  | Chamber Bracket   | Retainer Plates | Upper Air Spring Bracket |
|-------------------|--|-------------------|------------------------|------------------------------------|-------------------|-------------------|-----------------|--------------------------|
| 200-250 (271-339) | 3/4"-10 (3/4"-10)                                | 135-155 (180-210) | 150-180 (203-244)      | 5/8"-11 (5/8"-11)                  | 1/2"-13 (1/2"-13) | 1/2"-13 (3/8"-16) | 25-35 (34-47)   | 15-20 (20-27)            |
| 150-180 (203-244) | 3/4"-10 (3/4"-10)                                | 135-155 (180-210) | 150-180 (203-244)      | 5/8"-11 (5/8"-11)                  | 1/2"-13 (1/2"-13) | 1/2"-13 (3/8"-16) | 25-35 (34-47)   | 15-20 (20-27)            |

Torques are with clean, lubricated threads. Always apply torque to nut whenever possible.

Required re-torquing schedule:  
 • All fasteners after first 100 hours or service or 5,000 miles.  
 • 50,000 mile intervals, routine preventative maintenance, or brake relining.

**SAF-Holland**  
Copyright © 2014 SAF-HOLLAND, Inc. www.saf-holland.com

| ITEM NO. | DESCRIPTION                              | PART NO.               | QTY. | WEIGHT LBS [KG] |
|----------|--|------------------------|------|-----------------|
| 33       | Seal                                     | 90070000               | 2    | 1.90 [0.86]     |
| 35       | Bearing, Stemco                          | 90070001               | 2    | 2.76 [1.25]     |
| 36       | Bearing, Stemco                          | 90070002               | 2    | 1.23 [0.56]     |
| 37       | Nut, Pro Torque                          | 90070005               | 2    | 0.97 [0.44]     |
| 38       | Gasket                                   | 90070004               | 2    | 0.20 [0.09]     |
| 39*      | Hub                                      | 90070003               | 2    | 2.01 [0.91]     |
| 50       | Bolt Hex 5/16-18 x 1.00 GR 5             | 93002463               | 12   | 0.01 [0.005]    |
| 65       | Lock Washer, Extra Duty, Helical Spring  | 93600043               | 12   | 0.01 [0.005]    |
| 100      | O-ring, camshaft tube                    | 90066000               | 2    | 0.01 [0.005]    |
| 101      | Pin, spring return                       | 90066001               | 4    | 0.01 [0.005]    |
| 102      | Bushing, camshaft                        | 90066003               | 4    | 0.04 [0.02]     |
| 103      | Ring, Retaining                          | 90066004               | 2    | 0.01 [0.005]    |
| 104      | Washer, slack adjuster, thin             | 90066005               | 2    | 0.01 [0.005]    |
| 105      | Washer, under cam head                   | 90066006               | 2    | 0.02 [0.01]     |
| 106      | Cap screw mounting cam bracket           | 90066007               | 8    | 0.02 [0.01]     |
| 107      | Washer                                   | 90066008               | 2    | 0.01 [0.005]    |
| 108      | Pin, anchor                              | 90066009               | 4    | 0.09 [0.04]     |
| 109      | Spring, return                           | 90066012               | 2    | 0.60 [0.27]     |
| 110**    | Spider, RS - See Item #8                 | *Not Sold Individually | 1    | N/A             |
|          | Spider, CS - See Item #9                 |                        | 1    | N/A             |
| 111      | Spring, shoe retaining                   | 90066013               | 4    | 0.20 [0.09]     |
| 112      | Roller, CAM                              | 90066014               | 4    | 0.08 [0.04]     |
| 113      | Retainer, brake shoe roller              | 90066015               | 4    | 0.01 [0.005]    |
| 114      | Seal, camshaft                           | 90066016               | 4    | 0.02 [0.01]     |
| 115      | S-camshaft RS                            | 90066018               | 1    | N/A             |
| N/S      | S-camshaft CS                            | 90066017               | 1    | N/A             |
| 116      | Bracket, camshaft support RS             | 90066020               | 1    | N/A             |
| N/S      | Bracket, camshaft support CS             | 90066019               | 1    | N/A             |
| 117      | Shoe, brake lined                        | 90066021               | 4    | 16.90 [7.67]    |
| 118      | Slack adjuster w/ clevis                 | 90066022               | 2    | 6.20 [2.81]     |
| 119      | Washer, slack adjuster, thick            | 90066002               | 2    | 0.01 [0.005]    |
| 120      | Bushing, anchor pin                      | 90066011               | 4    | 0.01 [0.005]    |
| 121      | Cup, Bearing - Large (Stemco)            | 90070007               | 2    | 1.17 [0.53]     |
| 122      | Stud, M22 X 1.5                          | 90070006               | 20   | 0.82 [0.37]     |
| 123      | Cup, Bearing - Small (Stemco)            | 90070008               | 2    | 0.62 [0.28]     |
| 124      | Drum, 15 x 4 10-Stud - KIC               | 90070009               | 2    | N/A             |
|          | Drum, 15 x 4 10-Stud - Walther           | 90070010               |      |                 |
|          | Drum, 15 x 4 10-Stud - Webb              | 90070011               |      |                 |
| 125      | Nut                                      | 04247301201Z           | 20   | 0.30 [0.14]     |
| 126**    | Hub & Bearing Assy, FF 10-Stud - KIC     | 90570009               | 2    | N/A             |
|          | Hub & Bearing Assy, FF 10-Stud - Walther | 90570010               |      |                 |
|          | Hub & Bearing Assy, FF 10-Stud - Webb    | 90570011               |      |                 |
| 127      | Tire Clearance Decal                     | XL-AR356-01            | 1    | N/A             |
| 128      | Torque Decal                             | XL-PS20006DC-en-US     | 1    | N/A             |
| 129      | Premium Synthetic Grease 14 Oz.          | 50844001               | 1    | N/A             |

For LSZ Suspension Maintenance Manual, see Neway Publication XL-PS20011MM-en-US at [www.SAFHolland.us](http://www.SAFHolland.us)

\*Not sold individually - must be purchased in kit.

\*\*Not sold individually - must be purchased as an assembly.

# Parts List



SAF-HOLLAND Group

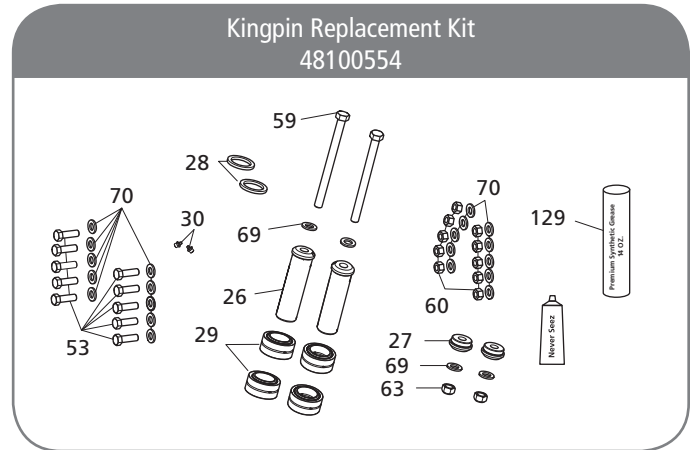
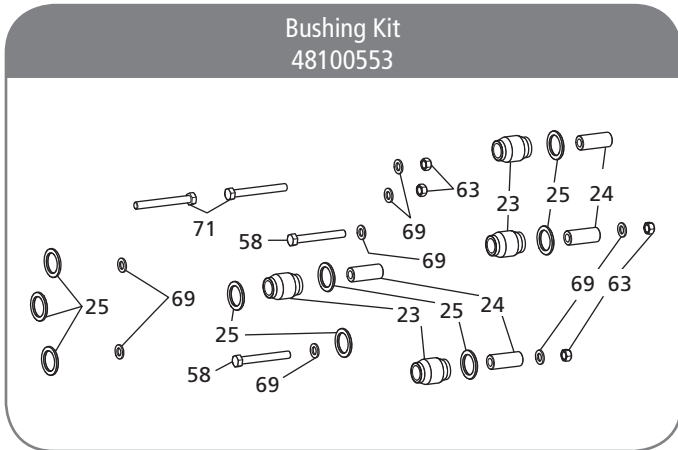
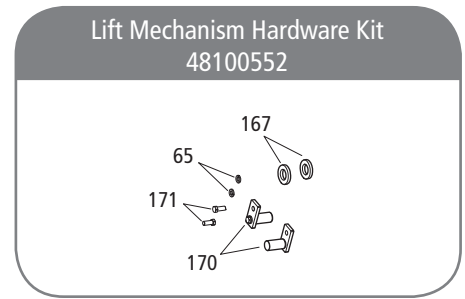
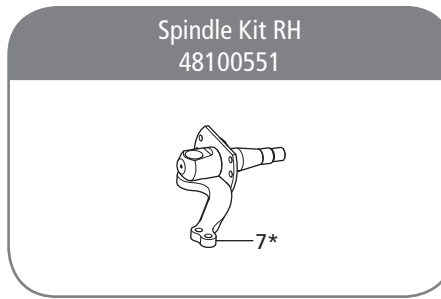
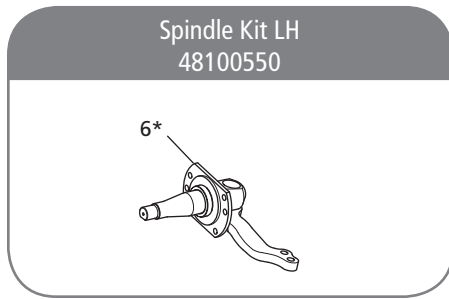

| ITEM NO. | DESCRIPTION                       | PART NO. | QTY. | WEIGHT LBS [KG] |
|----------|-----------------------------------|----------|------|-----------------|
| 6*       | Spindle Assy - LH                 | 90550180 | 1    | 33.60 [15.24]   |
| 7*       | Spindle Assy - RH                 | 90550181 | 1    | 33.60 [15.24]   |
| 23       | Bushing                           | 90008280 | 4    | 0.39 [0.17]     |
| 24       | Core Pin                          | 90038544 | 4    | 1.25 [0.57]     |
| 25       | Flat Washer, Lock-Out             | 93600566 | 8    | 0.03 [0.01]     |
| 26       | King Pin                          | 90038548 | 2    | 5.46 [2.48]     |
| 27       | End Cap - Plated                  | 90010068 | 2    | 0.78 [0.36]     |
| 28       | Spacer                            | 90036286 | 2    | 0.18 [0.08]     |
| 29       | Bearing, Spherical, Plain         | 90045663 | 4    | 2.12 [0.96]     |
| 30       | Fitting Grease                    | 93800229 | 2    | 0.01 [0.005]    |
| 32       | Spacer, Seal                      | 90036289 | 1    | 0.86 [0.39]     |
| 53       | Cap Screw, Hex, 5/8-11 GR 8       | 93003347 | 10   | 0.26 [0.12]     |
| 58       | Cap Screw, Hex, 3/4-10 GR 8 6.00" | 96003659 | 2    | N/A             |
| 59       | Cap Screw, Hex, 3/4-10x9.5 GR 8   | 93003743 | 2    | 1.14 [0.52]     |
| 60       | Nut, Hex, Lock 5/8-11 GR C        | 93400490 | 10   | 0.07 [0.03]     |

| ITEM NO. | DESCRIPTION   | PART NO. | QTY. | WEIGHT LBS [KG] |
|----------|---|----------|------|-----------------|
| 63       | Nut, Hex, Lock 3/4-10 GR C, Spindle Kit LH & RH     | 93400494 | 1    | 0.11 [0.05]     |
|          | Nut, Hex, Lock 3/4-10 GR C, Bushing Kit             |          | 4    | 0.11 [0.05]     |
|          | Nut, Hex, Lock 3/4-10 GR C, Kingpin Replacement Kit |          | 2    | 0.11 [0.05]     |
| 65       | Lock Washer, Extra Duty, Helical Spring             | 93600043 | 2    | 0.01 [0.005]    |
| 69       | Washer, Flat Narrow 3/4, Bushing Kit                | 93600156 | 8    | 0.04 [0.02]     |
|          | Washer, Flat Narrow 3/4, Kingpin Replacement Kit    |          | 4    | 0.04 [0.02]     |
| 70       | Washer, Flat 0.625 Hardened                         | 93600555 | 20   | 0.04 [0.02]     |
| 71       | Cap Screw, Hex 3/4-10 x 6-1/2 GR 8                  | 93003671 | 2    | 0.01 [0.005]    |
| 129      | Premium Synthetic Grease 14 Oz.                     | 50844001 | 1    | N/A             |
| 167      | Washer, 3/4", Special Thick                         | 93600567 | 2    | 0.07 [0.03]     |
| 170      | Pin, Clevis   | 90501539 | 2    | 0.33 [0.15]     |
| 171      | Hex Head Cap Screw, 5/16-18 x 3/4" GR8              | 93002459 | 2    | 0.01 [0.005]    |
| -        | NEVER-SEEZ  | XB-02967 | 1    | 0.02 [0.01]     |

\*Not sold individually - must be purchased in kit.



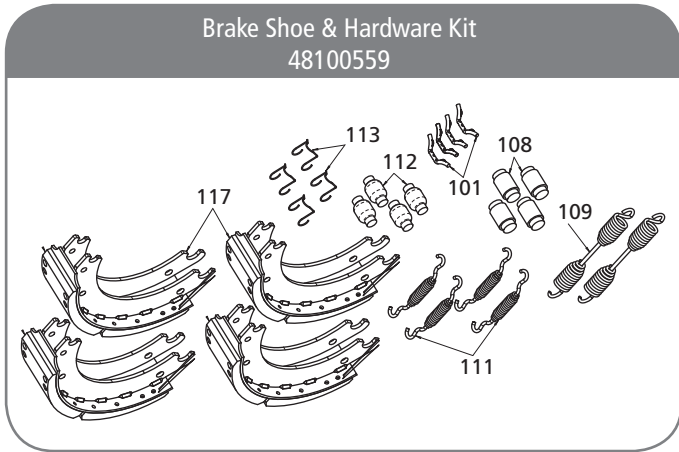
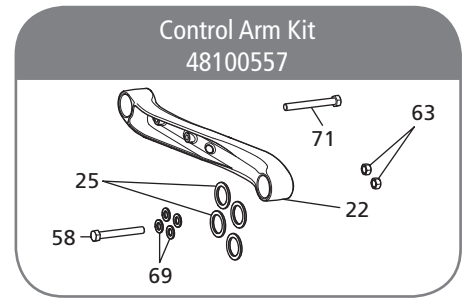
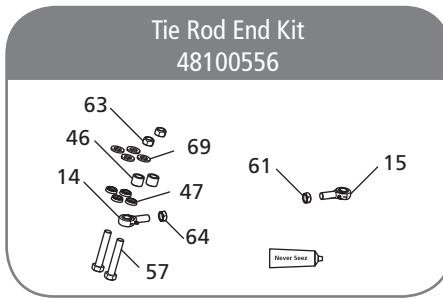
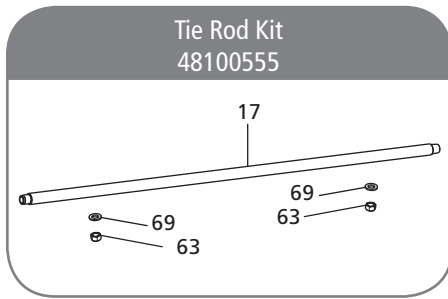

| ITEM NO. | DESCRIPTION                       | PART NO. | QTY. | WEIGHT LBS [KG] |
|----------|-----------------------------------|----------|------|-----------------|
| 14       | Rod End, 3/4-16, LH               | 90045696 | 1    | 1.18 [0.54]     |
| 15       | Rod End, 3/4-16, RH               | 90045695 | 1    | 1.18 [0.54]     |
| 17       | Tie Rod Weldment                  | 90549910 | 1    | 11.10 [5.03]    |
| 22       | Control Arm Assy.                 | 90517255 | 1    | 30.10 [13.65]   |
| 25       | Flat Washer, Lock-Out             | 93600566 | 4    | 0.03 [0.01]     |
| 46       | Spacer, Rod End - Painted         | 90036293 | 2    | 0.20 [0.09]     |
| 47       | Rod Seal                          | 90045707 | 4    | 0.02 [0.01]     |
| 57       | Cap Screw, Hex 3/4-10 GR 8 4.25"  | 93003617 | 2    | 0.68 [0.31]     |
| 58       | Cap Screw, Hex, 3/4-10 GR 8 6.00" | 96003659 | 1    | N/A             |
| 61       | Jam Nut, 3/4-16 GR C              | 93400271 | 1    | 0.33 [0.15]     |
| 63       | Nut, Hex, Lock 3/4-10 GR C        | 93400494 | 2    | 0.11 [0.05]     |
| 64       | Jam Nut, 3/4"-16, LH              | 93400631 | 1    | 0.06 [0.03]     |

| ITEM NO. | DESCRIPTION                              | PART NO. | QTY. | WEIGHT LBS [KG] |
|----------|--|----------|------|-----------------|
| 69       | Washer, Flat Narrow 3/4, Tie Rod End Kit | 93600156 | 4    | 0.04 [0.02]     |
|          | Washer, Flat Narrow 3/4, Control Arm Kit |          | 4    | 0.04 [0.02]     |
|          | Washer, Flat Narrow 3/4, Tie Rod Kit     |          | 2    | 0.04 [0.02]     |
| 71       | Cap Screw, Hex 3/4-10 x 6.5 GR 8         | 93003671 | 1    | 0.01 [0.005]    |
| 101      | Pin, spring return                       | 90066001 | 4    | 0.01 [0.005]    |
| 108      | Pin, anchor                              | 90066009 | 4    | 0.09 [0.04]     |
| 109      | Spring, return                           | 90066012 | 2    | 0.60 [0.27]     |
| 111      | Spring, shoe retaining                   | 90066013 | 4    | 0.20 [0.09]     |
| 112      | Roller, CAM                              | 90066014 | 4    | 0.08 [0.04]     |
| 113      | Retainer, brake shoe roller              | 90066015 | 4    | 0.01 [0.005]    |
| 117      | Shoe, brake lined                        | 90066021 | 4    | 16.90 [7.67]    |
| -        | NEVER-SEEZ                               | XB-02967 | 1    | 0.02 [0.01]     |

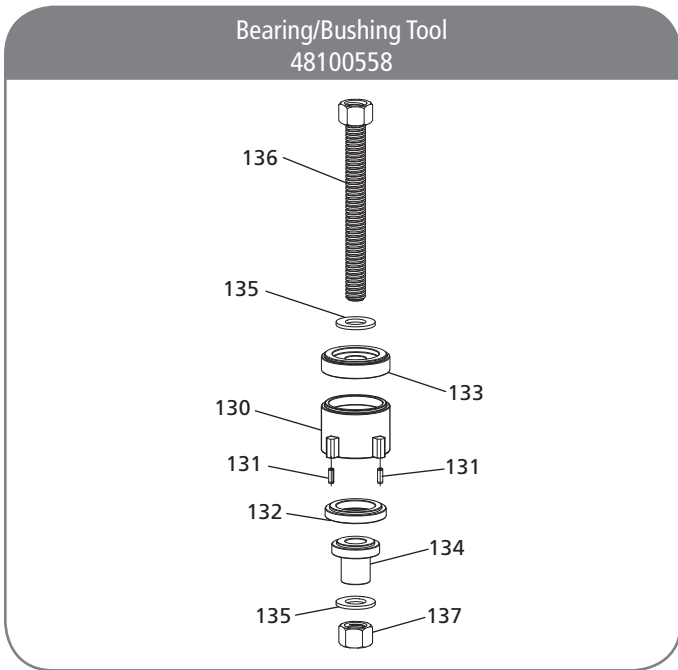

| ITEM NO. | DESCRIPTION                   | PART NO. | QTY. | WEIGHT LBS [KG] |
|----------|-------------------------------|----------|------|-----------------|
| 130      | Body Assy.                    | 50544018 | 1    | 1.40 [0.64]     |
| 131      | Spring Pin, 1/2 Dia. x 3/4 LG | 50044008 | 2    | 0.01 [0.005]    |
| 132      | Adapter                       | 50044006 | 1    | 0.57 [0.26]     |
| 133      | Bridge                        | 50044005 | 1    | 1.60 [0.73]     |
| 134      | Ram                           | 50044007 | 1    | 0.97 [0.44]     |
| 135      | Washer, 1.0                   | 93600168 | 2    | 0.08 [0.04]     |
| 136      | Acme Bolt                     | 50544019 | 1    | 0.01 [0.005]    |
| 137      | Acme Nut, 1" - 5              | 50044011 | 1    | 0.01 [0.005]    |

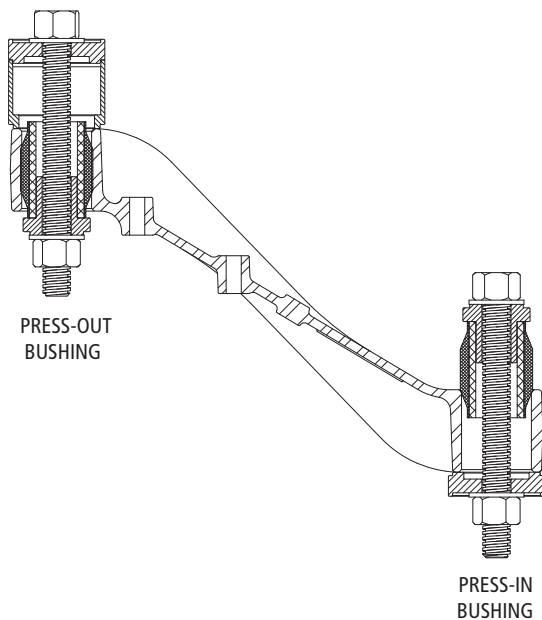
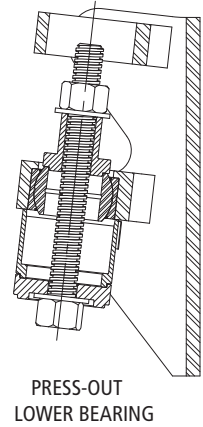
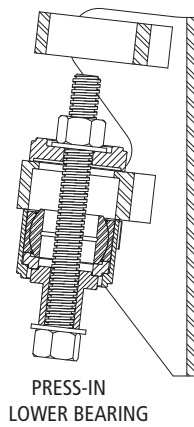
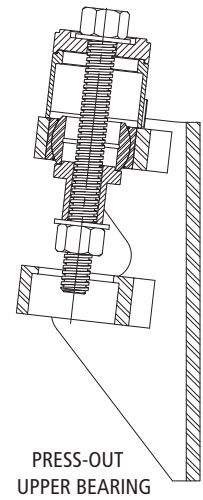
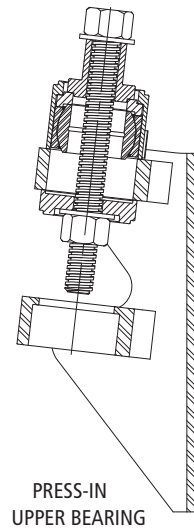

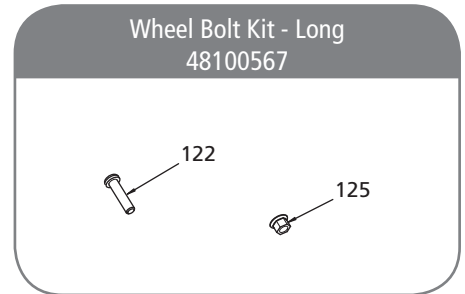
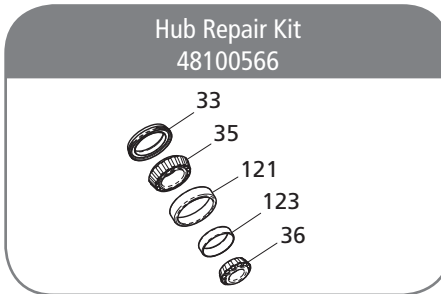
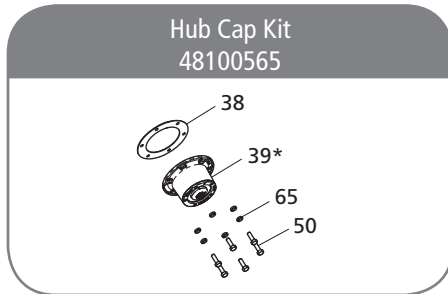
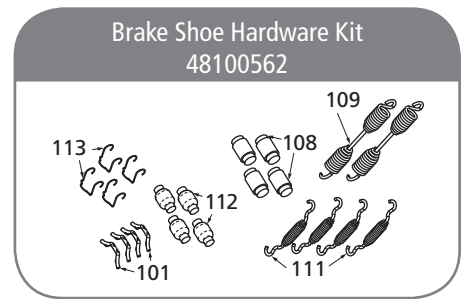
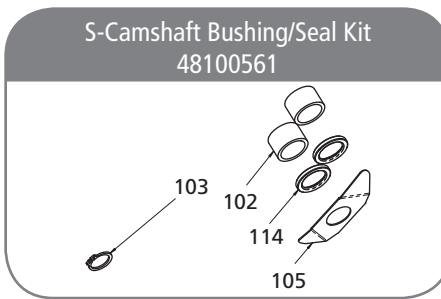
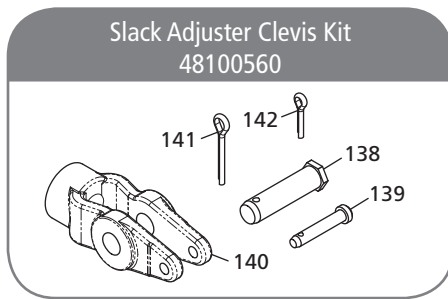

| ITEM NO. | DESCRIPTION                             | PART NO. | QTY. | WEIGHT LBS [KG] |
|----------|---|----------|------|-----------------|
| 33       | Seal                                    | 90010000 | 1    | N/A             |
| 35       | Bearing, Stemco                         | 90070001 | 1    | 2.76 [1.25]     |
| 36       | Bearing, Stemco                         | 90070002 | 1    | 1.23 [0.56]     |
| 38       | Gasket                                  | 90070004 | 1    | 0.20 [0.09]     |
| 39*      | Hub                                     | 90070003 | 1    | 2.01 [0.91]     |
| 50       | Bolt Hex 5/16-18 x 1.00 GR 5            | 93002463 | 6    | 0.01 [0.005]    |
| 65       | Lock Washer, Extra Duty, Helical Spring | 93600043 | 6    | 0.01 [0.005]    |
| 101      | Pin, Return Spring                      | 90066001 | 4    | 0.01 [0.005]    |
| 102      | Bushing, Camshaft                       | 90066003 | 2    | 0.04 [0.02]     |
| 103      | Ring, Retaining                         | 90066004 | 1    | 0.01 [0.005]    |
| 105      | Washer, Under Cam Head                  | 90066006 | 1    | 0.02 [0.01]     |
| 108      | Anchor Pin                              | 90066009 | 4    | 0.09 [0.04]     |
| 109      | Spring, Return                          | 90066012 | 2    | 0.60 [0.27]     |

| ITEM NO. | DESCRIPTION                   | PART NO.     | QTY. | WEIGHT LBS [KG] |
|----------|-------------------------------|--------------|------|-----------------|
| 111      | Spring, Shoe Retaining        | 90066013     | 4    | 0.20 [0.09]     |
| 112      | Roller, Cam                   | 90066014     | 4    | 0.08 [0.04]     |
| 113      | Retainer, Cam Roller          | 90066015     | 4    | 0.01 [0.005]    |
| 114      | Seal, camshaft                | 90066016     | 2    | 0.02 [0.01]     |
| 121      | Cup, Bearing - Large (Stemco) | 90070007     | 1    | 1.17 [0.53]     |
| 122      | Stud, M22 X 1-1/2             | 90070006     | 1    | 0.82 [0.37]     |
| 123      | Cup, Bearing - Small (Stemco) | 90070008     | 1    | 0.62 [0.28]     |
| 125      | Nut                           | 04247301201Z | 1    | 0.30 [0.14]     |
| 138      | Clevis Pin, Large             | 90066023     | 1    | 0.11 [0.05]     |
| 139      | Clevis Pin, Small             | 90066024     | 1    | 0.02 [0.01]     |
| 140      | Clevis, Slack Adjuster        | 90066027     | 1    | 0.67 [0.30]     |
| 141      | Cotter Pin, Large             | 90066028     | 1    | 0.01 [0.005]    |
| 142      | Cotter Pin, Small             | 90066029     | 1    | 0.01 [0.005]    |

\*Not sold individually - must be purchased in kit.

# Parts List



SAF-HOLLAND Group

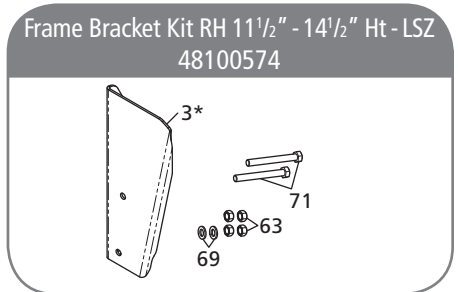
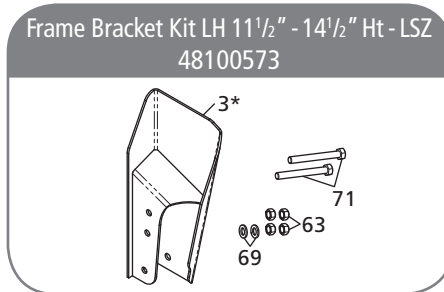
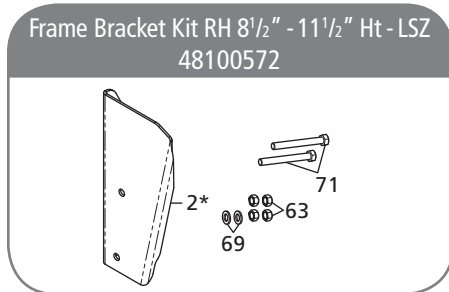
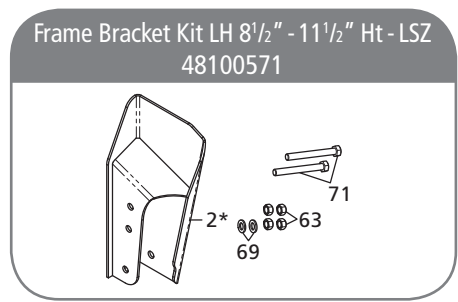
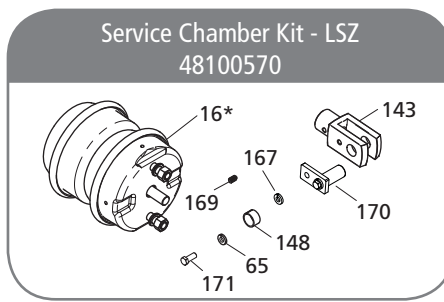
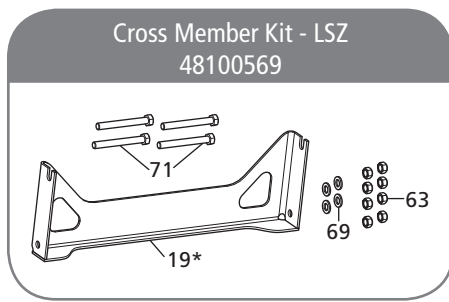

| ITEM NO. | DESCRIPTION   | PART NO. | QTY. | WEIGHT LBS [KG] |
|----------|---|----------|------|-----------------|
| 2*       | Frame Bracket Assy., LH, 8-1/2" - 11-1/2" Ride HGHT - Paint | 90522440 | 1    | 25.30 [11.48]   |
|          | Frame Bracket Assy., RH, 8-1/2" - 11-1/2" Ride HGHT - Paint | 90522442 | 1    | 25.30 [11.48]   |
| 3*       | Frame Bracket Assy., LH, 11-1/2" - 14-1/2" Ride HGT - Paint | 90522444 | 1    | 28.60 [12.97]   |
|          | Frame Bracket Assy., RH, 11-1/2" - 14-1/2" Ride HGT - Paint | 90522446 | 1    | 28.60 [12.97]   |
| 16*      | Super Chamber™  | 90566000 | 1    | 16.00 [7.26]    |
| 19*      | Crossmember - Painted                                       | 90026642 | 1    | 20.50 [9.30]    |
| 63       | Nut, Hex, Lock, 3/4-10 GR C, Cross Member Kit               | 93400494 | 8    | 0.11 [0.05]     |
|          | Nut, Hex, Lock, 3/4-10 GR C, Frame Bracket Kit              |          | 4    | 0.11 [0.05]     |
| 65       | Lock Washer, Extra Duty, Helical Spring                     | 93600043 | 1    | 0.01 [0.005]    |

| ITEM NO. | DESCRIPTION                                       | PART NO. | QTY. | WEIGHT LBS [KG] |
|----------|---|----------|------|-----------------|
| 69       | Washer, Flat, Narrow, 3/4, Cross Member Kit       | 93600156 | 4    | 0.04 [0.02]     |
|          | Washer, Flat, Narrow, 3/4, Frame Bracket Kit      |          | 2    | 0.04 [0.02]     |
| 71       | Cap Screw, Hex 3/4-10x6.5 GR 8, Cross Member Kit  | 93003671 | 4    | 0.01 [0.005]    |
|          | Cap Screw, Hex 3/4-10x6.5 GR 8, Frame Bracket Kit |          | 2    | 0.01 [0.005]    |
| 143      | Clevis, Altered - MCP                             | 90026770 | 1    | 0.18 [0.08]     |
| 148      | Bearing   | 90045716 | 1    | 0.02 [0.01]     |
| 167      | Washer, 3/4", Special Thick                       | 93600567 | 1    | 0.07 [0.03]     |
| 169      | Set Screw, 5/16" Lock                             | 93006046 | 1    | 0.01 [0.005]    |
| 170      | Pin, Clevis                                       | 90501539 | 1    | 0.33 [0.15]     |
| 171      | Hex Head Cap Screw, 5/16-18 x 3/4" GR8            | 93002459 | 1    | 0.01 [0.005]    |

\*Not sold individually - must be purchased in kit.

| MODEL   | RIDE HEIGHT | "A" DIMENSION |
|---------|-------------|---------------|
| LSZ1310 | 8.5"        | 17-13/16"     |
|         | 9"          | 17-5/8"       |
|         | 9.5"        | 17-1/2"       |
|         | 10"         | 17-3/8"       |
|         | 10.5"       | 17-3/16"      |
|         | 11"         | 17"           |
| LSZ1313 | 11.5"       | 17-13/16"     |
|         | 12"         | 17-5/8"       |
|         | 12.5"       | 17-1/2"       |
|         | 13"         | 17-3/8"       |
|         | 13.5"       | 17-3/16"      |
|         | 14"         | 17"           |
|         | 14.5"       | 16-3/4"       |

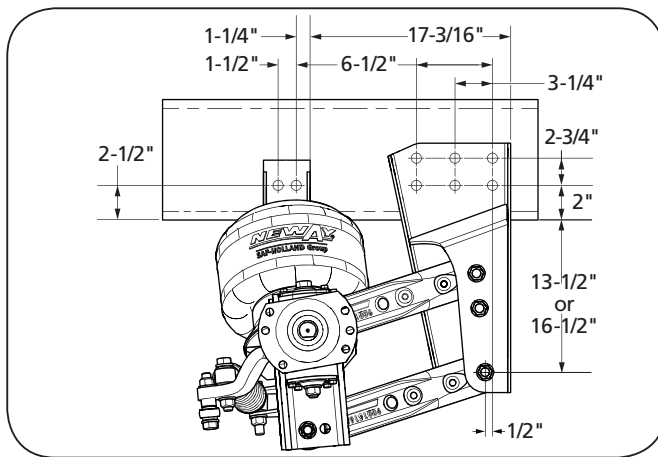
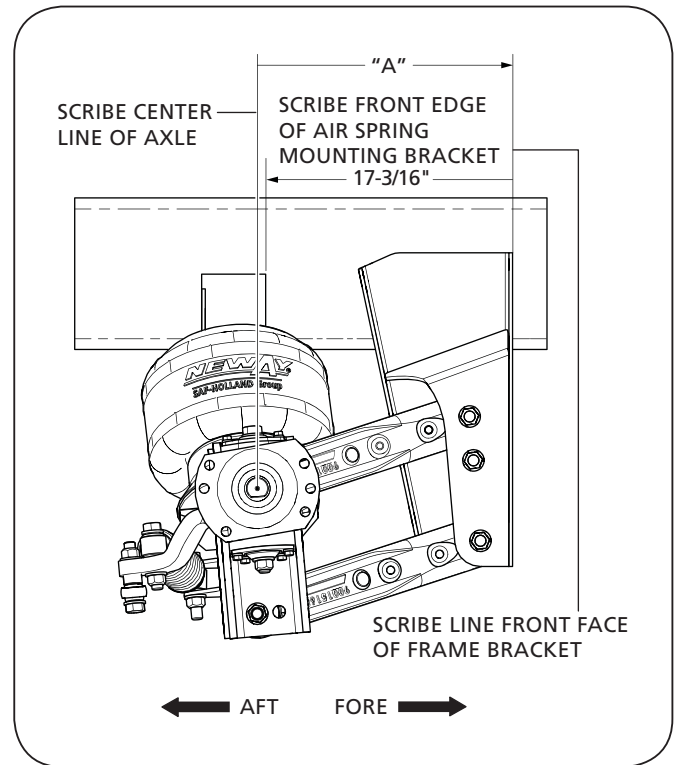

Suggested Hole Pattern

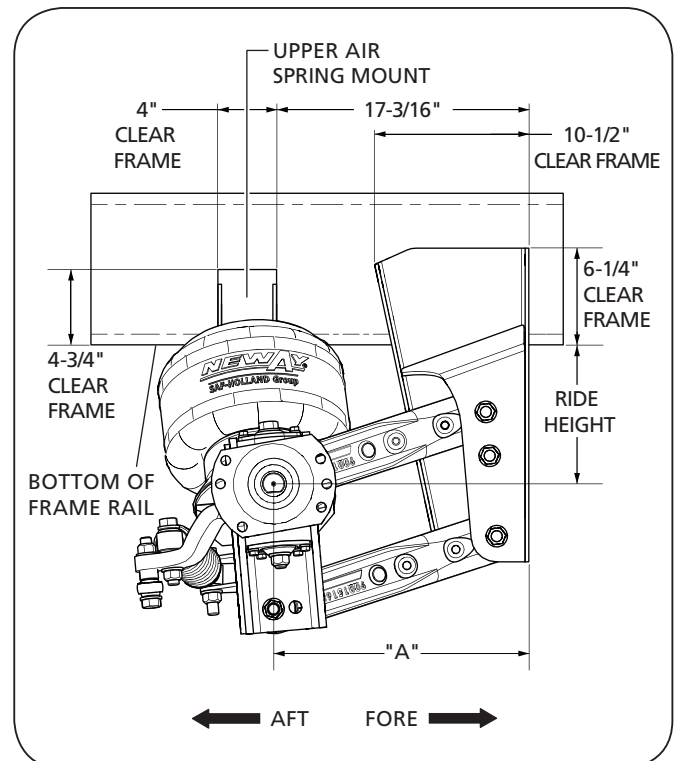

# LSZ - Air Kit, In-Cab Mount



SAF-HOLLAND Group

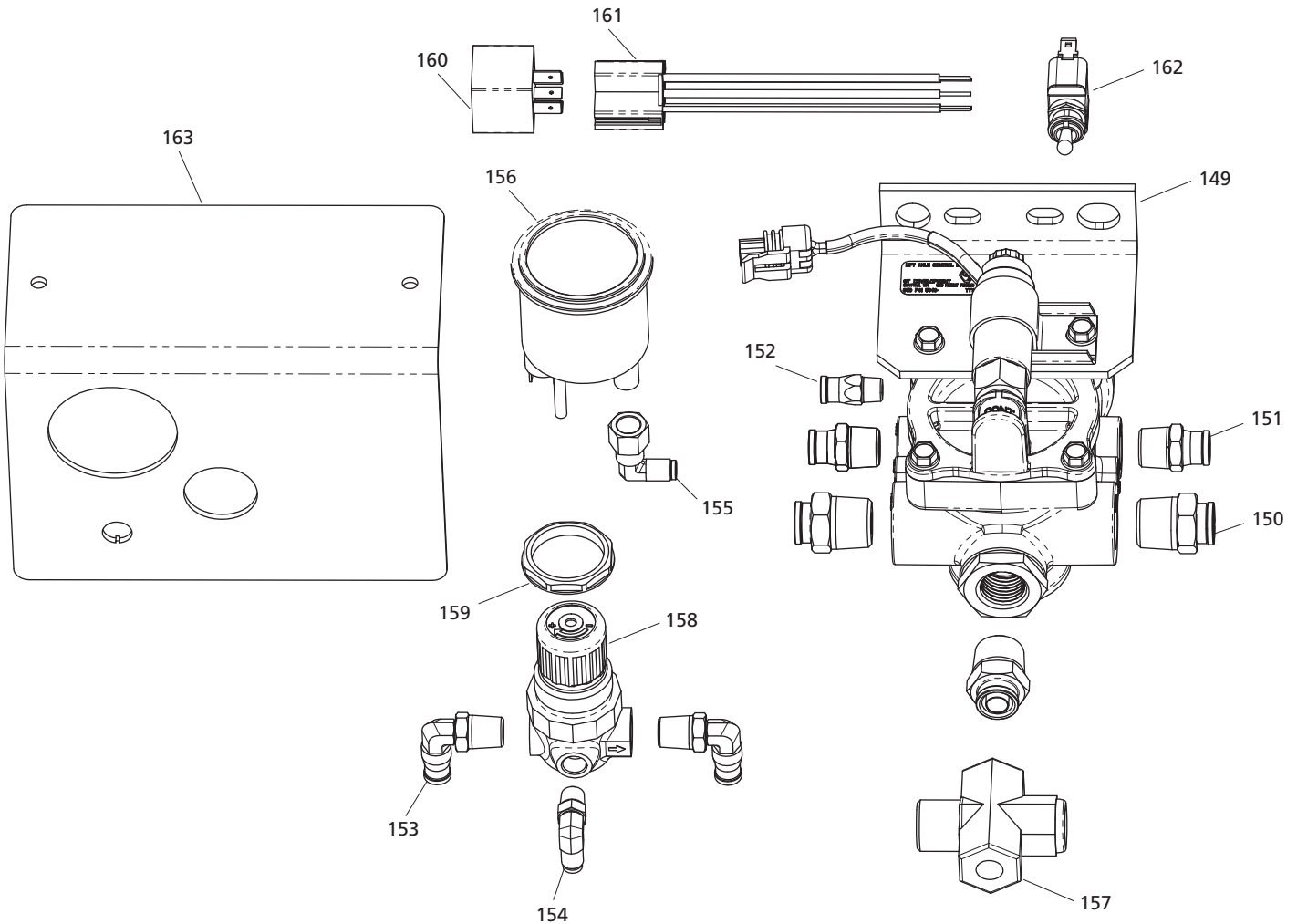

| ITEM NO. | DESCRIPTION                               | PART NO. | QTY. | WEIGHT LBS [KG] |
|----------|---|----------|------|-----------------|
| 149      | Lift Axle Control Module, Normally Closed | 90060004 | 1    | 3.35 [1.52]     |
| 150      | Fitting, 1/2" x 1/2" Push Connect w/Cap   | 90060012 | 3    | 0.02 [0.01]     |
| 151      | Fitting, 3/8" x 3/8" Push Connect w/Cap   | 90060013 | 3    | 0.08 [0.03]     |
| 152      | Fitting, 1/4" x 1/8" Push Connect w/Cap   | 90060014 | 1    | 0.03 [0.01]     |
| 153      | Fitting, 1/4" x 1/4" Push Connect w/Cap   | 90060015 | 2    | 0.08 [0.04]     |
| 154      | Fitting, 5/32" x 1/8" Push Connect w/Cap  | 90060016 | 1    | 0.05 [0.02]     |
| 155      | Fitting, 5/32" x 1/8" Push Connect w/Cap  | 90060017 | 1    | 0.06 [0.03]     |
| 156      | Gauge, Air Pressure-Lit                   | 90060010 | 1    | 1.85 [0.84]     |

| ITEM NO. | DESCRIPTION                   | PART NO. | QTY. | WEIGHT LBS [KG] |
|----------|-------------------------------|----------|------|-----------------|
| 157      | Pressure Protection Valve     | 90060005 | 1    | 0.58 [0.26]     |
| 158      | Regulator Valve, Air Pressure | 90060006 | 1    | 1.11 [0.50]     |
| 159      | Nut, Regulator Panel          | 90060007 | 1    | 0.01 [0.02]     |
| 160      | Relay                         | 90060008 | 1    | 0.09 [0.04]     |
| 161      | Relay Socket                  | 90060009 | 1    | 0.24 [0.11]     |
| 162      | Toggle Switch                 | 90060018 | 1    | 0.20 [0.09]     |
| 163      | Panel, Control                | 90060019 | 1    | 1.66 [0.75]     |

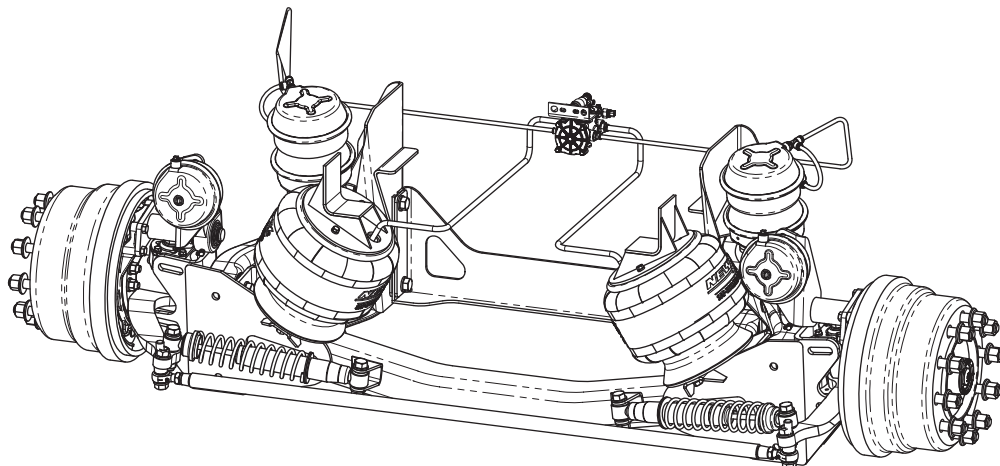
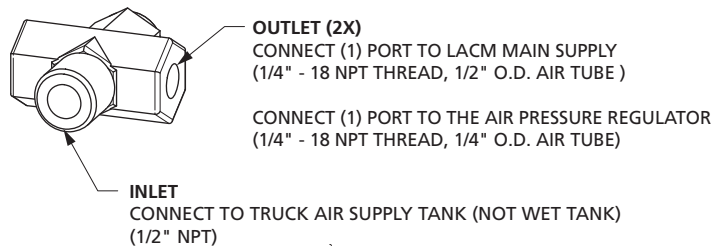
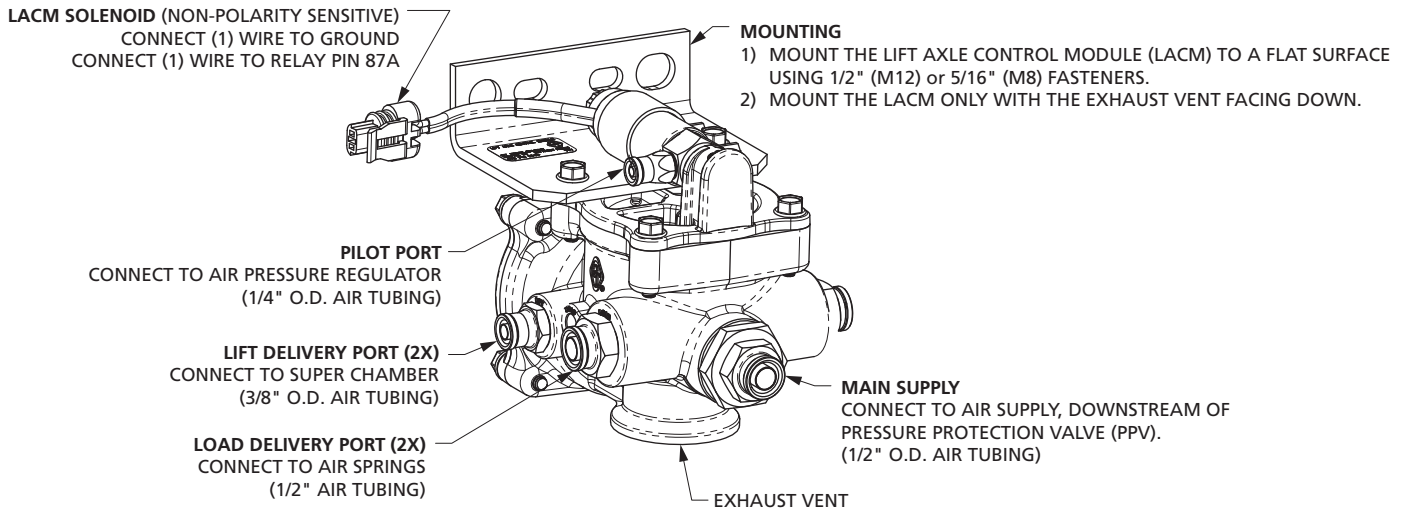
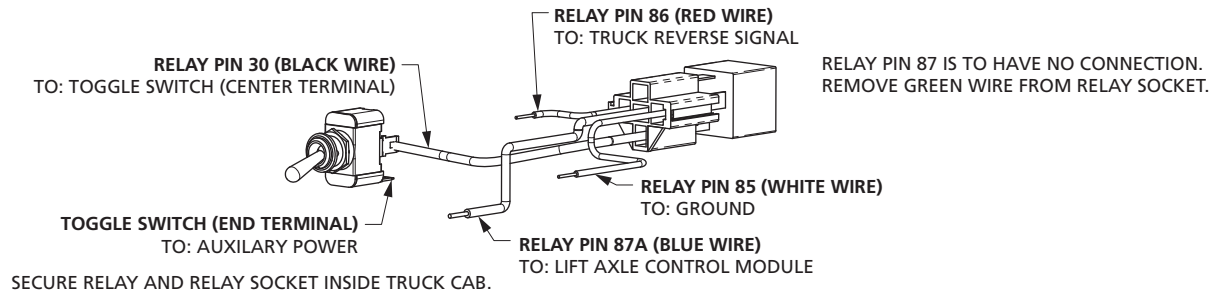

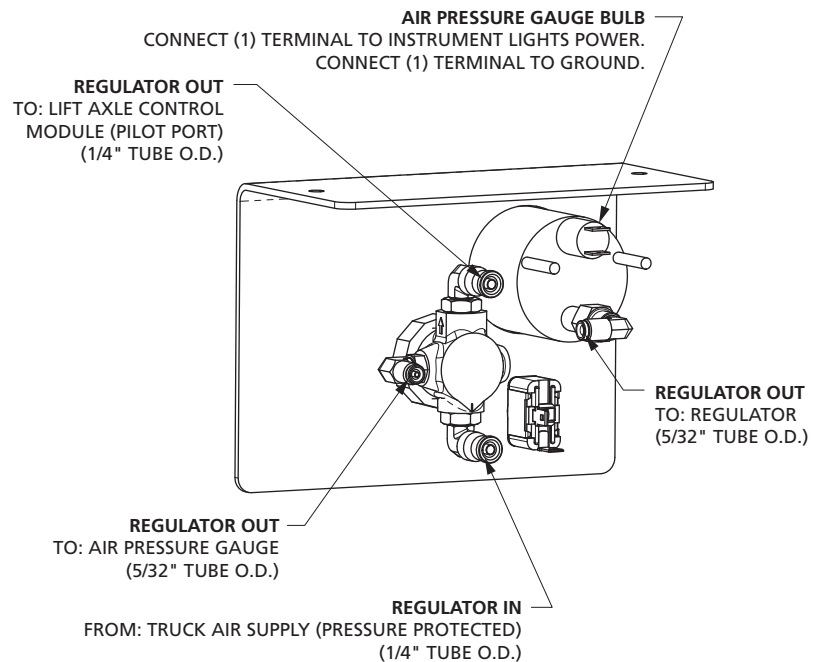
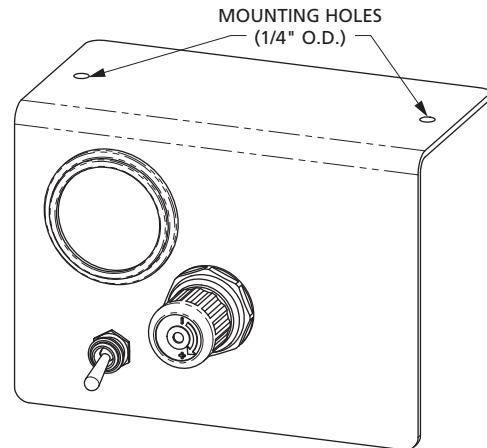
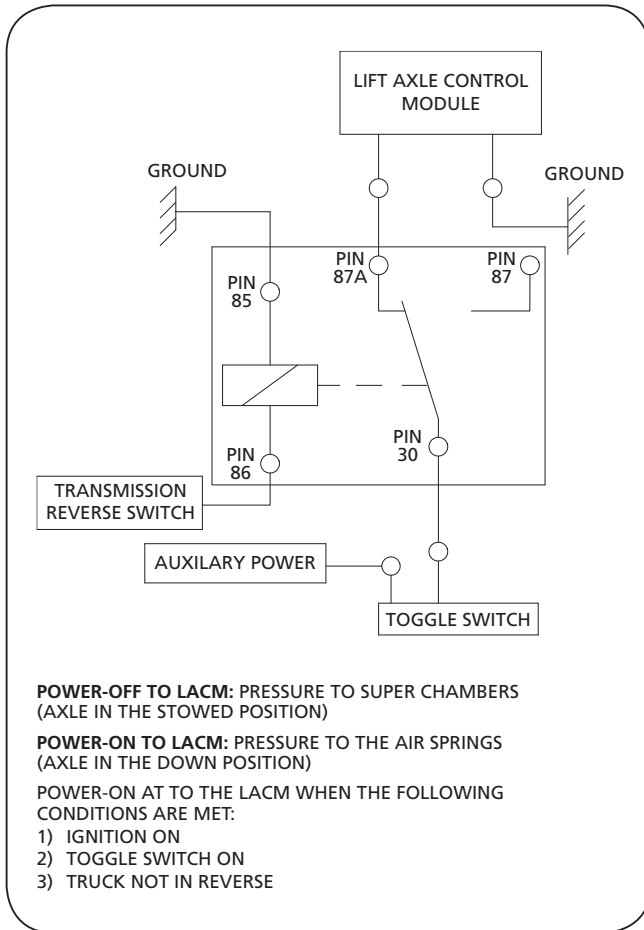



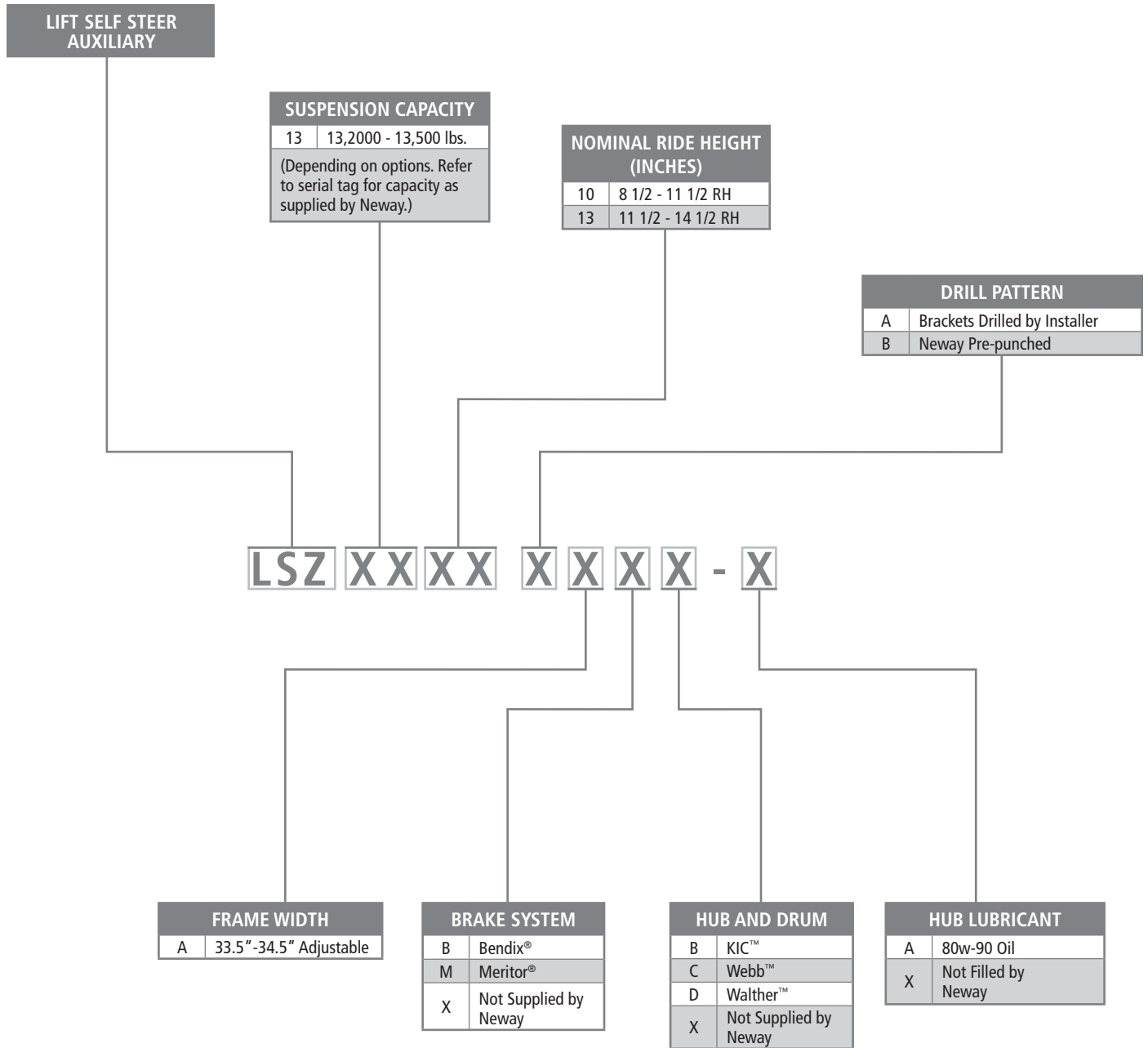

| PART NO. | PAGE NO. |
|----------|----------|
| 50044005 | 10       |
| 50044006 | 10       |
| 50044007 | 10       |
| 50044008 | 10       |
| 50044011 | 10       |
| 50544018 | 10       |
| 50544019 | 10       |
| 50844001 | 7,8      |
| 90008280 | 5, 8     |
| 90010000 | 11       |
| 90010068 | 5, 8     |
| 90015168 | 5        |
| 90026594 | 5        |
| 90026595 | 5        |
| 90026642 | 5, 12    |
| 90026725 | 5        |
| 90026726 | 5        |
| 90026727 | 5        |
| 90026728 | 5        |
| 90026770 | 5, 12    |
| 90034869 | 5        |
| 90034877 | 5        |
| 90034902 | 5        |
| 90036286 | 5, 8     |
| 90036289 | 5, 8     |
| 90036293 | 5, 9     |
| 90038544 | 5, 8     |
| 90038548 | 5, 8     |
| 90045662 | 5        |
| 90045663 | 5, 8     |
| 90045695 | 5, 9     |
| 90045696 | 5, 9     |
| 90045707 | 5, 9     |
| 90045716 | 5, 12    |
| 90060004 | 15       |
| 90060005 | 15       |
| 90060006 | 15       |
| 90060007 | 15       |
| 90060008 | 15       |
| 90060009 | 15       |
| 90060010 | 15       |
| 90060012 | 15       |
| 90060013 | 15       |
| 90060014 | 15       |
| 90060015 | 15       |
| 90060016 | 15       |
| 90060017 | 15       |
| 90060018 | 15       |
| 90060019 | 15       |

| PART NO. | PAGE NO. |
|----------|----------|
| 90066000 | 7        |
| 90066001 | 7, 9, 11 |
| 90066002 | 7        |
| 90066003 | 7, 11    |
| 90066004 | 7, 11    |
| 90066005 | 7        |
| 90066006 | 7, 11    |
| 90066007 | 7        |
| 90066008 | 7        |
| 90066009 | 7, 9, 11 |
| 90066011 | 7        |
| 90066012 | 7, 9, 11 |
| 90066013 | 7, 9, 11 |
| 90066014 | 7, 9, 11 |
| 90066015 | 7, 9, 11 |
| 90066016 | 7, 11    |
| 90066017 | 7        |
| 90066018 | 7        |
| 90066019 | 7        |
| 90066020 | 7        |
| 90066021 | 7, 9     |
| 90066022 | 7        |
| 90066023 | 11       |
| 90066024 | 11       |
| 90066027 | 11       |
| 90066028 | 11       |
| 90066029 | 11       |
| 90070000 | 5, 7     |
| 90070001 | 5, 7, 11 |
| 90070002 | 5, 7, 11 |
| 90070003 | 5, 7, 11 |
| 90070004 | 5, 7, 11 |
| 90070005 | 5, 7     |
| 90070006 | 7, 11    |
| 90070007 | 7, 11    |
| 90070008 | 7, 11    |
| 90070009 | 7        |
| 90070010 | 7        |
| 90070011 | 7        |
| 90501539 | 5, 8, 12 |
| 90517255 | 9        |
| 90522440 | 5, 12    |
| 90522442 | 5, 12    |
| 90522444 | 5, 12    |
| 90522446 | 5, 12    |
| 90522819 | 5        |
| 90522822 | 5        |
| 90522823 | 5        |
| 90522825 | 5        |

| PART NO. | PAGE NO.        |
|----------|-----------------|
| 90531399 | 5               |
| 90531400 | 5               |
| 90531403 | 5               |
| 90531404 | 5               |
| 90531407 | 5               |
| 90531408 | 5               |
| 90531411 | 5               |
| 90531412 | 5               |
| 90549813 | 5               |
| 90549820 | 5               |
| 90549838 | 5               |
| 90549910 | 5, 9            |
| 90549983 | 5               |
| 90549985 | 5               |
| 90550180 | 8               |
| 90550181 | 8               |
| 90557417 | 5               |
| 90566000 | 5, 12           |
| 90566001 | 5               |
| 90566002 | 5               |
| 90566003 | 5               |
| 90570000 | 5               |
| 90570004 | 5               |
| 90570005 | 5               |
| 90570009 | 7               |
| 90570010 | 7               |
| 90570011 | 7               |
| 93002459 | 5, 8, 12        |
| 93002463 | 5, 7, 11        |
| 93002573 | 5               |
| 93002907 | 5               |
| 93002937 | 5               |
| 93003347 | 8               |
| 93003348 | 5               |
| 93003569 | 5               |
| 93003609 | 5               |
| 93003617 | 5, 9            |
| 93003659 | 5               |
| 93003671 | 5, 8, 9         |
| 93003671 | 12              |
| 93003743 | 5, 8            |
| 93006046 | 5, 12           |
| 93400271 | 5, 9            |
| 93400480 | 5               |
| 93400490 | 8               |
| 93400491 | 5               |
| 93400494 | 5, 8, 9, 12     |
| 93400631 | 5, 9            |
| 93600043 | 5, 7, 8, 11, 12 |

| PART NO.           | PAGE NO.    |
|--------------------|-------------|
| 93600045           | 5           |
| 93600049           | 5           |
| 93600138           | 5           |
| 93600156           | 5, 8, 9, 12 |
| 93600168           | 10          |
| 93600555           | 5, 8        |
| 93600566           | 5, 8, 9     |
| 93600567           | 5, 8, 12    |
| 93800229           | 5, 8        |
| 93800338           | 5           |
| 93800339           | 5           |
| 96003659           | 8, 9        |
| 04247301201Z       | 7, 11       |
| LSZ1310            | 13          |
| LSZ1313            | 13          |
| XB-02967           | 8, 9        |
| XL-AR356-01        | 7           |
| XL-PS20006DC-en-US | 7           |



From fifth wheel rebuild kits to suspension bushing repair kits, SAF-HOLLAND Original Parts are the same quality components used in the original component assembly.

SAF-HOLLAND Original Parts are tested and designed to provide maximum performance and durability. Will-fits, look-alikes or worse yet counterfeit parts will only limit the performance potential and could possibly void SAF-HOLLAND's warranty. Always be sure to spec SAF-HOLLAND Original Parts when servicing your SAF-HOLLAND product.

**SAF-HOLLAND USA • 800.876.3929 • Fax 800.356.3929**

[www.safholland.us](http://www.safholland.us)

**SAF-HOLLAND CANADA • 519.537.3494 • Fax 800.565.7753**

**WESTERN CANADA • 604.574.7491 • Fax 604.574.0244**

[www.safholland.ca](http://www.safholland.ca)

**SAF-HOLLAND MEXICO • +(52) 55.5362.8743 • Fax +(52) 55.5362.8743**

[www.safholland.com.mx](http://www.safholland.com.mx)

[info@safholland.com](mailto:info@safholland.com)