



LANDING GEAR

SERVICE BULLETIN



LGE Series

Replacement of Gearbox Cover

February 27th 2003



All maintenance must be performed by a qualified person using proper tools and safety procedures. Before replacing the gearbox cover you must read and understand the following procedure

GENERAL

This bulletin describes the correct procedure for replacement of the gearbox cover on the LGE series landing gear.

PROCEDURE

1. Remove all paint, deposits, etc. from crank (handle) shaft and lubricate shaft for easier removal of the gearbox cover.
2. Remove gearbox cover (3) by removing bolts (5) using caution to prevent tearing or breaking the gasket.

Note: When removing cover apply inward pressure to the crankshaft in order to prevent the shaft sliding out or the inner bush and the detent ball and spring shooting out.

3. It is possible that during removal of the cover the idler gear shaft (10) may come out with the cover also removing or misaligning idler (9) and step gear (11). If this occurs position the step gear (11) in line with the rear bush for the idler gear shaft (10) and push the shaft through the gear and onto the bush. Idler gear (9) can then be slid onto the shaft with the shoulder of the gear to the inside.
4. In the event that the crankshaft does move out far enough for the detent ball and spring to come out these can be refitted by putting spring (14) into the hole provided in the shaft, placing the ball (15) on top of the spring and pushing the ball down against the spring with your thumb while pushing the shaft inwards with your other hand. Ensure that the ball is fully captured by the rear bush and that the shaft is fully in (low gear position) before refitting the gearbox cover.
5. Re-pack gearbox with grease if required. The gearbox should contain a minimum of 0.5 kg of water resistant lithium base grease - EP2.
6. Position gasket, refit cover and secure with bolts, ensuring that the gasket is correctly positioned.

COVER REMOVAL

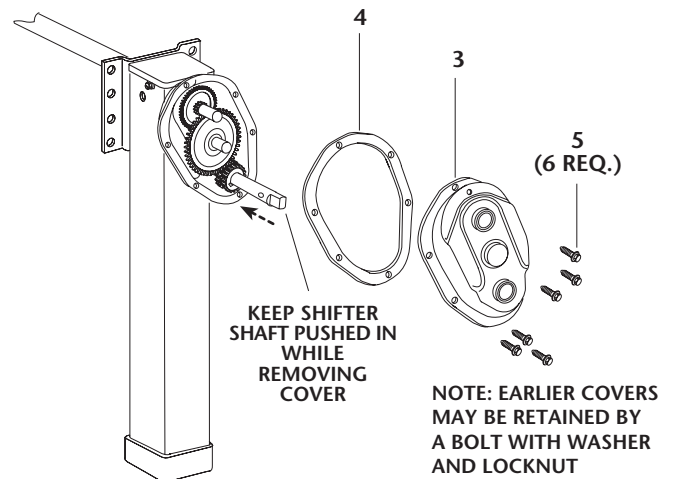

ARRANGEMENT OF GEARS

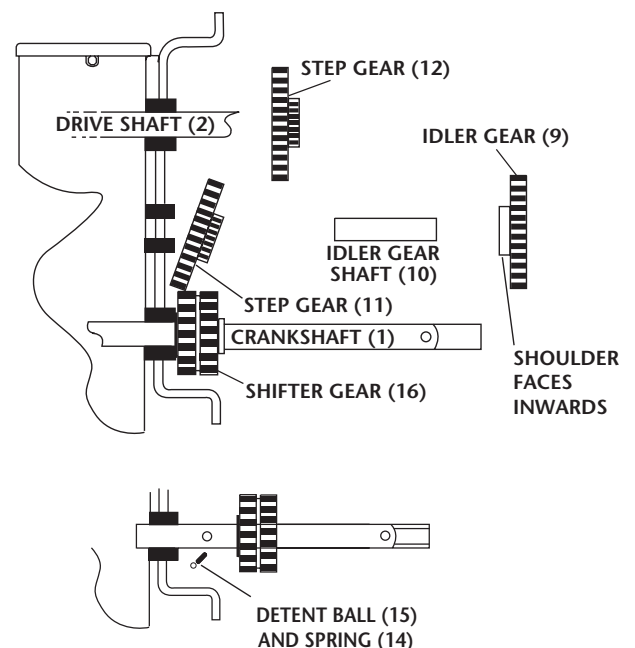

For further assistance in identifying gears, etc. see parts explosion on spares sheet XL-LG1029-03



Copyright © June 2004 • The Holland Group Inc.



The Holland Group, Inc.
Holland, MI 49423
United States
Phone: (616) 396-6501
Fax: (616) 396-1511

EN ISO
9001:2000



DNV
Certified
Company

Holland Europe GmbH

Altenkamp 9
D-33758
Schloss Holte-Stukenbrock
Germany

Phone: +49 (0) 5207-89560
Fax: +49 (0) 5207-895656

Holland Eurohitch Ltd.

Hoo Farm Industrial Estate
Worcester Road
Kidderminster
Worcestershire
DY11 7RA

Phone: +44 (0) 1562-732010
Fax: +44 (0) 1562-732020

Holland Hitch (Aust.) Pty. Ltd.

Melton, Victoria, Australia
Phone: 61-(0)3-9743-6799
Fax: 61-(0)3-9747-9617

Holland Transtrade

(Thailand) Company, Ltd.
Bangkok, Thailand
Phone: 66 (0)2-513-8758
Fax: 66 (0)2-513-8757

Nippon Holland, Ltd.

Tokyo, Japan
Phone: 81-(0)3-3461-9130
Fax: 81-(0)3-3463-1407

Holland Transtrade

Far East SDN BHD
Shah Alam, Malaysia
Phone: 60 (0)3 734-2888
Fax: 60 (0)3 736-5588