



FIFTH WHEELS

INSTALLATION AND ADJUSTMENT INSTRUCTIONS



Lock Guard Kit RK-05327 for FW1226 & FW1226-1 Top Plates

INSTALLATION:

1. Pull the release handle and pry open the locks.
2. Remove the old lock guard and lock guard parts. If your fifth wheel is not already equipped with a lock guard, follow the instructions on the reverse to install the lock guard bracket (XA-3601-31) on the fifth wheel casting. After installation of the bracket, follow the following steps below.
3. Assemble the lock guard, XA-02039 and torsion spring XB-1044 (see *Figure 1*).
4. Mount the lock guard into place, using the pivot shaft XA-1055 and two XB-16 cotter pins.
5. Check adjustment. When properly adjusted, the center of the hinged lock must contact the lock guard when attempting to swing it closed (see *Figure 2*). If the lock guard is not contacting the center, adjust it by bending it slightly.
6. Lubricate all moving parts with a light oil.

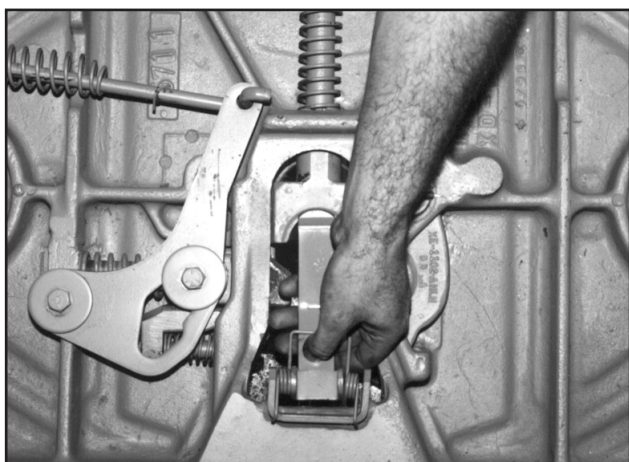

Figure 1

CHECK FIFTH WHEEL OPERATION:

As a final check of the installation, close the locks using a Holland Lock Tester. Verify that the locking mechanism functions properly. Refer to Holland publication XL-FW130 for specific details on how to operate the tester.

NOTE: IF TOP PLATE DOES NOT OPERATE PROPERLY, DO NOT USE IT! Refer to Holland publication XL-FW242, Rebuilding Procedures for FW1226 Series Fifth Wheel Top Plates or contact your local Holland representative for assistance.

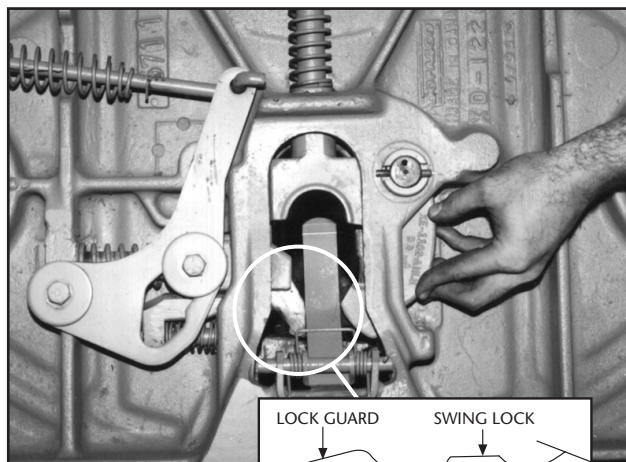
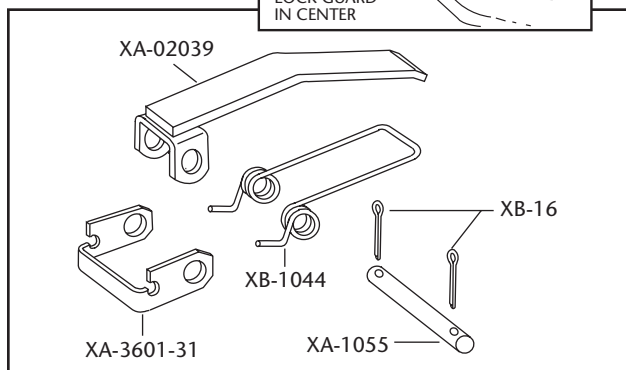
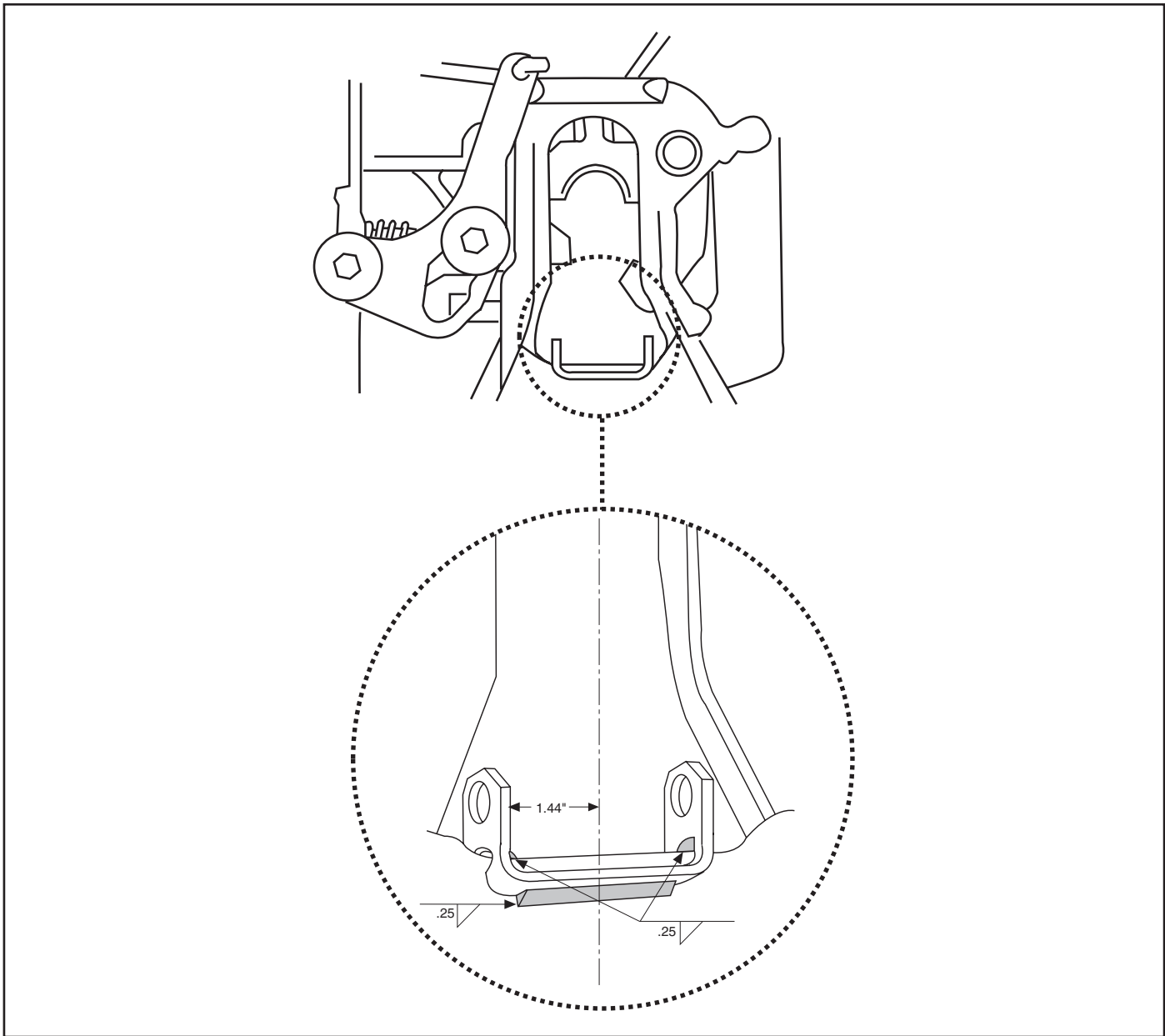

Figure 2



XA-3601-31 WELDING INSTRUCTIONS



WARNING

When welding use a procedure which assures a sound, good quality weld and which protects the operator and others. Overwelding may cause distortion and damage and underwelding may not develop sufficient strength. A low hydrogen process and AWS E70XX filler metal are recommended. Take precautions to insure that the tractor electrical system is not damaged by the welding.

Copyright © September 2002 • The Holland Group, Inc.

Holland USA, Inc. Facilities:

Denmark, SC Warrenton, MO
Dumas, AR Whitehouse Station, NJ
Holland, MI Wylie, TX
Muskegon, MI

Ph: 888-396-6501 Fax: 800-356-3929

Holland International, Inc.

Holland, MI
Phone: 616-396-6501
Fax: 616-396-1511

Holland Hitch of Canada, Ltd.

Woodstock, Ontario • Canada
Phone: 519-537-3494
Fax: 800-565-7753

Holland Equipment, Ltd.

Norwich, Ontario • Canada
Phone: 519-863-3414
Fax: 519-863-2398

Holland Hitch Western, Ltd.

Surrey, British Columbia • Canada
Phone: 604-574-7491
Fax: 604-574-0244