



FIFTH WHEELS

INSTALLATION INSTRUCTIONS FOR RK-09557



FleetMaster Generation III (Left-Hand) Release Handle Kit



To complete the replacement procedures, the tractor must be uncoupled from the trailer and parked, with the engine turned off, in an area clear of other persons, vehicles, or obstacles.



This release handle replacement kit is intended **ONLY** for **LEFT-HAND** release Generation III (Gen. III) FleetMaster fifth wheels produced after September 1999.

Verify that your FleetMaster fifth wheel is a Gen. III by identifying the proper fifth wheel lock **AND** handle shown below. If your fifth wheel has a Gen. I or Gen. II lock or handle, **DO NOT USE THIS KIT!** Contact Holland for the proper kit part number.

RK-09557 COMPATIBILITY	LOCKS	HANDLES
GEN. I		
GEN. II		
GEN. III		

GENERAL INFORMATION:

1. All fifth wheel maintenance, adjustment and rebuilding must be performed by a qualified person using proper tools and safe practices.
2. Do not modify or add to the product.
3. Always wear safety goggles and never strike any part with a steel hammer.
4. Do not weld on this product.
5. Observe standard safety precautions at all times.
6. Use only genuine Holland parts.
7. Do not deviate from these instructions. Refer to Holland publication XL-FW340 for Holland TF-TLN-5001 Lock Tester instructions.

REMOVAL AND REPLACEMENT PROCEDURES:

1. Remove the old cotter pin, washer, release handle, and spring and discard. Slide the new release handle through the left (driver) side release handle window (see Figure 1).

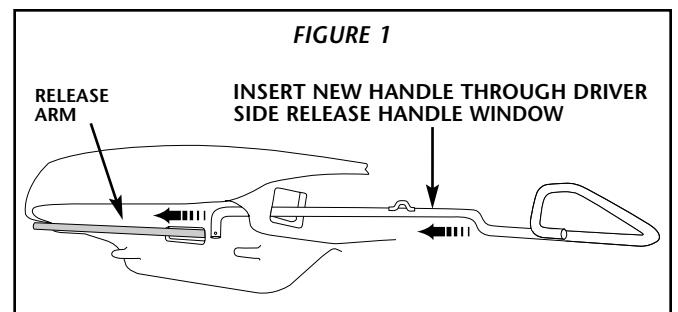
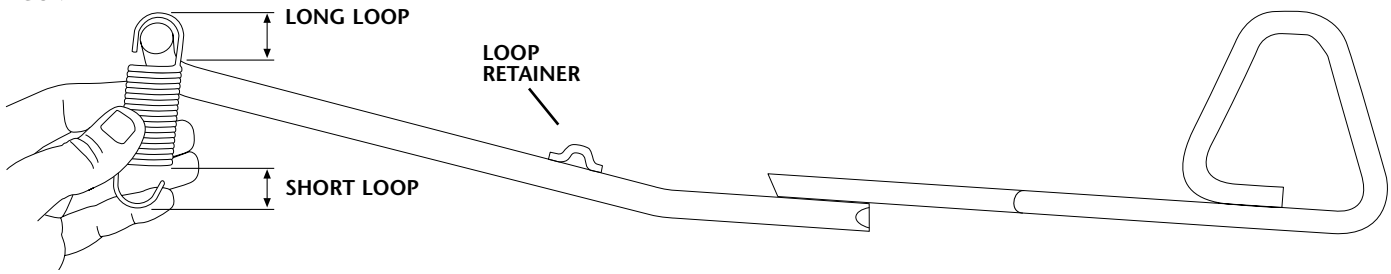

FIGURE 2



2. Install the new spring on the new handle. To do this, start by inserting the long loop end of the spring on the handle, as shown in Figure 2.

3. Slide the spring along the handle towards the loop retainer (see Figure 3). Rotate the spring on the handle so that the spring loop opening is aligned with the loop retainer (see Figure 4). Align the end of the spring loop with the loop retainer opening (see Figure 5). Rotate the spring to engage the spring end in the loop retainer (see Figure 6).

4. Hook the short loop down through the casting lug (see Figure 7)

5. Now, slide the bent end of the release handle down through the hole in the end of the release arm (see Figure 8).

6. Place a new washer over the end of the release handle and secure with the new cotter pin (Figure 8).

7. **IMPORTANT!** When completing the replacement procedures, check the operation of the fifth wheel by locking and unlocking the fifth wheel at least three times, using a Holland Lock Tester (part number TF-ILN-5001). Refer to Holland publication XL-FW354, "FleetMaster Fifth Wheel Maintenance Procedures," for other important routine maintenance and inspection requirements.

FIGURE 3

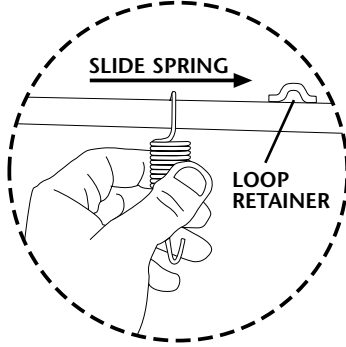

FIGURE 4

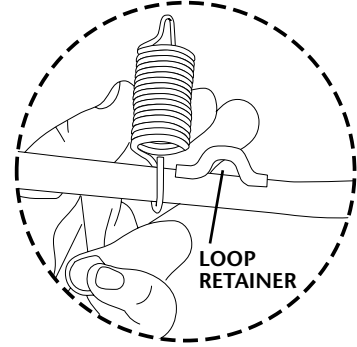

FIGURE 5

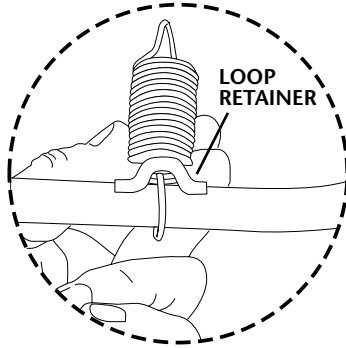

FIGURE 6

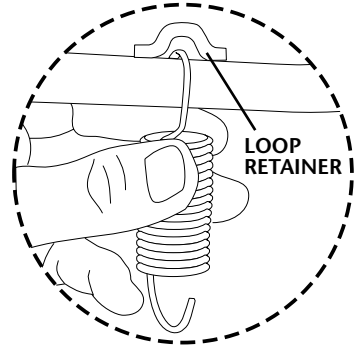

FIGURE 7

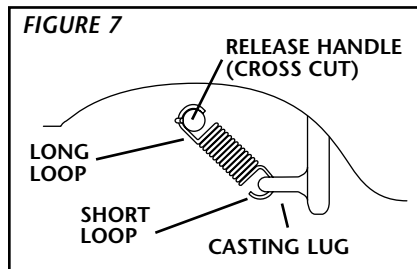
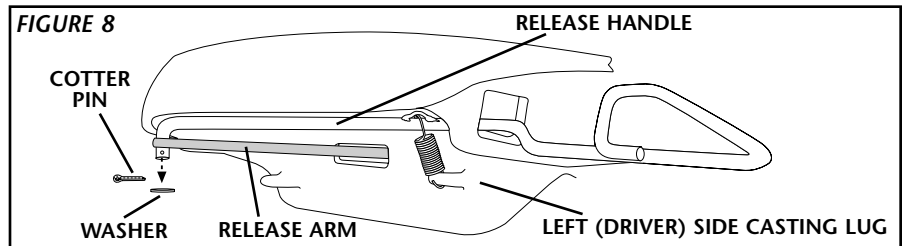

FIGURE 8



Copyright © August 1999 • The Holland Group, Inc.

Holland Hitch Company Divisions:

Holland, MI
Whitehouse Station, NJ
Denmark, SC
Wylie, TX
Milpitas, CA
Phone: 888-396-6501
Fax: 800-769-3299

Holland Binkley Co.

Warrenton, MO
Phone: 636-456-3455
Fax: 636-456-6792

Holland Binkley Co. Axle Products Division

Delphos, OH
Phone: 419-692-6015
Fax: 419-692-0503

Holland Neway International, Inc.

Muskegon, MI
Phone: 231-773-3271
Fax: 231-766-3893

Holland International, Inc.

Holland, MI
Phone: 616-396-6501
Fax: 616-396-1511

Holland Hitch of Canada, Ltd.

Woodstock, Ontario • Canada
Phone: 519-537-3494
Fax: 800-565-7753

Holland Hitch Western, Ltd.

Surrey, British Columbia • Canada
Phone: 604-574-7491
Fax: 604-574-0244

Holland Equipment, Ltd.

Norwich, Ontario • Canada
Phone: 519-863-3414
Fax: 519-863-2398