

FW8 (XA-201) FIFTH WHEEL Trouble-Shooting Guide

Before proceeding, verify that your fifth wheel top plate is a XA-201 model by following the 3 steps below:

1

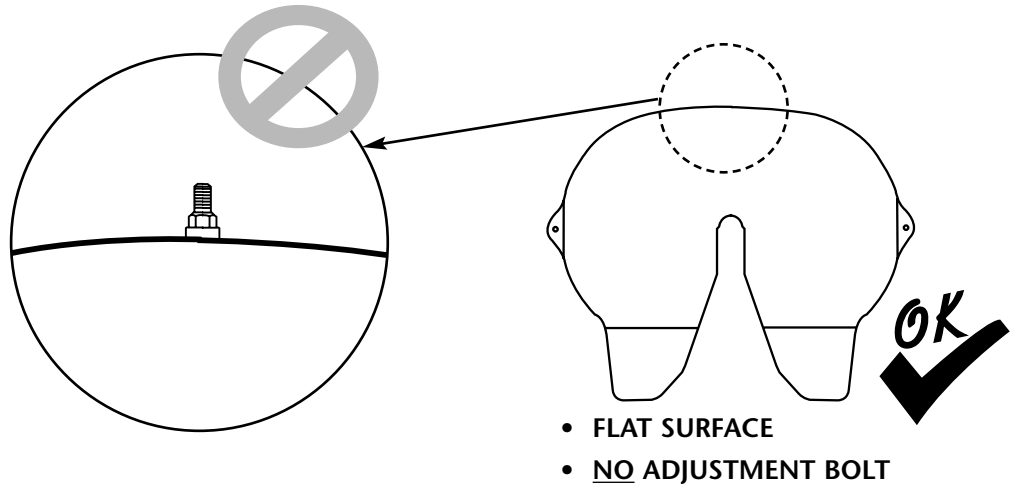

2

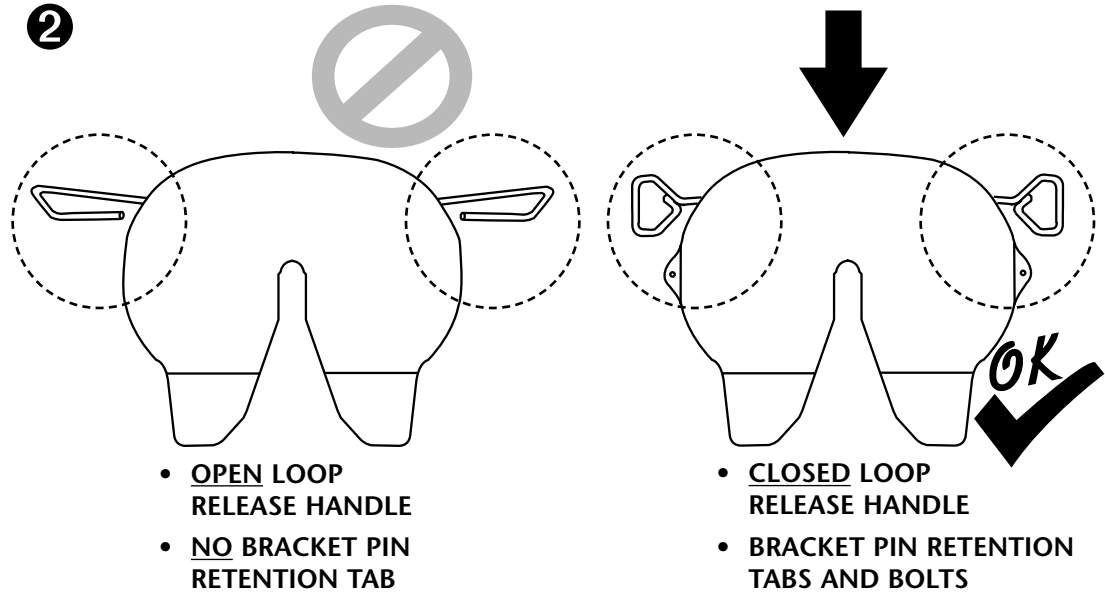

3

Serial Number Tag Identification

For this troubleshooting section, the part number on the serial number tag should begin with one of the following:

- **FW8**
- **XA-201**

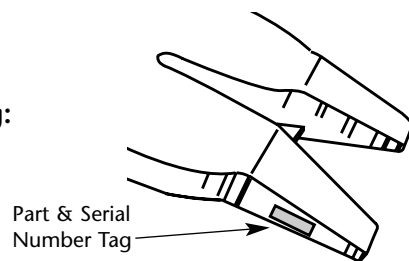



FW8 (XA-201) FIFTH WHEEL Trouble-Shooting Guide

TABLE OF CONTENTS

Difficult to uncouple from trailer 3 – 4

Difficult to couple to trailer 5 – 6

Movement within jaw 7

Hard steering or binding 7

FW8 (XA-201) exploded view 8

RIGHT HAND (CURBSIDE) RELEASE

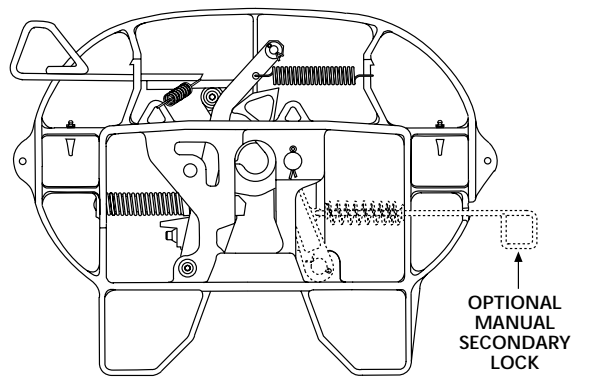

RK-201-A3 (Standard)
 RK-201-A3-02 (w/Manual Secondary Lock)

LEFT HAND (ROAD SIDE) RELEASE

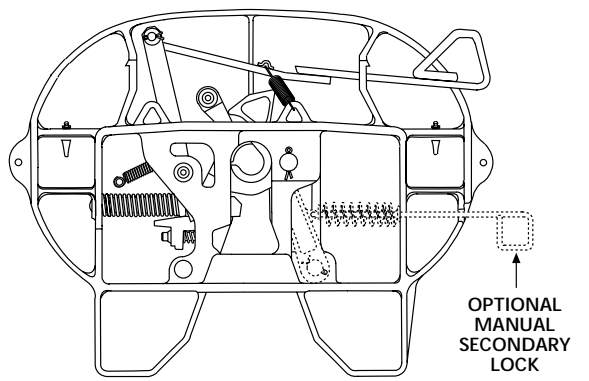

RK-201-A3-L (Standard)
 RK-201-A3-02-L (w/Manual Secondary Lock)



FW8 (XA-201) FIFTH WHEEL Trouble-Shooting Guide

PROBLEM: Difficult to uncouple from trailer

Cause

1. The primary release handle is not pulled out completely and hooked on the notch in the casting.

Remedy

1. Slide the primary release handle forward, then pull the handle out, slide it forward and hook it on the notch of the top plate casting, see *Figure 1*.

Figure 1

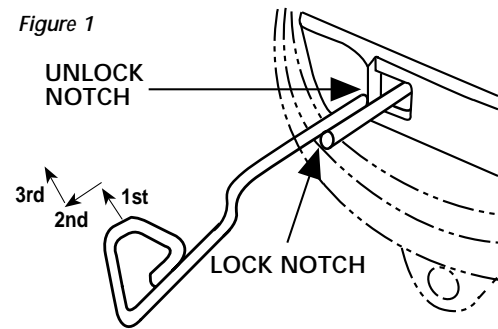

2. The tractor may be putting pressure against locks (pulling locks tight against kingpin).
3. Rust or grime build-up on locking mechanism.
4. Bent kingpin, damaged upper coupler plate or improper use of "lube plate."
5. Fifth wheel locks adjusted too tight.
6. Release handle will not stay out and must be held out to allow uncoupling.

2. Lock the trailer brakes, then back the tractor tight against the kingpin to relieve pressure on the locks. Lock the tractor brakes. Pull release handle.
3. Thoroughly steam clean the operating mechanism of the fifth wheel, then spray a light lubricant or apply a lightweight grease on all moving parts including the release handle and release handle spring. Operate several times to work in the lubricant. Follow recommended lubrication schedule as detailed in Service Bulletin #XL-SB31.
4. Check the kingpin and upper plate coupler as detailed in Holland Service Bulletin XL-SB20. Remove any improperly installed or improperly specified lube plates. Refer to Holland Service Bulletin XL-SB4 and XL-SB4a for lube plate warnings.
5. Re-adjust fifth wheel locks following the maintenance instructions included with your FW8 fifth wheel (Holland publication XL-FW-354).
6. Fifth wheel MUST be rebuilt. Obtain the proper rebuild kit for your model top plate.



FW8 (XA-201) FIFTH WHEEL Trouble-Shooting Guide

PROBLEM: Difficult to uncouple from trailer

- | | |
|---|--|
| <ul style="list-style-type: none">7. Bent release arm from improper coupling attempt.8. Other missing or damaged release system parts.9. Casting bent/damaged at throat area restricting movement.10. The optional manual secondary lock, if so equipped, is not released. | <ul style="list-style-type: none">7. Inspect for bent release arm. Rebuild fifth wheel with the proper Holland rebuild kit using all parts included in kit.8. Rebuild fifth wheel with the proper Holland rebuild kit using all parts included in kit.9. Replace entire fifth wheel.10. Pull out the manual secondary lock release handle, move it forward and secure it on the top plate casting, as shown in <i>Figure 2</i> below. |
|---|--|

Figure 2

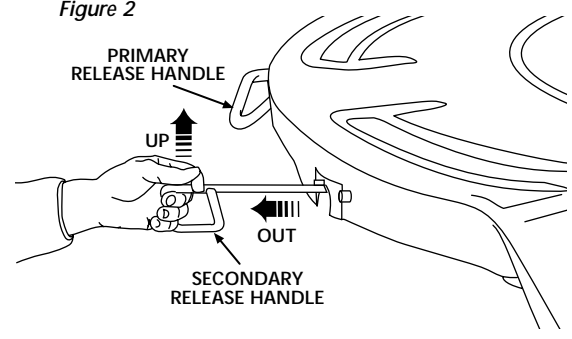



FW8 (XA-201) FIFTH WHEEL Trouble-Shooting Guide

PROBLEM: Difficult to couple to trailer

Cause

1. The trailer may be too high; the kingpin is not entering the locks properly.

Remedy

1. Chock trailer wheels. Then using **LOW GEAR**, lower the trailer landing gear until the bolster plate is aligned with the fifth wheel, as shown in *Figure 3*.

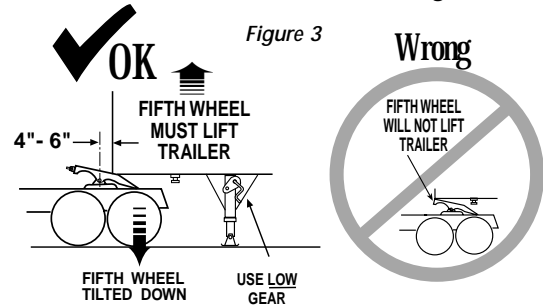

2. Locks are closed.

2. Make sure the locks are open. To open locks, slide the handle forward and pull it out to the maximum extension. The lock will swing to the open position (see *Figure 4*). If the lock does not open, hold the handle all the way out and use a pry bar to rotate the lock into the open position. Do not put your hands or fingers on or near the lock jaw.

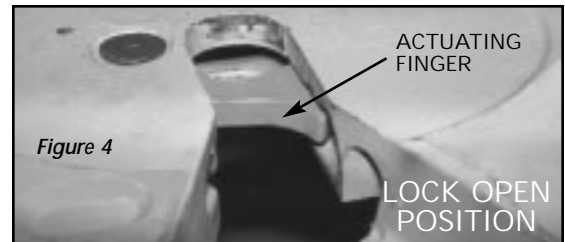

TO OPEN LOCK

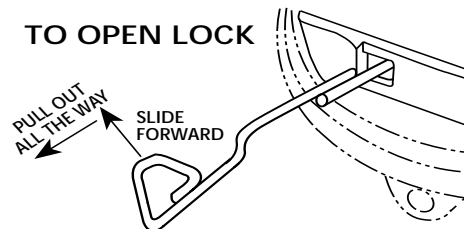

3. Excess accumulation of rust or grime is interfering with lock operation.

3. Thoroughly steam clean the fifth wheel then relubricate all moving parts, as described in Holland Service Bulletin XL-SB41. Operate several times to work in the lubricant. Follow recommended lubrication schedule as detailed in Service Bulletin XL-SB41.



FW8 (XA-201) FIFTH WHEEL Trouble-Shooting Guide

PROBLEM: Difficult to couple to trailer (con't.)

- | Cause | Remedy |
|--|---|
| 4. The primary release handle is not pulled out completely and hooked on the notch in the casting. | 4. Slide the primary release handle forward, pull the handle out, then slide it forward again and hook it on the notch of the top plate casting (see Figure 5). |

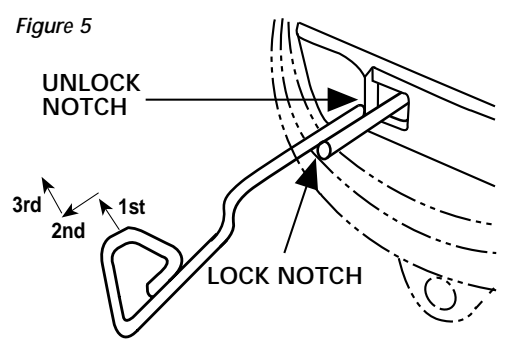

- | | |
|---|--|
| 5. Damaged, bent release handle. | 5. Replace release handle using proper release handle replacement kit for your model FleetMaster fifth wheel. Contact Holland for additional information. |
| 6. Bent kingpin, damaged upper coupler plate or improper use of "lube plate." | 6. Check the kingpin and upper plate coupler as detailed in Holland Service Bulletin XL-SB20. Remove any improperly installed or improperly specified lube plates. Refer to Holland Service Bulletin XL-SB4 and XL-SB4a for lube plate warnings. |
| 7. Attempting to couple too fast. | 7. Slowly back the tractor up to the trailer. Pick up the trailer with the fifth wheel. Stop. Then continue backing up until the fifth wheel locks firmly to the kingpin. Stopping helps prevent hitting the kingpin too hard. |

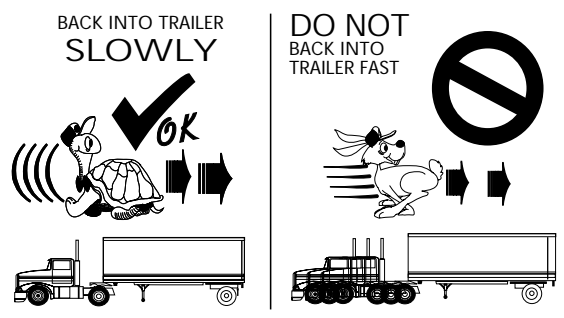



FW8 (XA-201) FIFTH WHEEL Trouble-Shooting Guide

PROBLEM: Excessive movement in the lock jaws

Cause	Remedy
1. Kingpin wear.	1. Check kingpin for acceptable wear with Holland TF-0110. Replace kingpin if necessary.
2. Fifth wheel out of adjustment.	2. Adjust fifth wheel following the procedures in the Lock Adjustment section of the maintenance instructions included with your fifth wheel (Holland publication XL-FW354).
3. Fifth wheel cannot be adjusted further.	3. Rebuild fifth wheel using proper rebuild kit.
4. Lock is on first step. (Generation III design only.)	4. If your fifth wheel is a Generation III style (manufactured after 9-1-99), the lock and plunger may be engaged <u>only</u> on the first step.

Check to see if the lock and plunger are properly engaged, as shown in *Figure 6* below. If they are only engaged on the first step, the fifth wheel must be re-adjusted, as described in the Lock Adjustment section of the maintenance instructions (XL-FW354, page 3).

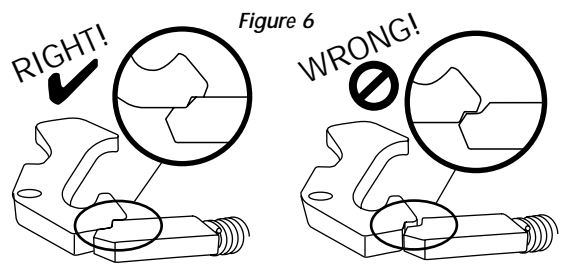

PROBLEM: Hard steering or binding

Cause	Remedy
1. Lack of lubrication on fifth wheel top surface.	1. Lubricate top of fifth wheel plate using a high pressure, lithium-based grease. Follow recommended lubrication schedule as described in Service Bulletin XL-SB41.
2. Warped trailer upper coupler plate.	2. Check upper coupler plate for flatness. Replace if necessary. (Refer to Service Bulletin XL-SB20 for additional information on upper coupler plate specifications.)



FW8 (XA-201) FIFTH WHEEL Trouble-Shooting Guide

GO THE DISTANCE.

Generation III parts shown

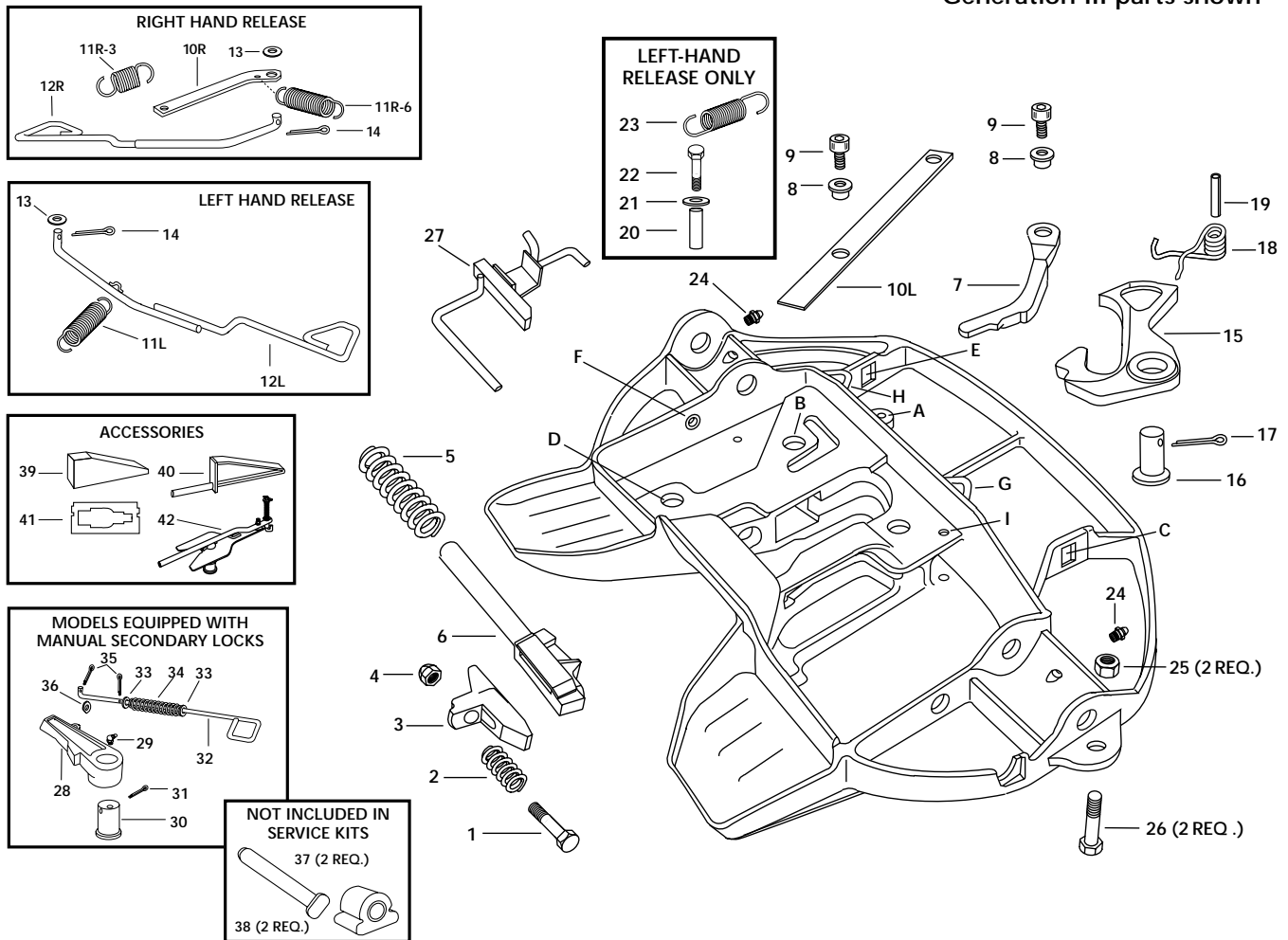

ITEM	PART NO.	NO.	PART NAME	ITEM	PART NO.	NO.	PART NAME
1	XB-06329-1	1	Hex hd. cap screw 5/8" -11 x 4.25"	20	XA-09558	1	Spacer
† 2	XB-09495	1	Spring	21	XB-1108	1	Washer
3	XD-06328	1	Adjusting wedge	22	XB-C-38-C-214	1	HHCS, 3/8" x 2.25"
4	XB-06179-2	1	Locknut 5/8" -11	23	XB-09517-1	1	Extension spring
5	XB-06330	1	Plunger spring	24	XB-H-38	2	Grease fitting
† 6	XA-09417-1	1	Locking plunger	25	XB-T-69-A	2	Locknut 1/2" -20
† 7	XE-09415	1	Cam arm	26	XB-C-95	2	Hex hd. cap screw 1/2" -20 x 1.25"
8	XA-08162	2	Roller	27	XA-09590	1	Wedge stop block
9	XB-08558	2	SHCS 1/2" -13 x .75"	* 28	XA-06349	1	Manual secondary lock arm
10R**	XA-09580	1	Right hand release arm	* 29	XB-767-C	1	45° grease fitting
10L**	XA-09514	1	Left hand release arm	* 30	XA-1016-C	1	Secondary lock pin
11R-3**	XB-09629	1	3" Extension spring	* 31	XB-5	1	Cotter pin .25" x 2" (same as #17)
11R-6**	XB-09581	1	6" Extension spring	* 32	XA-06345	1	Secondary lock release handle
† 11L**	XB-09408	1	Spring	* 33	XB-1204	2	7/16" washer
12R**	XA-09632	1	Right hand release handle	* 34	XB-1028-1	1	Spring
† 12L**	XA-09484	1	Left hand release handle	* 35	XB-06377	2	Cotter pin 1/8" x 1"
13	XB-T-199	1	5/8" washer	* 36	XB-PWC-38-78	1	Washer, 3/8" clipped
14	XB-06336	1	Cotter pin .19" x 1.25"	* 37	XE-06356	2	Bracket pin
† 15	XA-09416	1	Hinged lock	* 38	XB-0011-2	2	Rubber bushing
16	XA-06344	1	Lock pin	* 39	TF-TLN-08284	1	Helper block (wood)
17	XB-5	1	Cotter pin .25" x 2"	* 40	TF-TLN-4000	1	Helper block (steel)
18	XB-08764	1	Lock return spring	* 41	TF-0110	1	Kingpin gage
19	XB-21-S-500-2750	1	Roll pin	* 42	TF-TLN-5001	1	2" lock adjustment tool

* Not included in Rebuild Kit

† These parts must be installed as a complete set and cannot be ordered individually

** Not available individually; contact local Holland representative for correct handle kit.