



# COUPLER PRODUCTS

## LATCH REPLACEMENT PROCEDURES



**RK-76-A**

**For PH-75**

1. Remove and discard the nut, pivot bolt, and latch assembly.

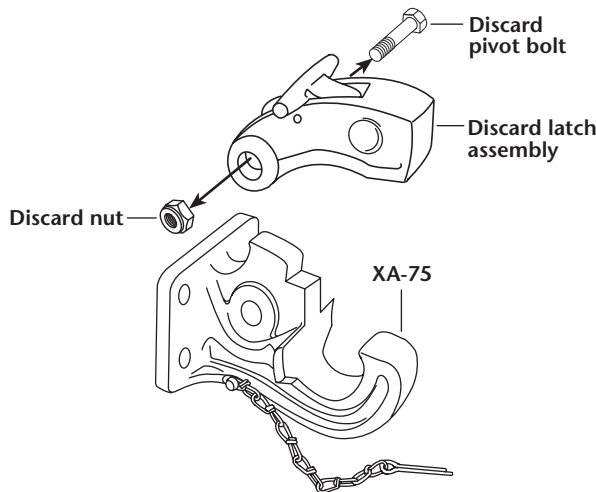

2. Apply Never-Seez® to entire shaft of the new pivot bolt (not on threads).

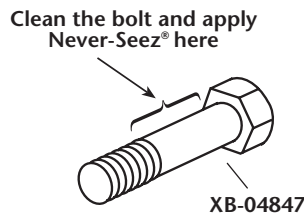

3. Install the new latch assembly using a new pivot bolt, and nut. Torque the nut to 30-75 ft-lbs.

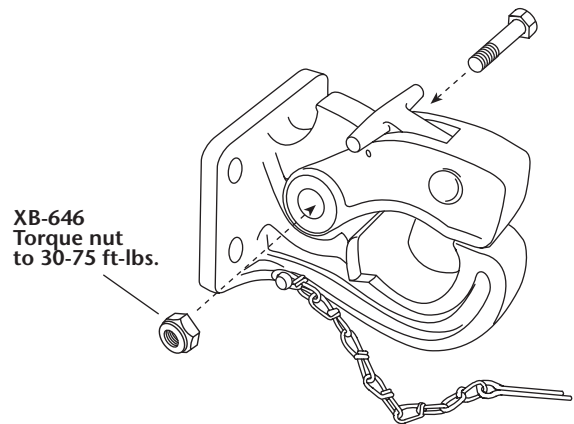

4. Check the latch for proper operation. When closed, the lock must be fully down. Install the cotter pin into the hole in the side of the latch, as shown. Spread the cotter pin to secure it in the latch.

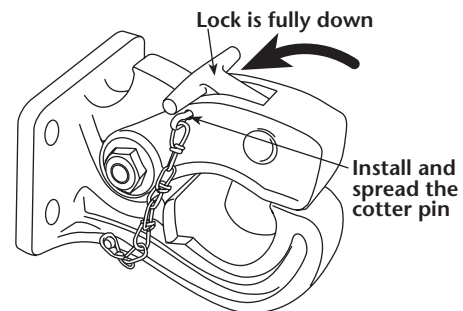

Copyright © April 2002 • The Holland Group, Inc.

**Holland USA, Inc. Facilities:**

Denmark, SC Muskegon, MI  
Dumas, AR Warrenton, MO  
Holland, MI Whitehouse Station, NJ  
Milpitas, CA Wylie, TX

Ph: 888-396-6501 Fax: 800-356-3929

**Holland International, Inc.**

Holland, MI  
Phone: 616-396-6501  
Fax: 616-396-1511

**Holland Hitch of Canada, Ltd.**

Woodstock, Ontario • Canada  
Phone: 519-537-3494  
Fax: 800-565-7753

**Holland Equipment, Ltd.**

Norwich, Ontario • Canada  
Phone: 519-863-3414  
Fax: 519-863-2398

**Holland Hitch Western, Ltd.**

Surrey, British Columbia • Canada  
Phone: 604-574-7491  
Fax: 604-574-0244