



COUPLER PRODUCTS

LATCH REPLACEMENT PROCEDURES



RK-764-5A

For PH-775-01552 and PH-775-D

1. Remove and save the nut and pivot bolt. Discard the cotter pin, S link and latch assembly.

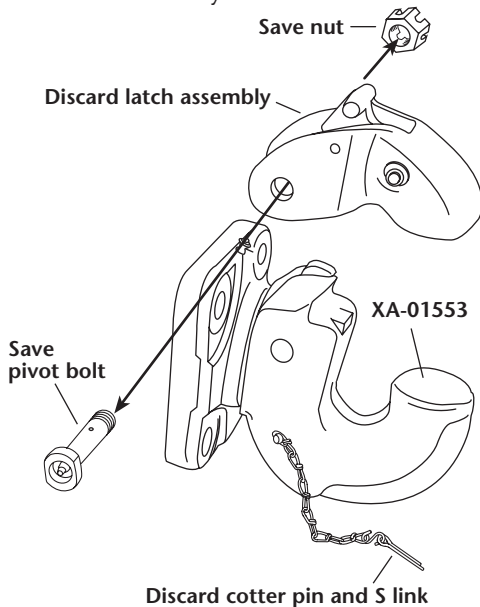

2. Clean and grease the ports in the old pivot bolt. Apply Never-Seez® to the entire shaft of the pivot bolt (not on threads).

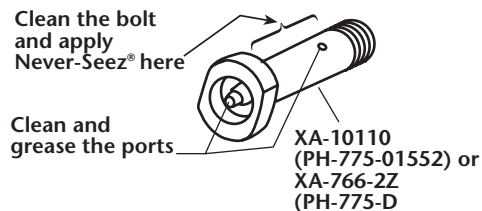

3. Install the new latch assembly using the old pivot bolt and nut.

Torque Specifications:

For PH-775-01552: Torque the lock nut (XB-10089) to 75-100 ft-lbs.

For PH-775-D:

Torque the slotted nut (XB-120-2) to 75-100 ft-lbs. Then, install the smaller cotter pin (XB-E-552-1) through the slotted nut and the hole in the bolt. Spread the cotter pin to secure.

Install a new cotter pin on the end of the chain with the S link. Crimp to secure it.

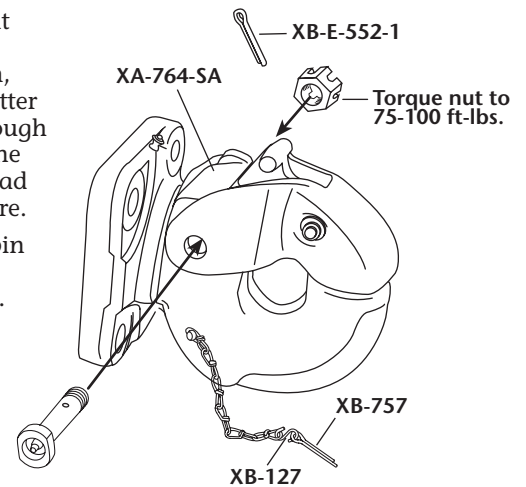

4. Check the latch for proper operation. It should open and close freely. When closed, the lock must be fully down. Install the cotter pin into the hole in the side of the latch, as shown. Spread the cotter pin to secure it in the latch.

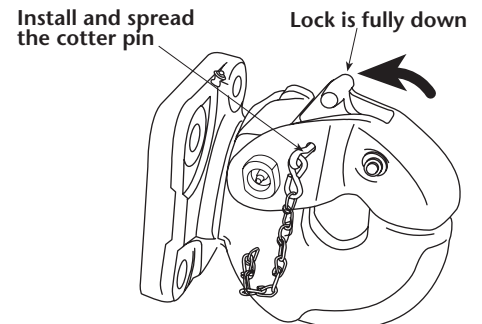

Copyright © April 2002 • The Holland Group, Inc.

Holland USA, Inc. Facilities:
 Denmark, SC Muskegon, MI
 Dumas, AR Warrenton, MO
 Holland, MI Whitehouse Station, NJ
 Milpitas, CA Wylie, TX
 Ph: 888-396-6501 Fax: 800-356-3929

Holland International, Inc.
 Holland, MI
 Phone: 616-396-6501
 Fax: 616-396-1511

Holland Hitch of Canada, Ltd.
 Woodstock, Ontario • Canada
 Phone: 519-537-3494
 Fax: 800-565-7753

Holland Equipment, Ltd.
 Norwich, Ontario • Canada
 Phone: 519-863-3414
 Fax: 519-863-2398

Holland Hitch Western, Ltd.
 Surrey, British Columbia • Canada
 Phone: 604-574-7491
 Fax: 604-574-0244