



E-HITCH

HITCH PIN REPLACEMENT PROCEDURE



**EH-20/EH-40/EH-60 Series
(EH-20RP11 shown)**

IMPORTANT SAFETY INFORMATION

1. Do not modify or add to the product.
2. Wear safety goggles during installation and removal.
3. Never strike any part of the item with a steel hammer.
4. Do not weld on this product.
5. Maintain adequate vertical (tongue) load to adequately control the trailer (generally 10%), but do not exceed the capacity ratings at right.
6. This equipment must not be used or maintained in a careless manner. The potential exists for the drawbar to separate from the E-Hitch. People could be injured and property could be damaged.

GENERAL INFORMATION

These products are covered by Holland's Commercial Products Warranty. Holland reserves the right, without giving prior notice, to change specifications and dimensions as designs are altered or improved.

INSTALLATION INSTRUCTIONS

- 1 Check kit for contents. Kit should have one (1) hitch pin, one (1) spring, one (1) roll pin, and two (2) zip ties (one zip tie is a spare).
- 2 Remove roll pin with a hammer and punch. Remove old hitch pin and spring. Discard old hitch pin, spring and roll pin.
- 3 Use supplied zip ties to compress new spring approximately as show. A second zip tie is available if required.
- 4 Insert new spring and hitch pin as shown.
- 5 Install new roll pin and center it through hitch pin as shown. Cut and remove zip tie(s).

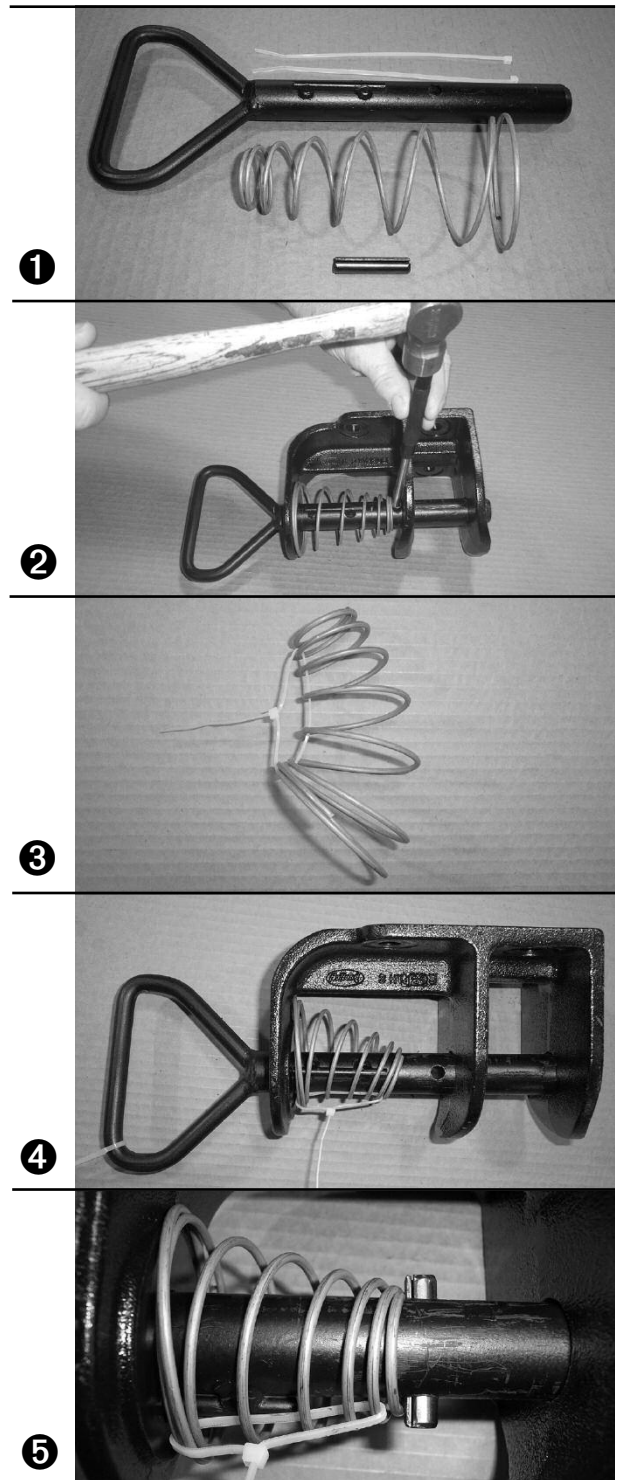

⚠ WARNING

DO NOT use E-Hitch with a bent hitch pin, broken spring, retaining roll pin or any other damage that will prevent E-Hitch from coupling properly. Using a damaged E-Hitch may result in death or serious injury from an unintended uncoupling during towing.

OPERATING INSTRUCTIONS

- A. Before operating inspect for proper operation, worn, damaged, or missing parts, and a secure mounting. Correct as required before use.
- B. To open the E-Hitch:
 1. Grasp and turn the handle (A) until the unlock bar (B) lines up with the key hole (C) in the top of the frame.
 2. Pull up on the handle until the unlock bar clears the top of the frame.
 3. Rotate the handle 90° so that the unlock bar can rest on top of the E-Hitch frame.
- C. Position the drawbar eye in the bottom opening (D) of the E-Hitch. Align the eye of the drawbar under the pin.
- D. To close, pull up slightly and rotate the handle until the unlock bar lines up with the keyhole in top of the frame. Release the handle to allow the pin to drop into place — locking the drawbar in the E-Hitch frame. Finally, turn the handle 180° and position the unlock bar at the back of the E-Hitch to ensure it remains engaged.

NOTE: For those who are using the remote operation (without either handle), there is no unlock bar (B).

MAINTENANCE:

For proper performance, every 3 months, perform the following:

- A. Clean and check for proper operation. Inspect for worn, damaged, or missing parts. Replace as required using only Holland parts.
- B. Inspect, in particular, the coupling contact area. Replace when wear exceeds 1/8" (.125") from the original surface profile of 1 1/8" diameter.
- C. Regularly lubricate all pivot points with a light oil lubricant.
- D. Check mounting fasteners for proper torque.

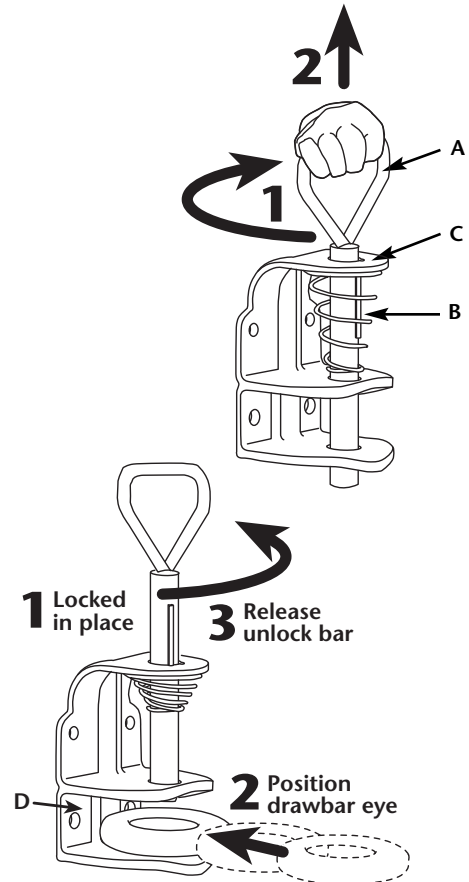

GO THE DISTANCE.

HOLLAND USA, INC.
 1950 Industrial Blvd. • P.O. Box 425 • Muskegon, MI 49443-0425
 Phone 888-396-6501 • Fax 800-356-3929
 www.thehollandgroupinc.com

Copyright © February 2005 • The Holland Group, Inc.

Holland USA, Inc. Facilities:

Dumas, AR Muskegon, MI
 Holland, MI Warrenton, MO
 Monroe, NC Wylie, TX

Ph: 888-396-6501 Fax: 800-356-3929

Holland International, Inc.

Holland, MI
 Phone: 616-396-6501
 Fax: 616-396-1511

Holland Hitch of Canada, Ltd.

Woodstock, Ontario • Canada
 Phone: 519-537-3494
 Fax: 800-565-7753

Holland Equipment, Ltd.

Norwich, Ontario • Canada
 Phone: 519-863-3414
 Fax: 519-863-2398

Holland Hitch of Canada, Ltd.

Surrey, British Columbia • Canada
 Phone: 604-574-7491
 Fax: 604-574-0244