



EZ-ALIGN SERVICE BULLETIN SERVICEABILITY



Trailer Air Suspensions

EZ-Align Identification - Old Style vs. New Style

January 21, 2002

NEW EZ-ALIGN PIVOT BOLT ASSEMBLIES AND ALIGNMENT COLLARS ARE NOT COMPATIBLE WITH EZ-ALIGN FRAME BRACKET COLLARS PRODUCED PRIOR TO MAY 1998.

The EZ-Align frame bracket collar design was simplified in May 1998 as a manufacturing improvement. The EZ-Align alignment block that is welded to the pivot bolt head and the mating alignment block with the D-shaped hole was reengineered in late 2001 to improve OEM assembly time and alignment. The new improved alignment block design has a protrusion that allows for easier assembly and alignment. The new components are currently being released into all NS, RL and RLU series air-ride suspensions as a running change.

IMPORTANT: When servicing the EZ-Align pivot connection of a Holland Neway trailer suspension, it is critical that the new EZ-Align pivot bolts and alignment blocks are not assembled to frame brackets with the old style (pre May 1998) alignment collars. The following instructions will assist in identifying old vs. new style components. To assure part compatibility, Service Repair Kits (SRKs) will only be sold with the old style components that can be used with either frame bracket configuration.

1. Visually check the alignment block/hex bolt assembly, alignment block and the frame bracket collars to identify the EZ-Align connection as either old or new style (FIG. 1, 1A & 1B).

OLD STYLE EZ-ALIGN COLLAR DESCRIPTION:

The old style frame bracket collar can be identified by an inner shelf inside the collar. This inner shelf will not allow the new style alignment blocks or alignment block/hex bolt assembly to mate properly (FIG. 1A & 4). The old style alignment block and alignment block/hex bolt assembly are shown in Figure 2, page 2.

NEW STYLE EZ-ALIGN COLLAR DESCRIPTION:

The new style frame bracket alignment collars do not have an inner shelf (FIG. 1B). The new style alignment block and alignment block/hex bolt assembly are shown in Figure 3, page 2. New style can be identified by a protrusion nose on the inside surface (FIG. 3) the old style alignment blocks **DO NOT** have this nose (FIG.2).

FIGURE 1: EZ-ALIGN PIVOT CONNECTION

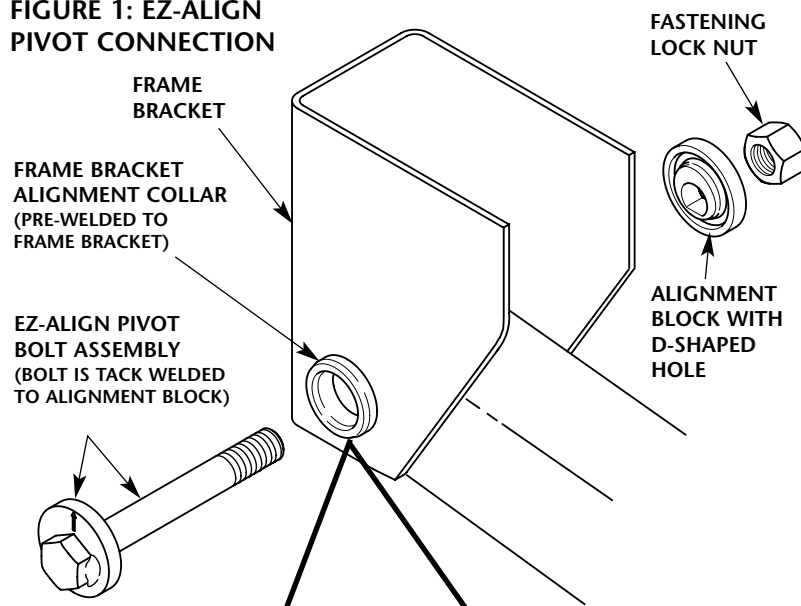
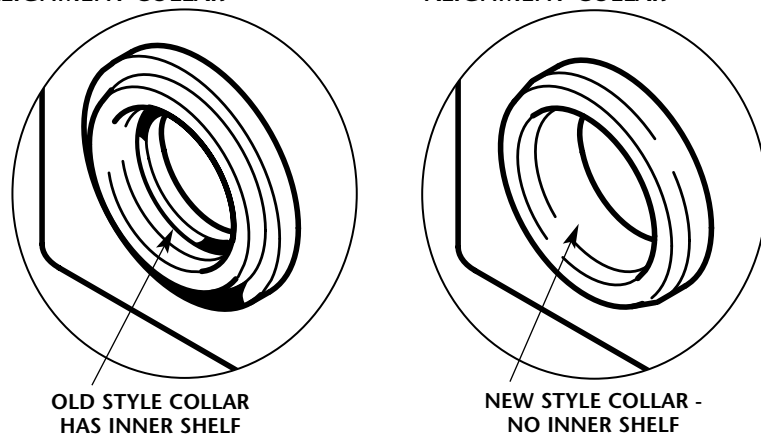

FIGURE 1A:
OLD STYLE FRAME BRACKET ALIGNMENT COLLAR

FIGURE 1B:
NEW STYLE FRAME BRACKET ALIGNMENT COLLAR



WARNING

Using new style EZ-Align alignment blocks or alignment block/hex bolt assembly with old style EZ-Align frame bracket alignment collars could allow the pivot connection to loosen. A loose pivot connection could cause damaged bushings and/or pivot bolts leading to suspension and/or trailer damage and potential loss of vehicle control.

DO NOT use new style EZ-Align alignment blocks or alignment block/hex bolt assembly with old style EZ-Align frame bracket alignment collars. They will not mate properly (FIG. 4).

FIGURE 4

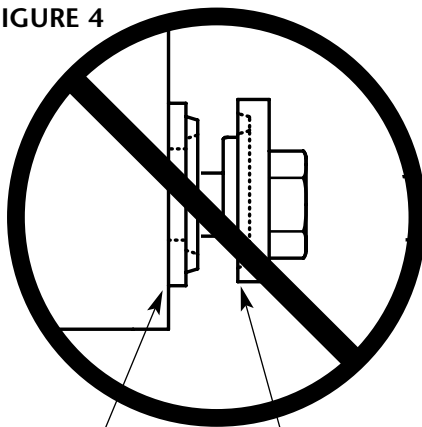

OLD STYLE FRAME BRACKET ALIGNMENT COLLARS

NEW STYLE EZ-ALIGN PIVOT BOLT ASSEMBLY

FIGURE 2: OLD STYLE EZ-ALIGN

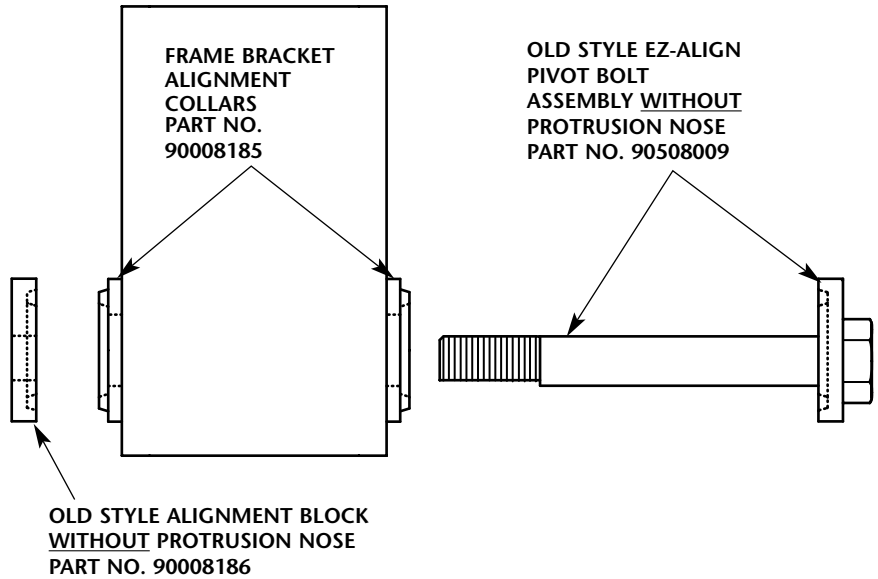
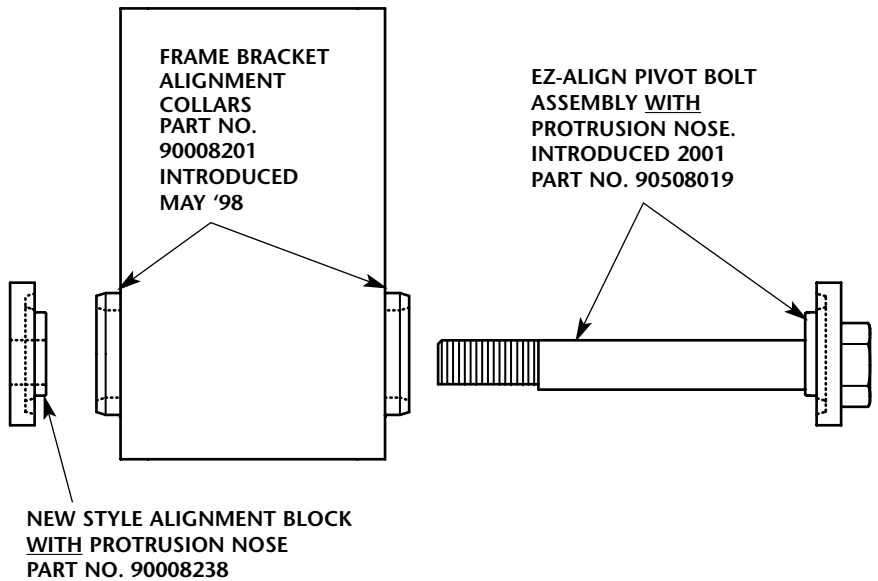

FIGURE 3: NEW STYLE EZ-ALIGN



HOLLAND USA, INC.
1950 Industrial Blvd. • Muskegon, MI 49443 • Phone 888-396-6501 • Fax 800-356-3929
www.thehollandgroupinc.com

Copyright © January 2002 • The Holland Group, Inc.

Holland USA, Inc. Facilities:

Denmark, SC Muskegon, MI
Dumas, AR Warrenton, MO
Holland, MI Whitehouse Station, NJ
Milpitas, CA Wylie, TX

Ph: 888-396-6501 Fax: 800-356-3929

Holland International, Inc.

Holland, MI
Phone: 616-396-6501
Fax: 616-396-1511

Holland Hitch of Canada, Ltd.

Woodstock, Ontario • Canada
Phone: 519-537-3494
Fax: 800-565-7753

Holland Equipment, Ltd.

Norwich, Ontario • Canada
Phone: 519-863-3414
Fax: 519-863-2398

Holland Hitch Western, Ltd.

Surrey, British Columbia • Canada
Phone: 604-574-7491
Fax: 604-574-0244