

# Installation Instructions

## 3500 LowLube Fifth Wheel

### RK-09559 Lube Tube Replacement for XA-331 Series Top Plates

This manual contains procedures to replace the lube tube on the XA-331 Series Low Lube Fifth Wheel Top Plate. To rebuild the fifth wheel top plate locking mechanism, refer to SAF-HOLLAND publication *XL-FW290-XX Rebuild Procedures for XA-351 and XA-331 Series Fifth Wheel Top Plates*. To replace the fifth wheel lube plates and pocket inserts, refer to SAF-HOLLAND publication *XL-FW338-XX Lube Plate and Pocket Insert Replacement for XA-331 Series Top Plates*.

FIGURE 1

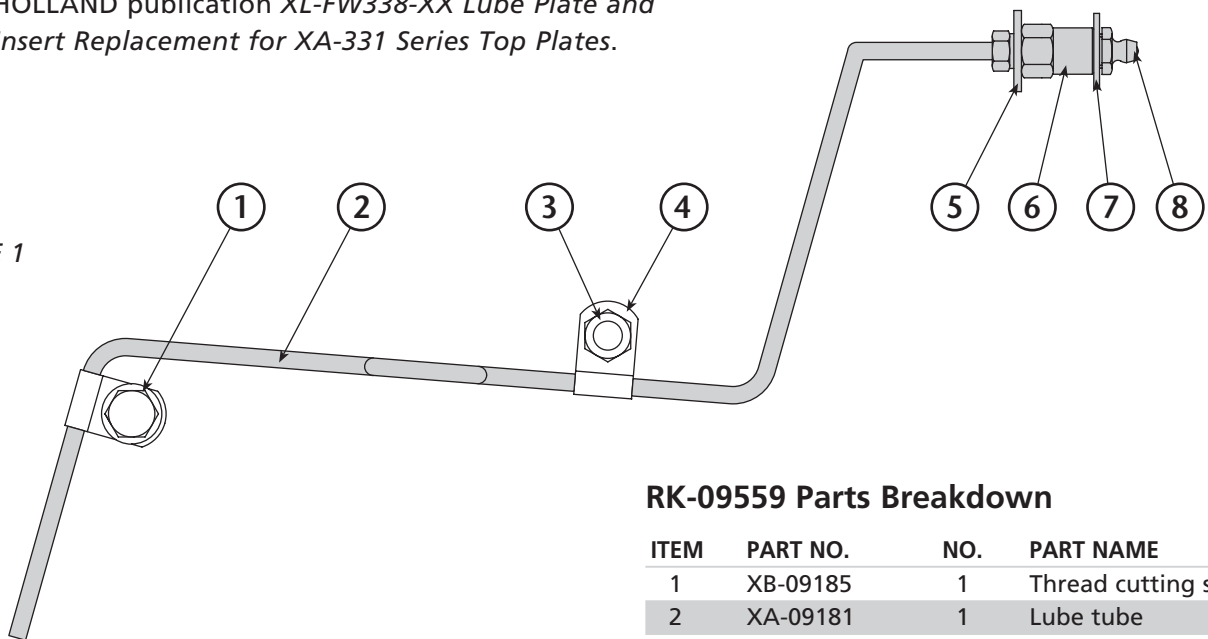

#### RK-09559 Parts Breakdown

| ITEM | PART NO.     | NO. | PART NAME                |
|------|--------------|-----|--------------------------|
| 1    | XB-09185     | 1   | Thread cutting screw     |
| 2    | XA-09181     | 1   | Lube tube                |
| 3    | XB-08931     | 1   | Lock nut 5/16"-18        |
| 4    | XB-09184-1   | 2   | Tube clip                |
| 5    | XB-05635     | 1   | Flat washer              |
| 6    | XB-09183     | 1   | Female connector fitting |
| 7    | XB-PWM-38-78 | 1   | Washer, 3/8"             |
| 8    | XB-H-38      | 1   | Lube fitting             |

**⚠ WARNING** Before attempting any repair procedures you must read and understand the following:

- **DO NOT** attempt to replace components on any XA-331 fifth wheel without following the instructions contained in this manual.
- **DO NOT** modify, change, or add to the product. Use only genuine SAF-HOLLAND parts.
- Perform all procedures in a lighted area clear of obstacles and other personnel.
- Always wear safety goggles during removal, installation, or service procedures.
- **DO NOT** strike any part of the product with a steel hammer.
- Observe standard precautions when lifting.
- Always verify proper operation and adjust the fifth wheel after performing any service procedures. Refer to SAF-HOLLAND publications *XL-FW307-XX* or *XL-FW309-XX*.

## Before Replacing the Lube Tube

Review the guidelines below. You may find that component replacement is unnecessary.

### Lube Tube Inspection

Thoroughly clean the lube tube and all connecting components. Replace the lube tube if:

1. Lube tube is crimped, broken, or damaged in any way.
2. Lube tube no longer has the ability to transfer grease to the locks.
3. Grease fittings no longer hold a tight seal.

FIGURE 2

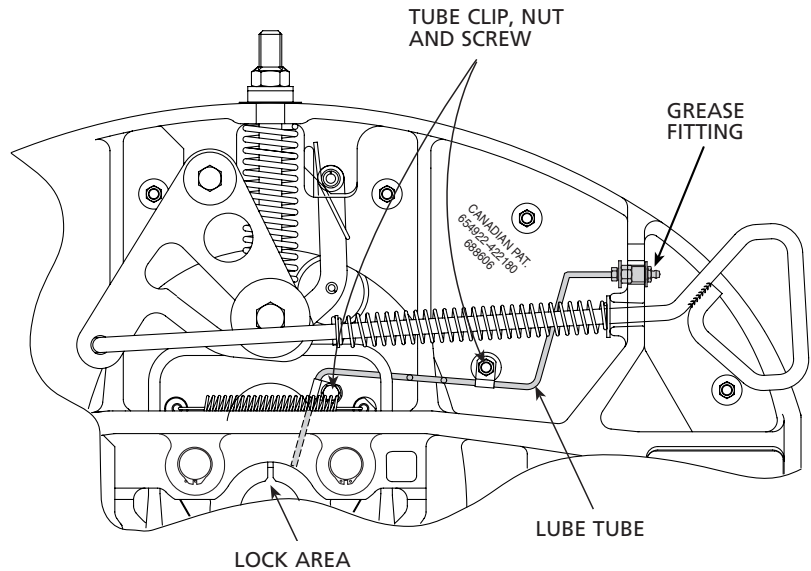

## Lube Tube Replacement

1. Remove the fifth wheel from the tractor.



**WARNING** The pocket insert may fall out while lifting and moving the fifth wheel.

2. Depending upon the condition of the fifth wheel, it may be beneficial to apply a rust dissolving penetrant to screws and nuts. Consult the manufacturer's instructions prior to disassembly. Remove and **discard** the screws and tube clips that secure the tube to the fifth wheel. (See **FIGURE 2** above.)

FIGURE 3

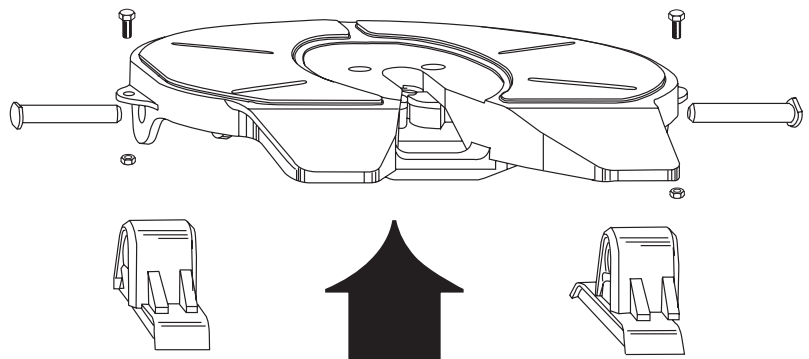

# Installation Instructions



SAF-HOLLAND Group

## Lube Tube Replacement *continued*

3. Remove the grease fittings and lube tube from the fifth wheel and **discard**.
4. Thoroughly clean and remove dirt, grease, debris, etc. from the top plate in the area where the lube tube is installed.

**FIGURE 4**

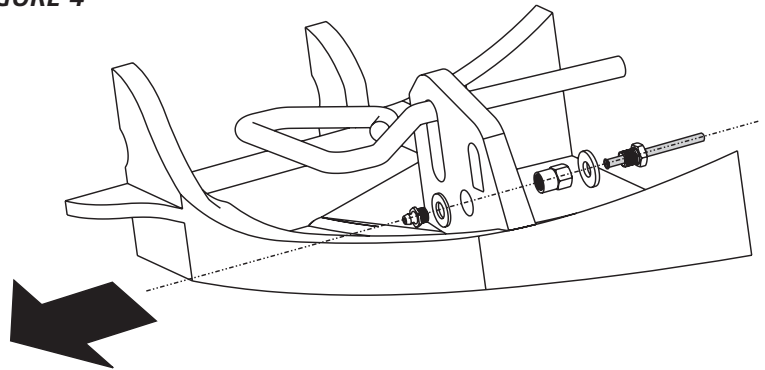

5. With the lube tube positioned vertically, insert the tube under the yoke and pull handle as shown in **FIGURE 5**. Slide the open end of the tube past the yoke and into the throat area of the fifth wheel.

**FIGURE 5**

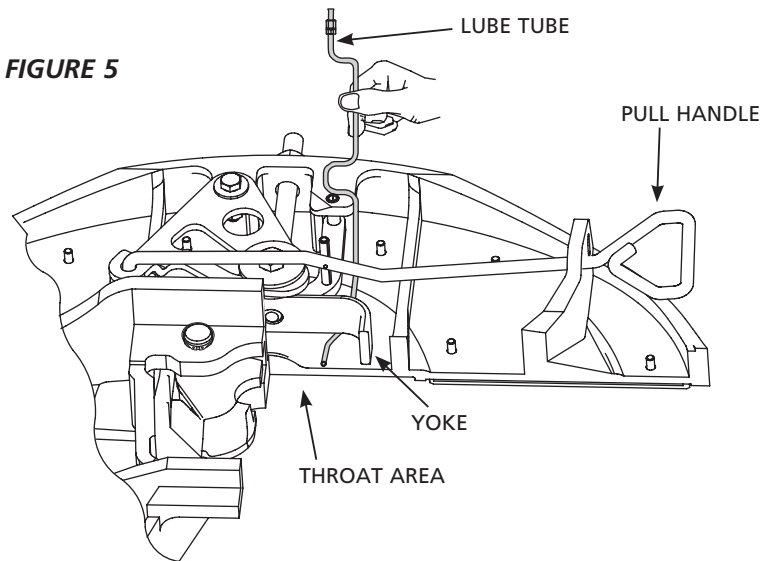

6. Rotate the lube tube down toward the side of the fifth wheel so that the bend in the tube fits over the casting rib.

**FIGURE 6**

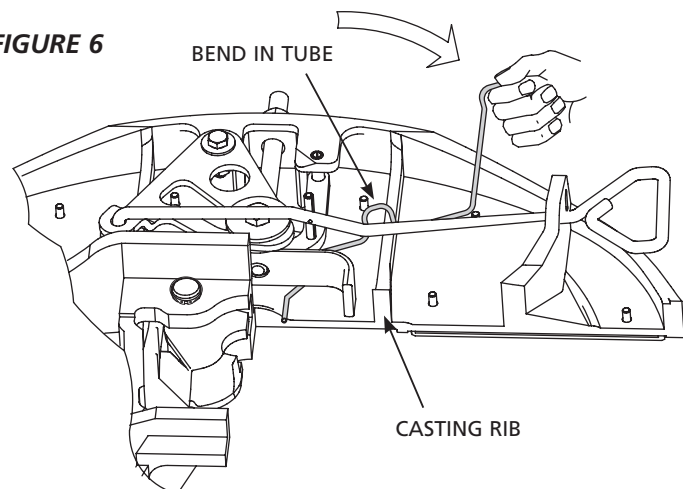

## Lube Tube Replacement *continued*

7. Position the lube tube so that the end of the tube and the hole in the rib line up.

FIGURE 7

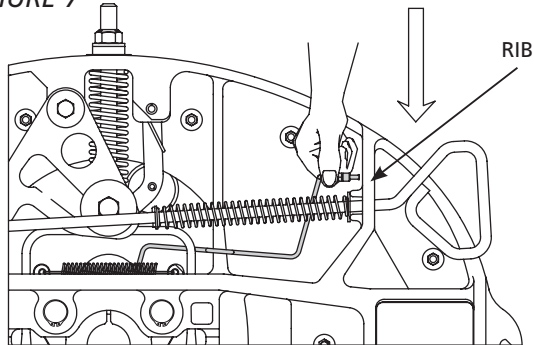

8. Attach fittings to the lube tube so that the rib is trapped between the two washers as shown.

FIGURE 8

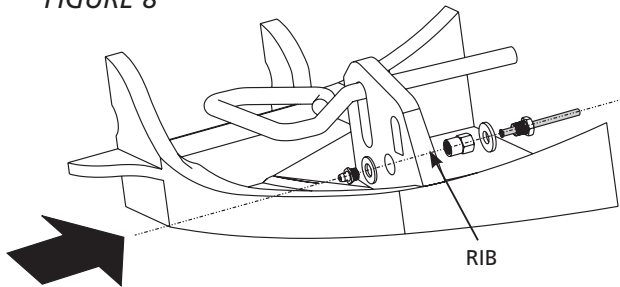

9. Place the end of the lube tube into the lock area with clearance between the locks and the tube. The tube must be flush with the top plate and positioned as shown in FIGURE 9, below.

FIGURE 9

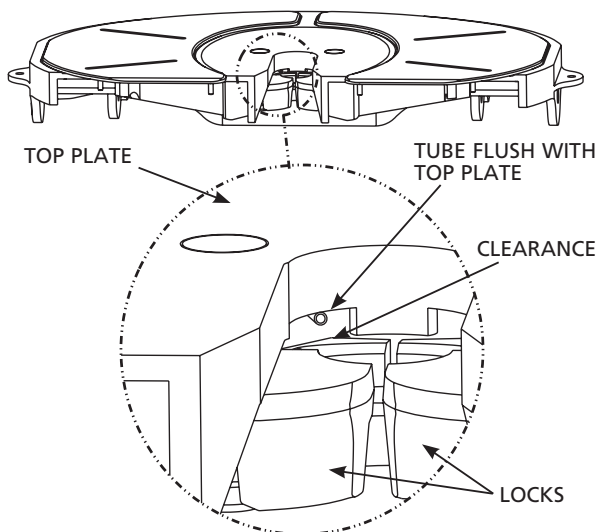

10. Clamp the lube tube down with the screws and tube clips as shown. Torque to 12ft.-lb. maximum.

FIGURE 10

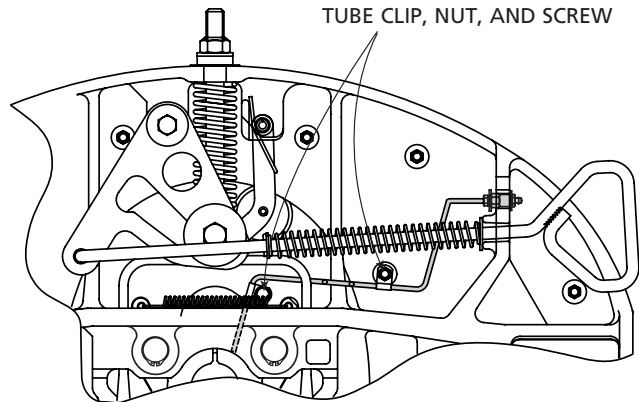

11. Reinstall the fifth wheel onto the tractor. Check for free and proper articulation. Make sure the fifth wheel does not bind.

FIGURE 11

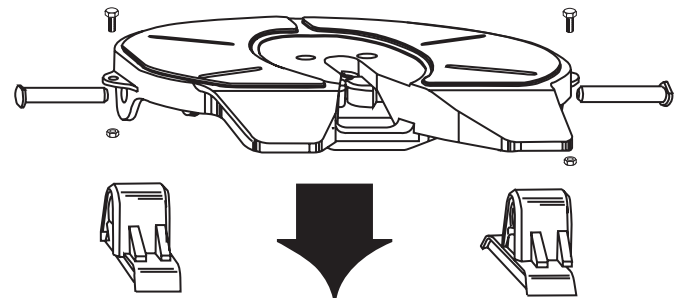

12. Check operation and adjustment of the fifth wheel.

Refer to Holland publications XL-FW307-XX (*LowLube Operating Instructions*) and XL-FW309-XX (*3500 LowLube Maintenance Procedures*).

Visit the Holland website at: [www.thehollandgroupinc.com](http://www.thehollandgroupinc.com) to obtain additional literature.