



# COUPLER PIVOT BOLT & NUT REPLACEMENT PROCEDURES

(PH-T-60-S10646 shown)



**RK-11133**

**For PH-T-60-S10646**

**This literature to be used for replacing worn or damaged latch pivot nut and bolt.**

1. Remove and discard the old nut, and old pivot bolt, while retaining the old latch assembly and old D-Pin and lanyard.

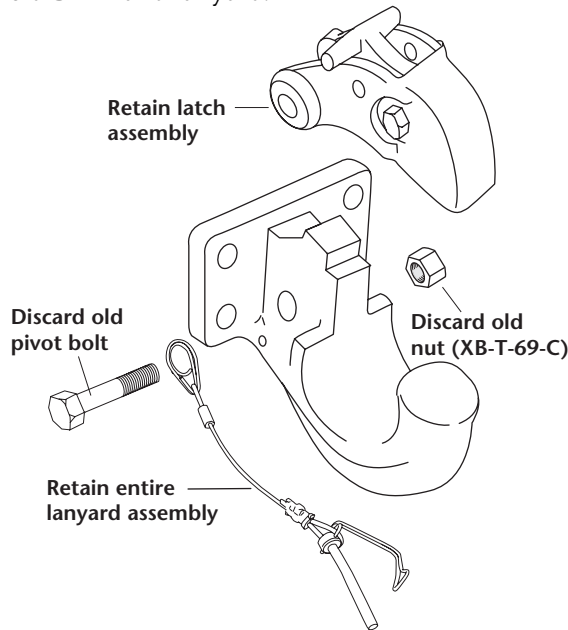

2. Apply Never-Seez®, or equivalent, to entire shaft of the new pivot bolt (not on threads).

Clean the bolt and apply Never-Seez®, or equivalent, here.

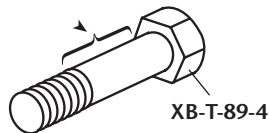

3. Install the old latch assembly using the new pivot bolt and lock nut provided. Tighten nut until it contacts the forged latch and then turn nut an additional 1/4 turn. Visually confirm that there is at least one full thread on the bolt protruding beyond the lock nut. If, during assembly, it becomes necessary to remove the lock nut, discard, and use second nut.

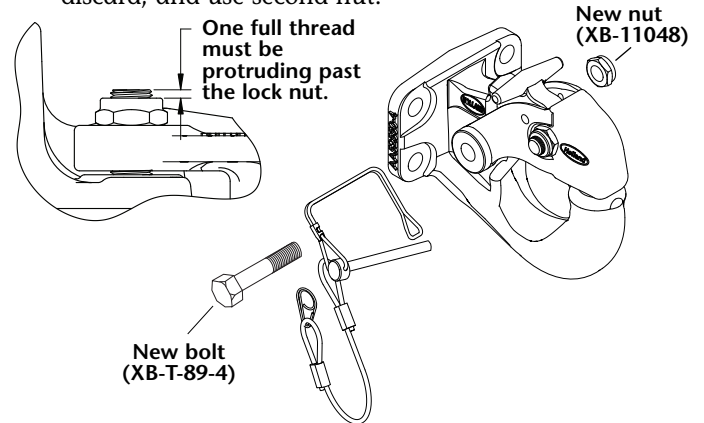

**⚠ WARNING** DO NOT reinstall a removed lock nut. Always install a new lock nut when removing or replacing latch assembly. A reinstalled nut may not retain properly and could result in an unintended trailer separation.

4. Check the latch for proper operation. When closed, the lock must be fully down. Install the D-Pin into the hole in the side of the latch as shown. Lock the D-Pin to secure it in the latch.

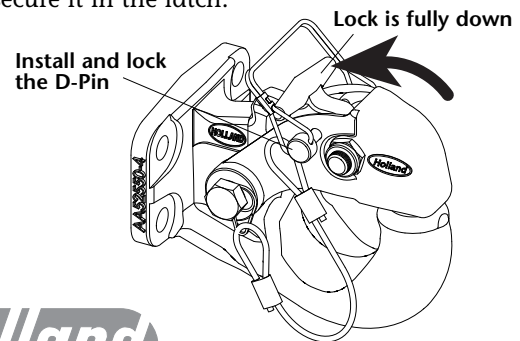

SAF-HOLLAND USA, Inc.  
888.396.6501 Fax 800.356.3929

SAF-HOLLAND Canada Limited  
519.537.3494 Fax 800.565.7753  
Western Canada  
604.574.7491 Fax 604.574.0244

SAF-HOLLAND International, Inc.  
616.396.6501 Fax 616.356.1511

Copyright © July 2007-SAF-HOLLAND, Inc. All information contained in this document was correct at time of copyright, and is subject to change without notice. All rights reserved.