

Installation Manual

TL4048/4052/4061 and TL5061 Series Liftgates



Mounting Brackets for Frameless Trailers

Introduction

This manual provides you with the information necessary to properly install the trailer mounting brackets with the SAF-HOLLAND TL Series Liftgate on frameless trailers.

NOTE: For liftgate components replacement, contact SAF-HOLLAND Customer Service at:
U.S. 888-396-6501
Canada 800-503-9847

Warranty

Refer to the complete warranty for the country in which the product will be used. A copy of the warranty certificate is included with the product as well as on the SAF-HOLLAND website (www.safholland.us and www.safholland.ca). It may also be ordered directly from SAF-HOLLAND; the address is shown on the back cover.

Notes, Cautions, and Warnings

You must read and understand all of the safety procedures presented in this manual before operating or starting any work on the liftgate.

NOTE: In the United States, workshop safety requirements are defined by federal and/or state Occupational Safety and Health Act. Equivalent laws may exist in other countries. This manual is written based on the assumption that OSHA or other applicable employee safety regulations are followed by the location where work is performed.

Proper tools must be used to perform the procedures described in this manual. Many of these procedures may require special tools.

IMPORTANT: Read this manual before using this product. Keep this manual in a safe location for future reference.

⚠ WARNING Failure to follow the instructions and safety precautions in this manual could result in death or serious injury.

Throughout this manual, you will notice the terms "NOTE," "IMPORTANT," "CAUTION," and "WARNING" followed by useful product information. So that you may better understand the manual, those terms are as follows:

NOTE: Includes additional information to enable accurate and easy performance of procedures.

IMPORTANT: Includes additional information that if not followed could lead to hindered product performance.

CAUTION Used without the safety alert symbol, indicates a potentially hazardous situation which, if not avoided, could result in property damage.

⚠ CAUTION Indicates a potentially hazardous situation which, if not avoided, could result in minor or moderate injury.

⚠ WARNING Indicates a potentially hazardous situation which, if not avoided, could result in death or serious injury.

1. Safety Instructions

General Safety Instructions

1. To reduce the risk and ensure safety at all times, this section of the manual details a number of safety rules which should always be followed.
2. Read and observe all Warning and Caution hazard alert messages in this manual and on the equipment
3. Always use the proper tool for the job. Repair or replace worn or damaged tools before starting any installation.

NOTE: Proper tools must be used to perform the installation procedures in this manual. Many of these procedures require special tools.

Installation Safety Precautions

1. Never strike any part of the brackets with a steel hammer.
2. Safety protection should always be worn as protection from flying debris, and other airborne matter when working with tools, power tools, and welding equipment.

⚠ WARNING Failure to turn off vehicle motor before commencing work could allow vehicle to move which, if not avoided, could result in death or serious injury.

3. When welding is required, ensure that the battery ground cable is disconnected and that all electrical equipment is completely isolated before welding is initiated (**Figure 1**).
4. Before starting any welding, ensure that the area worked on is cleaned of debris and combustible material. Have a charged fire extinguisher readily available and know how to use it.

2. Kit Contents (*Figure 2*)

ITEM	DESCRIPTION	QUANTITY
1	Trailer Mount, Curbside	1
2	Trailer Mount, Roadside	1

IMPORTANT: When welding use a procedure and filler metal with sound, good quality weld while protecting the welding operator and others. An AWS E70XX filler metal, used in conjunction with either GMW (gas shield solid wire, FCAW (gas shield flux core wire), or SMAW (AC or DC stick) is recommended.

⚠ WARNING Over welding may cause distortion or damage and under welding may not develop sufficient strength. Failure to follow proper weld procedures could cause failure or fracture which, if not avoided, could result in death or serious injury.

Figure 1

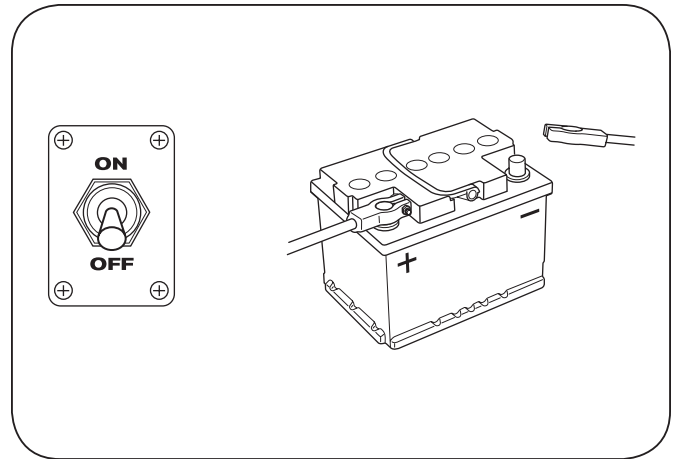
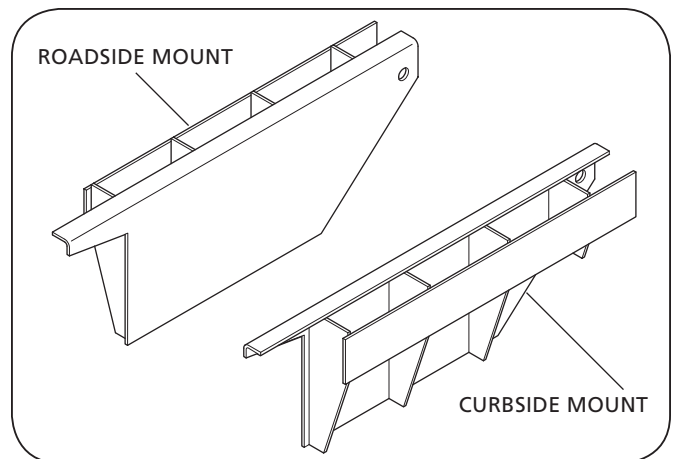

Figure 2



3. Installation

1. Refer to the Installation Manual XL-TG10153BM-en-US for frame preparation instructions and deck extension installation (if applicable).
2. Position the curbside mounting bracket against the trailer slider rail and cross members (**Figures 3 and 4**).

NOTE: If the outside face of the mounting bracket is not flush against the slide rail and the top face of the mounting bracket is not flush with the bottom of the I-beams, a 1/4" shim may be required. (**Figure 5**).

IMPORTANT: Trailer mounts should span across at least three (3) cross members.

3. When properly positioned against the slide rail and flush with the bottom I-beams, prepare the trailer slider rail, crossmember and mounting bracket by grinding off any paint or galvanizing to within 1" to 4" (25 to 101 mm) of the weld zone.
4. Repeat Steps 2 and 3 for the roadside mounting bracket.

Figure 3

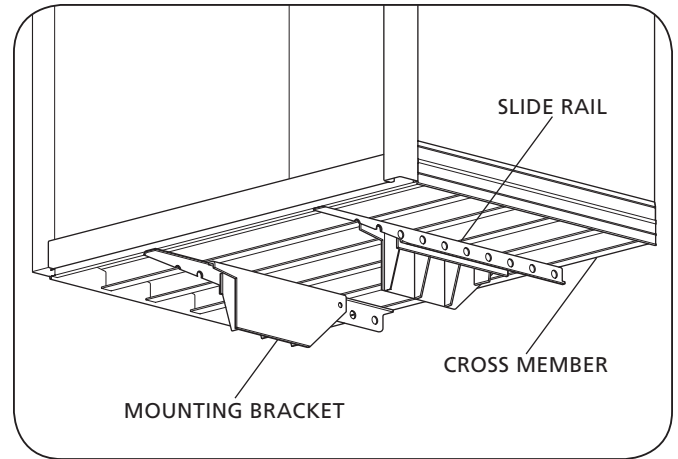

Figure 4

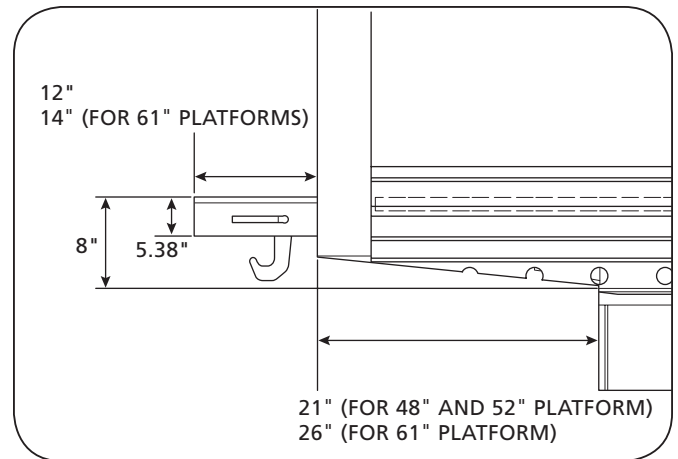
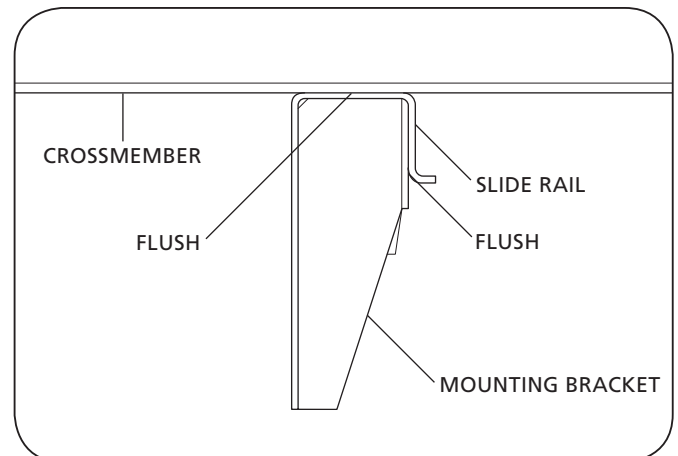

Figure 5



Installation



SAF-HOLLAND Group

5. Weld the curbside mounting bracket as illustrated (Figures 6, 7 and 8.)

NOTE: When welding is required, ensure that the battery ground cable is disconnected and that all electrical equipment is completely isolated before welding is initiated.

CAUTION Failure to isolate electrical equipment from ground prior to welding could result in overload which, if not avoided, could result in property damage.

6. Repeat Steps 2 through 4 for the roadside mounting bracket.
7. Refer to the Installation Manual XL-TG10153BM-en-US for the remainder of the Liftgate Installation.

Figure 6

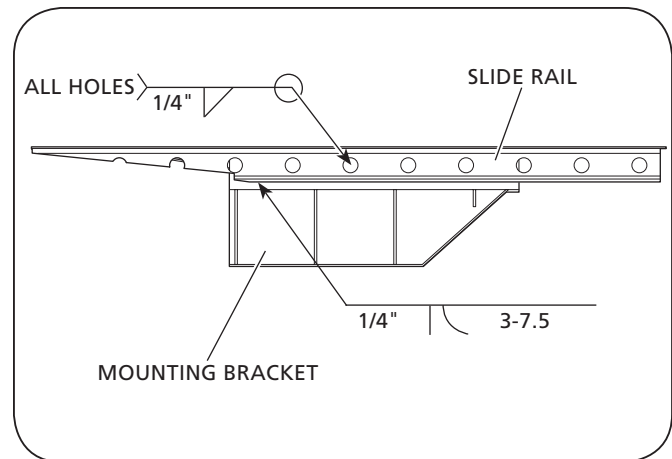

Figure 7

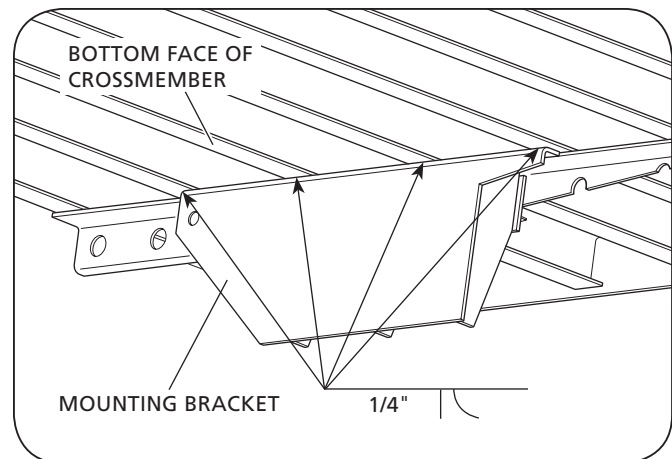

Figure 8

